

FOR LEASE

OFFICE BUILDING



118 S. GREENVILLE WEST DR.
GREENVILLE, MI 48838

PROPERTY HIGHLIGHTS

- Accessibility and visibility via busy retail corridor of W. Washington Street (aka W. Carson City Road)
- Parking lot resealed and re-striped in 2018, along with all new LED parking lot fixtures installed in 2019
- Four free-standing buildings with ample surface parking
- Ideal for medical and general office users seeking easy access to Greenville's retail hub
- Join tenants Keil Lasik, Hurley Dental, Martin Eye Care, and Edward Jones
- Located behind a busy shopping center and next to a new retail development, both boasting national retail rosters
- New Meijer Supercenter recently built across W. Washington; dozens of shops and eateries within walking distance
- White box space; completely customizable to your business needs!

OFFERING SUMMARY

Year Built: 2005
Building Size: 24,000 SF
Zoning: Commercial

AVAILABLE SPACES

SPACE	LEASE RATE	SIZE (SF)
118	\$11.00 SF/yr	3,600 SF

DEMOGRAPHICS

	1 MILE	5 MILES	10 MILES
Total Households	546	7,282	18,462
Total Population	1,402	18,977	48,985
Average HH Income	\$47,791	\$50,300	\$52,791



DAN BURNS
Associate Broker
616.204.2876
dburns@bradleyco.com

SHELBY RENO
Realtor | KW Commercial
616.540.8216
ShelbyReno@kw.com

118 S. GREENVILLE WEST DR. | FOR LEASE

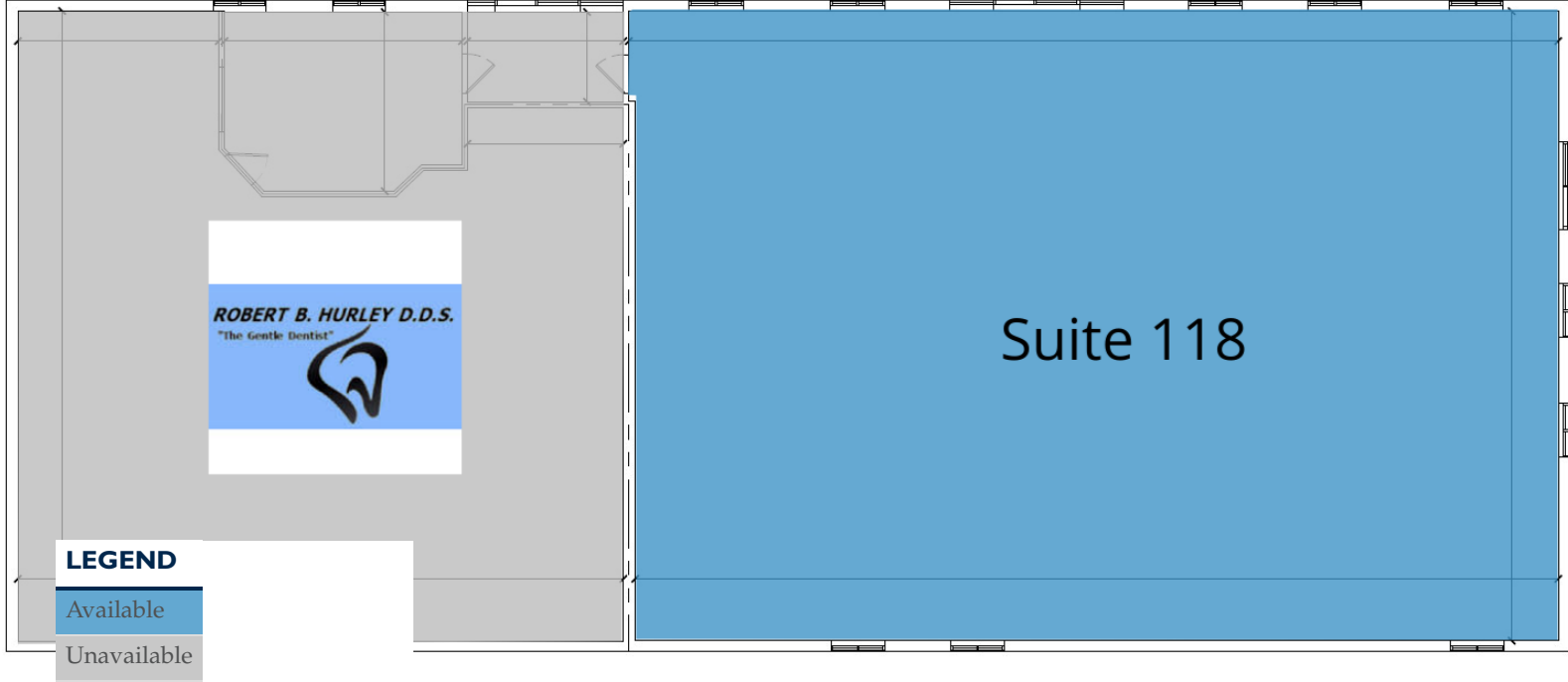

AVAILABLE SPACES

SUITE	TENANT	SIZE	TYPE	RATE
118	Available	3,600 SF	Modified Gross	\$11.00 SF/yr

MEET YOUR NEIGHBORS

118 S. GREENVILLE WEST DR. | FOR LEASE



Map data ©2020 Imagery ©2020, CNES / Airbus, Kent County, Maxar Technologies, USDA Farm Service Agency



DAN BURNS
Associate Broker
616.204.2876
dburns@bradleyco.com

SHELBY RENO
Realtor | KW Commercial
616.540.8216
ShelbyReno@kw.com

©2020 Bradley Company, LLC and affiliates. Use of any third party name or mark is for informational purposes only and does not indicate sponsorship or endorsement by such party. Not all information has been independently verified, and the presenting broker makes no guarantee about its accuracy. Any projections, opinions, or estimates are for example only. Before completing a real estate transaction, you and your advisors should conduct an independent investigation of the property to determine its suitability for your needs.