

# 1162 NORTH LASALLE

SOUTHWEST CORNER OF  
DIVISION ST & LASALLE ST  
CHICAGO, IL

PROMINENT STREET FRONT  
SPACE AVAILABLE

PROMINENT STREET FRONT SPACE AVAILABLE

# 1162 N. LASALLE

Southwest Corner of Division & LaSalle | Chicago, IL



### SPACE AVAILABLE

Approximately 900 SF

### SITE SUMMARY

- Located in Old Town at the southwest corner of Division Street and LaSalle Street
- Location benefits from exceptionally high incomes (\$97,639 in a 0.5 mile radius) and extremely high population density (37,392 people in a 0.5 mile radius)
- Located across the street from Clark and Division CTA "L" station

### CO-TENANCY

Retailers in the immediate vicinity of this property include Jewel Osco, Fitness Formula clubs, and Plum Market. Other area retailers include CVS Pharmacy, Walgreens, Chipotle, Starbucks, and Jimmy John's.

<b>POPULATION DENSITY</b>	33,823	½ Mile
	84,563	1 Mile
	208,462	2 Mile
<b>DAYTIME EMPLOYMENT</b>	10,750	½ Mile
	24,506	1 Mile
	60,413	2 Mile
<b>AVERAGE HH INCOME</b>	\$92,979	½ Mile
	\$101,364	1 Mile
	\$112,527	2 Mile

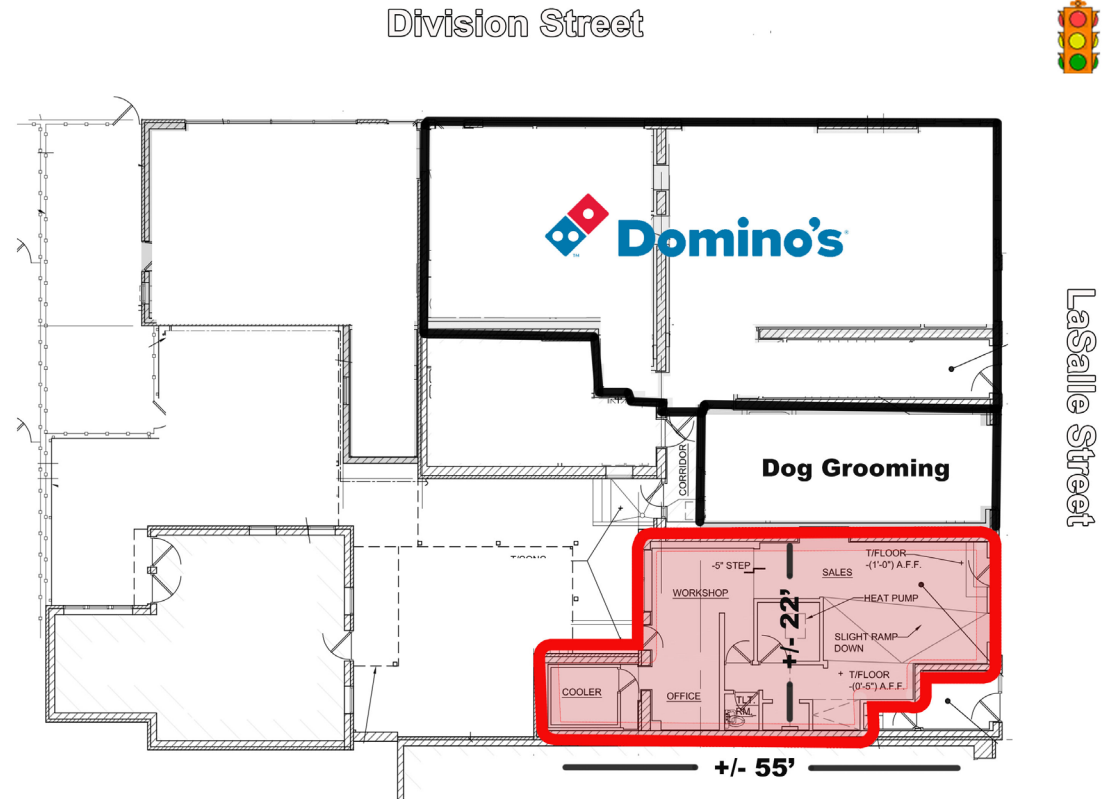

PROMINENT STREET FRONT SPACE AVAILABLE

# 1162 N. LASALLE

Southwest Corner of Division & LaSalle | Chicago, IL



### CONTACT

Matt Cavanagh  
 matt@arcgrp.com  
 (630) 908-5694

© 2019 A•R•C Real Estate. All information is from sources believed reliable, not independently verified, and thus subject to errors, omissions, and modifications such as price, listing, square footage, rates and commissions. All information, estimates and projections subject to change, market assumptions, unknown facts and conditions, and future potentialities. A•R•C Real Estate makes no express or implied representations or warranties, as facts and results may vary materially from all information, estimates and projections. All renderings presented are conceptual.

