

DAVID TAYLOR CORPORATE CENTER

10101 David Taylor Drive | Charlotte, NC 28262

Three - Story
Class A Office
Building
in the
University
Submarket



Property Highlights

- Ample parking (ratio: **6.5 / 1,000 SF**)
- Class A office building available in University Research Park
- New double glass door entries and new elevator cabs
- 19,192 SF available
- **Land for additional building 70,000 SF**



New Glass Entries

A photograph showing a modern glass entryway with a double glass door. The interior is visible through the glass, showing a clean, bright space with a light-colored wall and a glass partition. The floor is a light-colored tile.

New Outdoor Patio

A photograph of an outdoor patio area. The patio is paved with light-colored tiles and features several tables and chairs. There are large green umbrellas providing shade. The patio is surrounded by landscaping, including bushes and trees. The building's glass facade is visible in the background.

New Elevator Cabs

A photograph of a modern elevator cab. The cab has a glass door and a light-colored interior. The floor is a dark, patterned tile. The ceiling has recessed lighting.

CONTACT:
David Dorsch, CCIM, SIOR
+1 704 335 4441
david.dorsch@cushwake.com

Jessica Brown
+1 704 887 3023
jessica.brown@cushwake.com



DAVID TAYLOR
CORPORATE CENTER

Availabilities

Second Floor

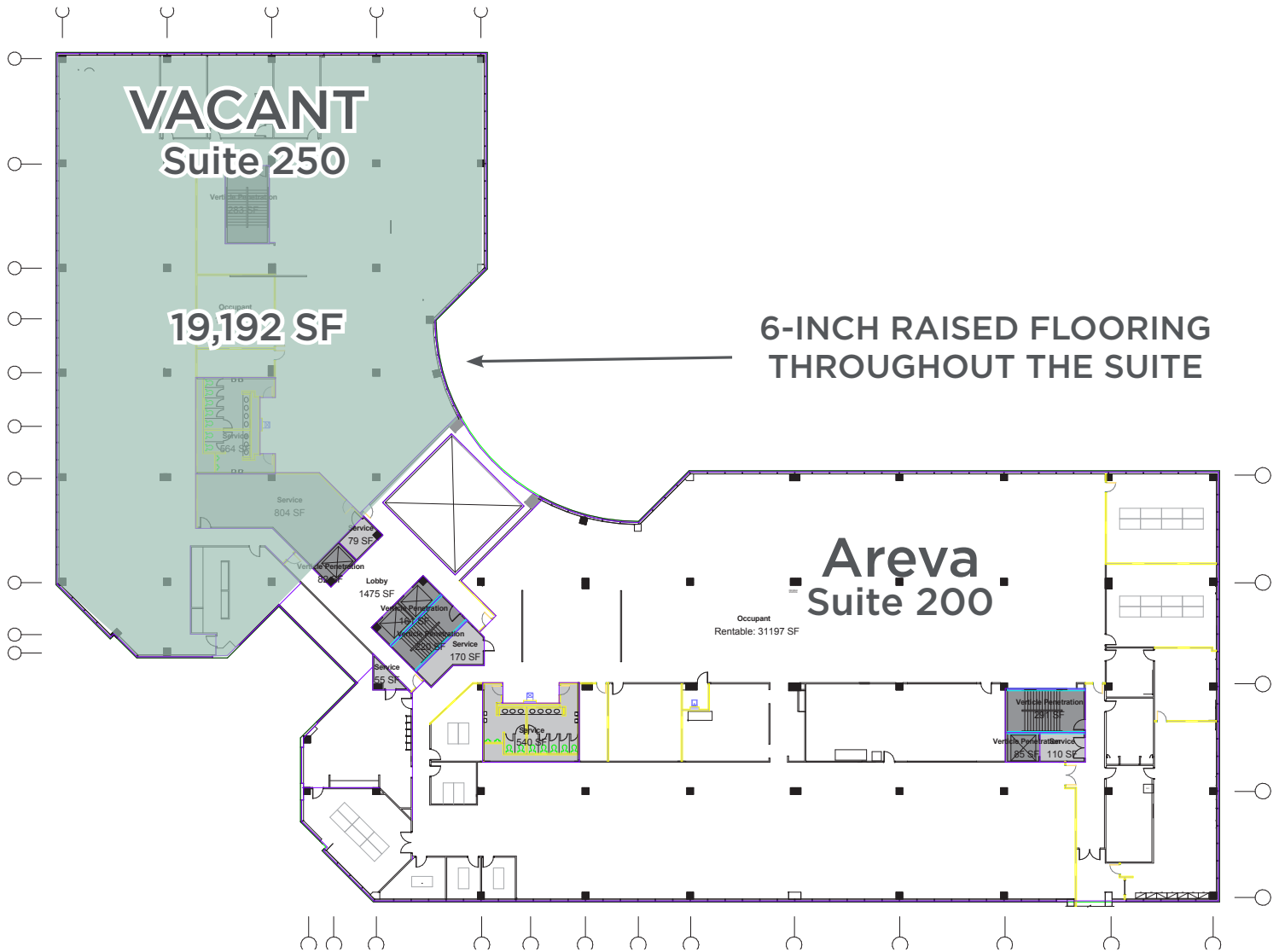

CONTACT:
David Dorsch, CCIM, SIOR
+1 704 335 4441
david.dorsch@cushwake.com

Jessica Brown
+1 704 887 3023
jessica.brown@cushwake.com



Dozens of Retail Amenities *(within 3/4 mile)*

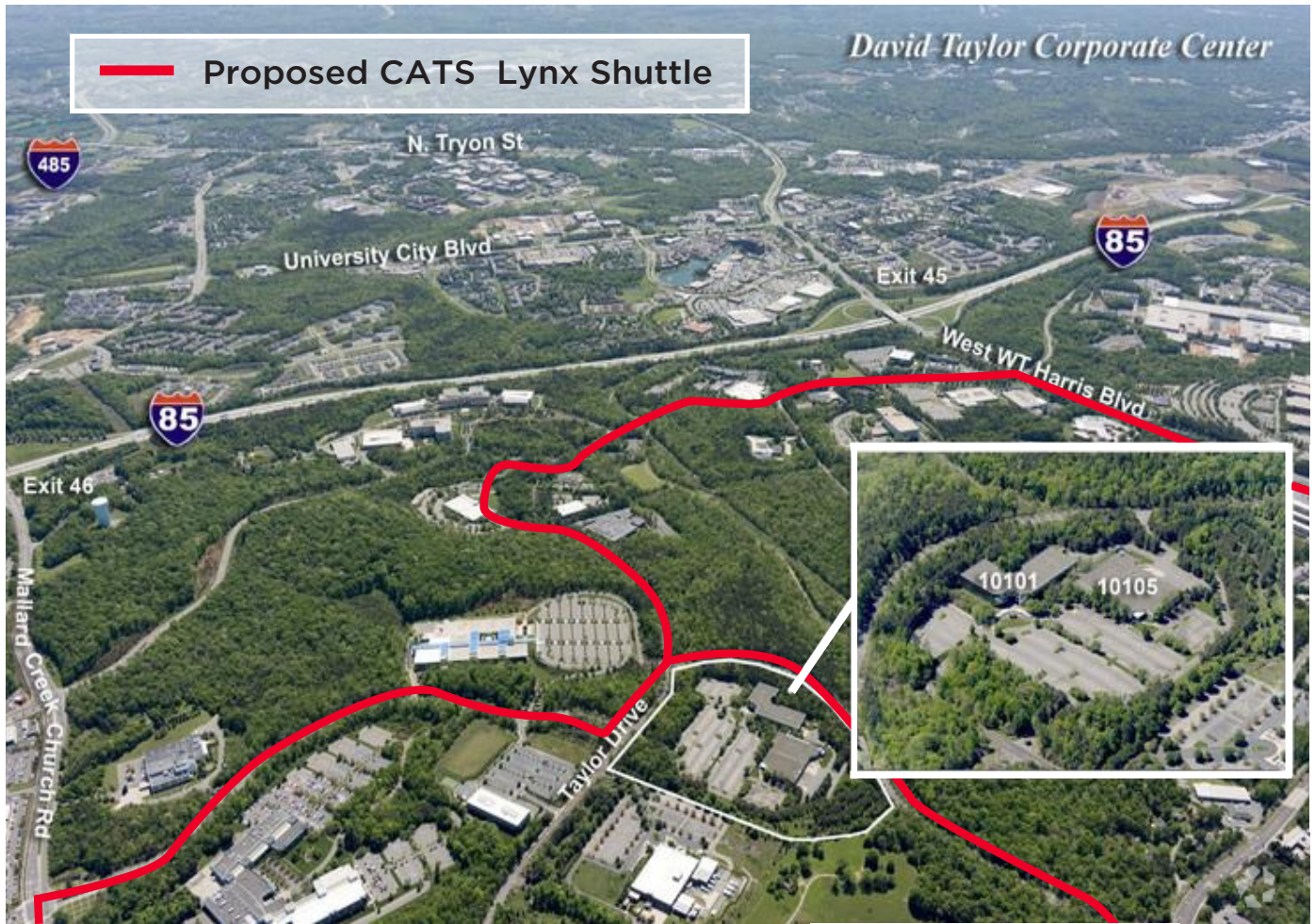

CONTACT:
 David Dorsch, CCIM, SIOR
 +1 704 335 4441
 david.dorsch@cushwake.com

Jessica Brown
 +1 704 887 3023
 jessica.brown@cushwake.com

