

# FOR SALE

501 N Winter Street, Midway, KY 40347

\$595,000



## Property Details

Price: \$595,000

Total Lot Size: 2.25 AC

Property Type: Land

Property Sub-Type: Retail (land)

**Lot 2A:** +/- 1.107AC, zone B-5 - Highway Interchange Service Business.

**Lot 2B:** +/- 1.148AC, zone R-1B - Single Family Residential. Off Interstate 64 and Leestown Road.



Empty lots, ready to be redeveloped for any number of commercial uses.

The property is located on the north side of Leestown Road (US 421) in the northern section of Woodford county in Midway, KY. The subject is at the US 62 and Leestown Road (US 421) intersection and corner of KY 341 which provides access to I-64 Exit 66. The primary road which provide access is Leestown Road (US 421). Overall, this site is well located on a Interstate Interchange.

## Utilities

- Electricity/Power
- Water
- Telephone

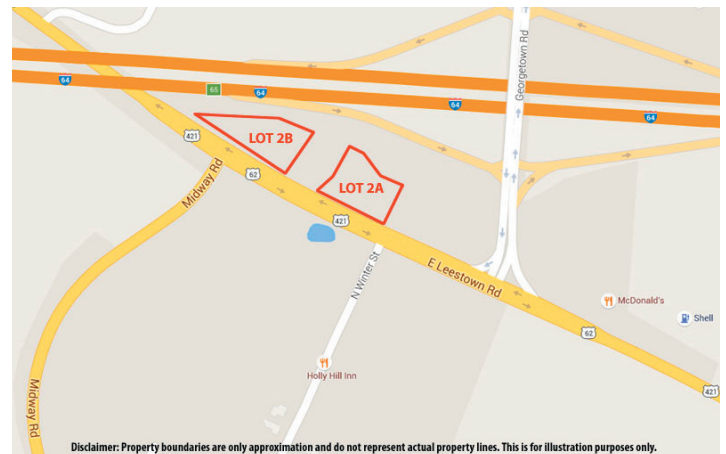

**JAMES M. SCHRADER**

**859-288-5008**

[jschrader@schradercommercial.com](mailto:jschrader@schradercommercial.com)

444 E Main Street, Suite 110  
PO Box 21793 Lexington, KY 40522

**SCHRADER**  
COMMERCIAL PROPERTIES, LLC

**859-288-5008 / [schradercommercial.com](http://schradercommercial.com)**

The information contained herein is from sources believed, but not guaranteed to be reliable. Schrader Commercial Properties, LLC makes no representations or warranties regarding the property and you should conduct a careful independent investigation of the property to determine its suitability for your use and investment.