

# Ruthven Industrial Center

## 3210 WINTER LAKE ROAD- LAKELAND, FL



**NEED WAREHOUSE  
SPACE? Call  
THE RUTHVENS  
(863) 686-3173**

**For More Information  
Contact:**

Greg Ruthven, CCIM  
(863) 581-4639 cell  
greg@ruthvens.com

Matt Ruthven, CCIM  
(863) 581-4637 cell  
mruthven@ruthvens.com

### ***DISTRIBUTION / MANUFACTURING WAREHOUSE***

Ruthven Industrial Center located at 3210 Winter Lake Road provides 31,250 square feet of dock high warehouse. It may be leased in multiples of 3,125 square feet with a minimum of 6,250 square feet. Conveniently located close to Highway 98 and Polk Parkway. The building has all necessary amenities including city water and electric.

#### ***Specifications***

- 31,250 sq. ft. dock high
- 6,250 sq. ft. minimum
- 10'x10' overhead doors
- 24' eave height
- Metal with concrete block
- ESFR overhead sprinkler system
- Ample truck parking

41 Lake Morton Drive . P.O. Box 2420 Lakeland, FL  
33806-2420

**www.Ruthvens.com**

**THE  
Ruthvens**

*Leasing Warehouse Space for  
Distribution & Manufacturing*

# Ruthven Industrial Center

## 3210 WINTER LAKE ROAD- LAKELAND, FL

*We build more than warehouses... we build relationships!*

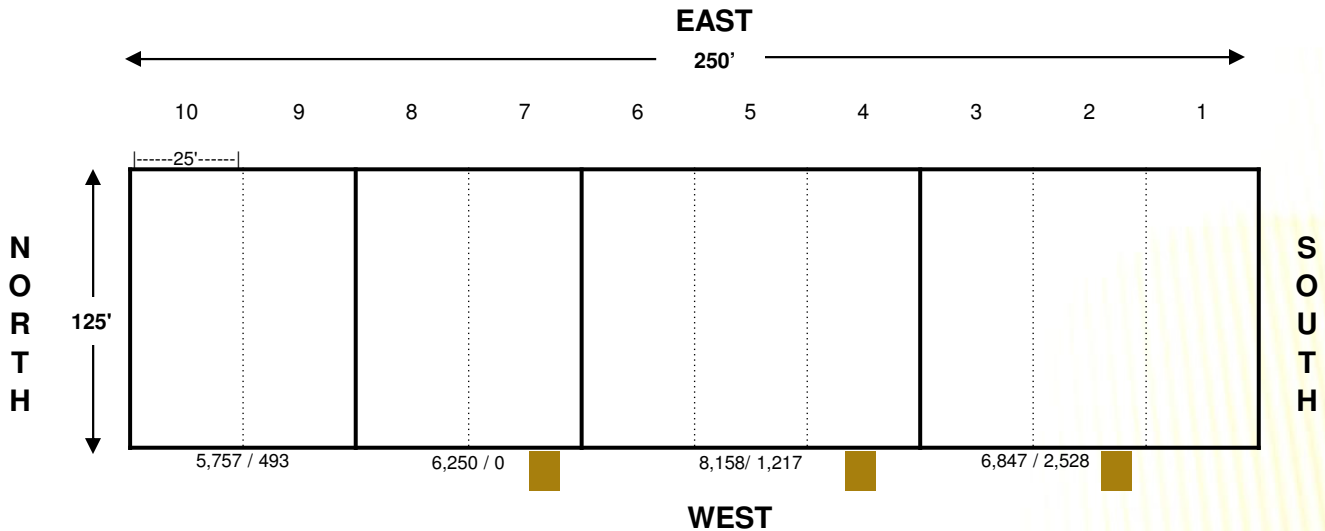

### ***DISTRIBUTION / MANUFACTURING WAREHOUSE***

- Over 9½ million people live within a 100-mile radius of Lakeland
- Fast access to Highways 92, 98, Polk Parkway (570) and Interstate 4
- Only 7 miles to Bartow, 11.5 miles to Auburndale and 8 miles to Winter Haven

***Call Today!***  
***863-686-3173***

**[www.Ruthvens.com](http://www.Ruthvens.com)**

**THE**  
**Ruthvens**

*Leasing Warehouse Space for  
Distribution & Manufacturing*



***Tampa is 38 miles West and  
Orlando is 53 miles East***

Greg Ruthven, CCIM: [greg@ruthvens.com](mailto:greg@ruthvens.com) - Matt Ruthven, CCIM: [mruthven@ruthvens.com](mailto:mruthven@ruthvens.com)  
Mobile: (863) 581-4639 Mobile: (863) 581-4637