

INDUSTRIAL  
FOR LEASE

# 259 30TH STREET

:: GREELEY, CO 80631



## LOCATION



FOR MORE  
INFORMATION  
PLEASE  
CONTACT

<b>AVAILABLE:</b>	±130,494 SF
<b>YARD:</b>	±12.20 AC
<b>OFFICE:</b>	±5,000 SF
<b>CLEARANCE:</b>	30' clear minimum
<b>LOADING:</b>	(2) docks, (1) 16' x 16' grade level drive-in doors
<b>ELECTRICAL:</b>	To be verified by an electrician
<b>COLUMN SPACING:</b>	60' x 60' (varies)
<b>SPRINKLER:</b>	Wet system (dry system above rail/receiving docks)
<b>YEAR BUILT:</b>	1984
<b>ZONING:</b>	IM - Industrial Medium Density
<b>RAIL:</b>	6 rail doors, serviced by Union Pacific
<b>LEASE RATE:</b>	\$4.50/SF Gross

## FEATURES

- Former RR Donnelley Plant
- Located in the Greeley / Weld Enterprise Zone
- Large Manufacturing / Distribution Opportunity

**Peter Kast**  
Senior Vice President  
970.372.3845  
peter.kast@cbre.com

**Tyler Carner**  
First Vice President  
720.528.6397  
tyler.carner@cbre.com

**Jim Bolt**  
Executive Vice President  
720.528.6310  
james.bolt@cbre.com

CBRE, Inc. | 8390 E. Crescent Parkway | Suite 300 | Greenwood Village, CO 80111 | [www.cbre.com/denver](http://www.cbre.com/denver)

© 2014 CBRE, Inc. This information has been obtained from sources believed reliable. We have not verified it and make no guarantee, warranty or representation about it. Any projections, opinions, assumptions or estimates used are for example only and do not represent the current or future performance of the property. You and your advisors should conduct a careful, independent investigation of the property to determine to your satisfaction the suitability of the property for your needs. Photos herein are the property of their respective owners and use of these images without the express written content of the owner is prohibited.

**CBRE**

**INDUSTRIAL  
FOR LEASE**

# 259 30TH STREET

:: GREELEY, CO 80631

## ADDITIONAL FEATURES

Great access at the US 85 and Colorado State Highway 34 intersection

Excellent access to employee base

Aggressive business community

Former telephone book printing facility

## SITE PLAN

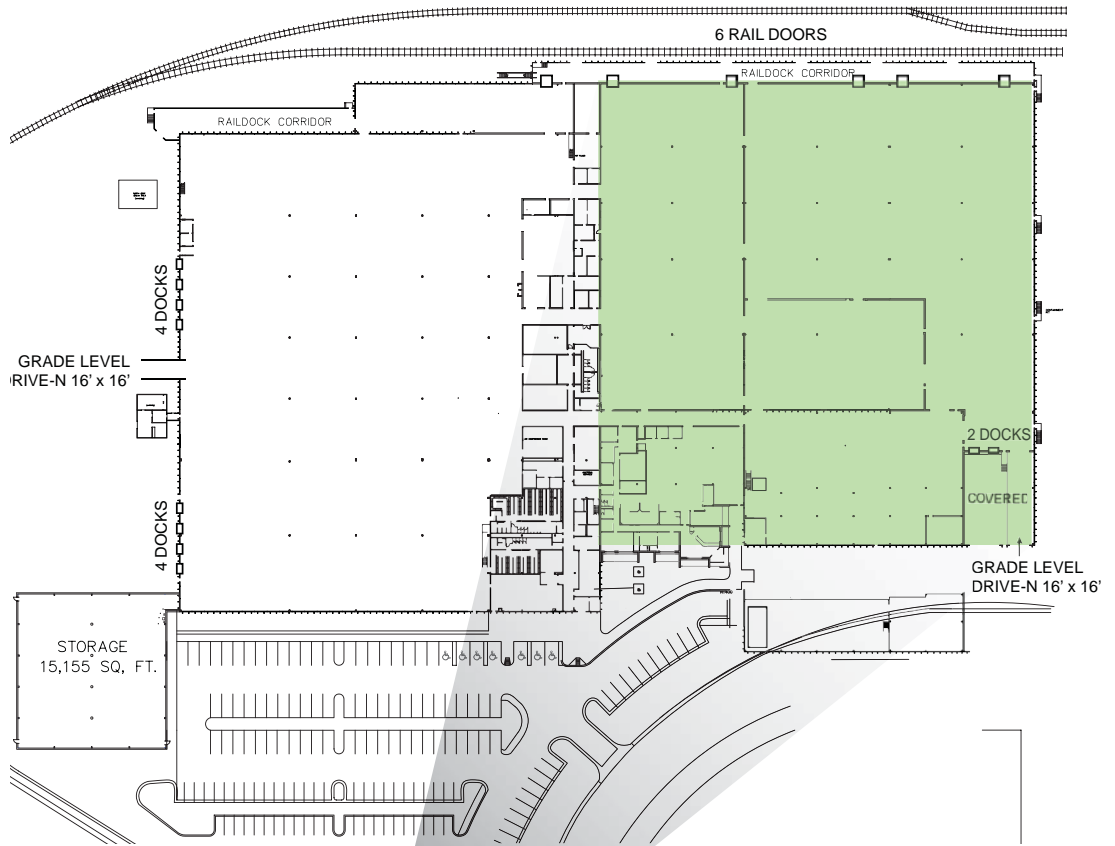

**FOR MORE  
INFORMATION  
PLEASE  
CONTACT**

### Peter Kast

Senior Vice President

970.372.3845

peter.kast@cbre.com

### Tyler Carner

First Vice President

720.528.6397

tyler.carner@cbre.com

### Jim Bolt

Executive Vice President

720.528.6310

james.bolt@cbre.com

## AERIAL

