

773 BROOKSEGE BLVD.  
WESTERVILLE, OHIO 43081

OFFICE FOR LEASE  
(FORMER SWITCH (DATA) CENTER)

± 24,683 SF Available



## BROOKSEGE CORPORATE CENTER

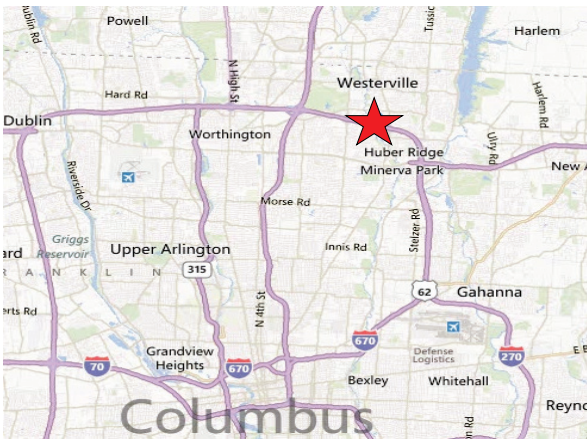

## PROPERTY FEATURES

- Former Switch ( Data ) and Call Center
- Clear Height 12' Finished Ceiling and 18'in Warehouse
- Heavy Power ( 3,000 AMPs or more)
- 2 Back-up generators
- Wet & Chemical Fire Suppressions elaborate Liebert and HVAC systems'
- Truck Dock and Drive-in Doors Available
- Up to 8 parking spaces / 1,000 SF
- Tenant Contracts Directly for Utilities and Janitorial Services
- All Phone / Fiber Providers
- Building or Monument Signage
- Excellent Access to I-270 at Route 3

### BUILDING FEATURES

AVAILABLE	24,683 SF (min. 9,896 SF)
ASKING RATE	\$9.50 / SF NNN
2015 OPERATING EXPENSES	\$4.01 / SF

For more information, please contact:

**BRENT STAMM, CCIM**  
Senior Vice President

(614) 883 1141

[bstamm@continental-realty.com](mailto:bstamm@continental-realty.com)

**TOM SUGAR**

Executive Vice President

(614) 883 1066

[tsugar@continental-realty.com](mailto:tsugar@continental-realty.com)

**CONTINENTAL REALTY /  
CUSHMAN & WAKEFIELD ALLIANCE**

150 E. Broad Street, Suite 500

Columbus, OH 43215

[www.continental-realty.com](http://www.continental-realty.com)

The depiction in the included photograph of any person, entity, sign, logo or property, other than Continental Realty's (CR) client and the property offered by CR, is incidental only, and is not intended to connote any affiliation, connection, association, sponsorship or approval by or between that which is incidentally depicted and CR or its client. This listing shall not be deemed an offer to lease, sublease or sell such property; and, in the event of any transaction for such property, no commission shall be earned by or payable to any cooperating broker except if otherwise provided pursuant to the express terms, rates and conditions of CR's agreement with its principal, if, as and when such commission (if any) is actually received from such principal. (A copy of the rates and conditions referred to above with respect to this property is available upon request.)

FLOOR PLAN

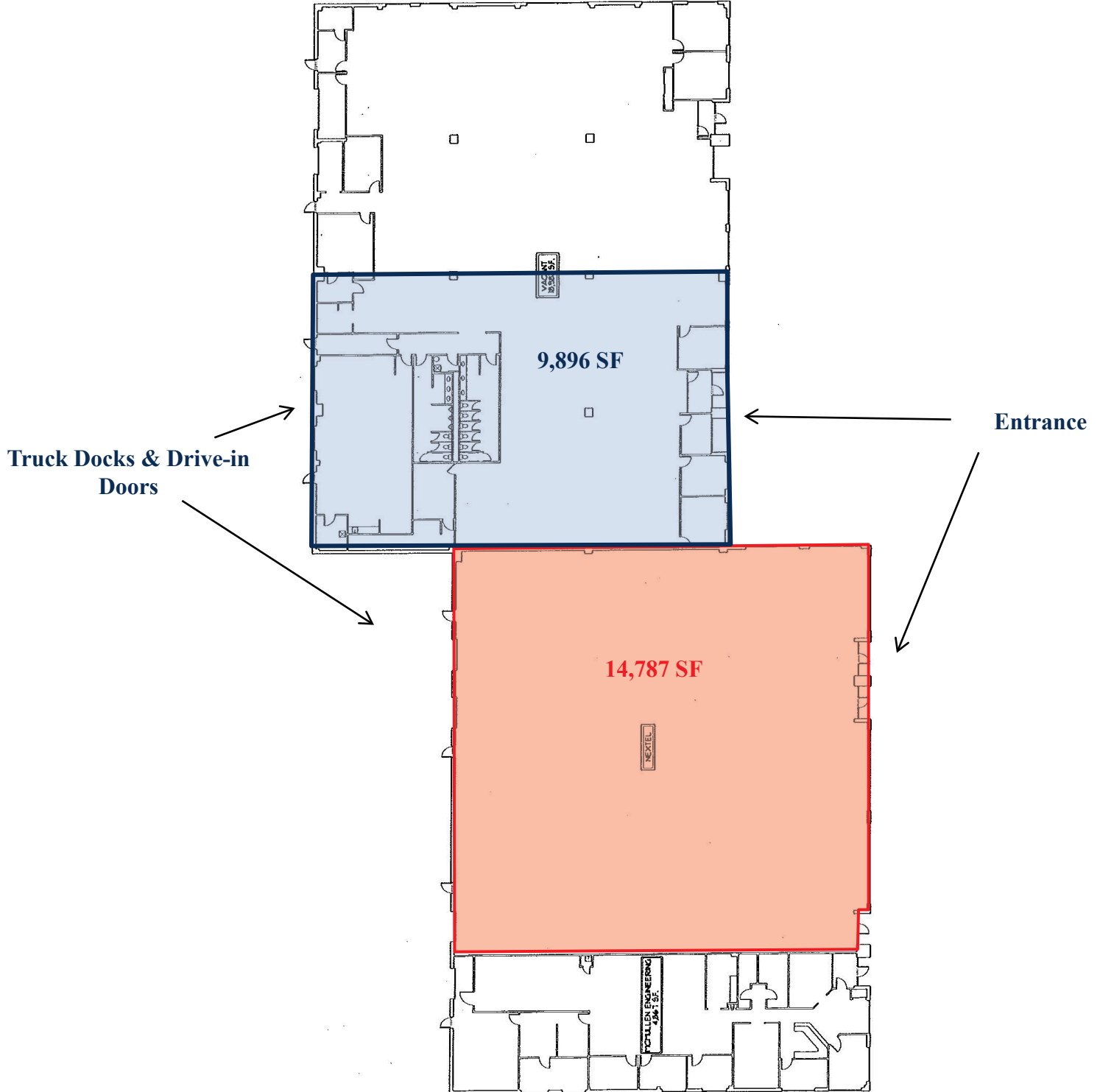

For more information, please contact:

**BRENT STAMM, CCIM**  
Senior Vice President  
(614) 883 1141  
bstamm@continental-realty.com

**TOM SUGAR**  
Executive Vice President  
(614) 883 1066  
tsugar@continental-realty.com

**CONTINENTAL REALTY /  
CUSHMAN & WAKEFIELD ALLIANCE**  
150 E. Broad Street, Suite 500  
Columbus, OH 43215  
www.continental-realty.com

The depiction in the included photograph of any person, entity, sign, logo or property, other than Continental Realty's(CR) client and the property offered by CR, is incidental only, and is not intended to connote any affiliation, connection, association, sponsorship or approval by or between that which is incidentally depicted and CR or its client. This listing shall not be deemed an offer to lease, sublease or sell such property; and, in the event of any transaction for such property, no commission shall be earned by or payable to any cooperating broker except if otherwise provided pursuant to the express terms, rates and conditions of CR's agreement with its principal, if, as and when such commission (if any) is actually received from such principal. (A copy of the rates and conditions referred to above with respect to this property is available upon request.)

# 773 BROOKSEGE BLVD.

## Office for Lease

24,683 SF  
AVAILABLE

### AERIAL



For more information, please contact:

**BRENT STAMM, CCIM**

Senior Vice President

(614) 883 1141

[bstamm@continental-realty.com](mailto:bstamm@continental-realty.com)

**TOM SUGAR**

Executive Vice President

(614) 883 1066

[tsugar@continental-realty.com](mailto:tsugar@continental-realty.com)

**CONTINENTAL REALTY /  
CUSHMAN & WAKEFIELD ALLIANCE**

150 E. Broad Street, Suite 500

Columbus, OH 43215

[www.continental-realty.com](http://www.continental-realty.com)

The depiction in the included photograph of any person, entity, sign, logo or property, other than Continental Realty's (CR) client and the property offered by CR, is incidental only, and is not intended to connote any affiliation, connection, association, sponsorship or approval by or between that which is incidentally depicted and CR or its client. This listing shall not be deemed an offer to lease, sublease or sell such property; and, in the event of any transaction for such property, no commission shall be earned by or payable to any cooperating broker except if otherwise provided pursuant to the express terms, rates and conditions of CR's agreement with its principal, if, as and when such commission (if any) is actually received from such principal. (A copy of the rates and conditions referred to above with respect to this property is available upon request.)