

FURNISHED EXECUTIVE OFFICE SPACE

22308 Midland Drive, Shawnee, KS 66226



Space Details:

- 1,791 SF end cap space available March 1, 2022
- Fully furnished executive office opens to a main reception area that includes a front desk, waiting area, and conference room (contact agent for details of furnishings)
- Private offices along the perimeter of the space
- Kitchen with a rear exit at back of space
- Kitchen has windows with a pleasant wooded view
- High quality carpet only two years old

Building Details:

- Subway and Mortgage Investment Services are the only other tenants in this exclusive office/retail building
- This 11,416 SF building was built in 2006 and is located within the Shawnee Crossings commercial development on the south side of Shawnee Mission Parkway
- Surrounding area includes a complimentary mix of restaurants, retail, and office development
- Hilltop Road provides access to commercial uses within Shawnee Crossings, with Monticello Village Shopping Center located on the north side of Shawnee Mission Parkway
- Subject building is located approximately one-half mile east of the intersection of K-7 Highway and Shawnee Mission Parkway with visibility from Shawnee Mission Parkway

RENT: \$18/SF NNN (current nets = \$10.99/SF)

John Handley

jhandley@fishmancommercial.com

913.747.3314 O 913.909.1304 C



FURNISHED EXECUTIVE OFFICE SPACE

22308 Midland Drive, Shawnee, KS 66226



John Handley
jhandley@fishmancommercial.com
913.747.3314 O 913.909.1304 C



FURNISHED EXECUTIVE OFFICE SPACE

22308 Midland Drive, Shawnee, KS66226



Back of building

John Handley
jhandley@fishmancommercial.com
913.747.3314 O 913.909.1304 C



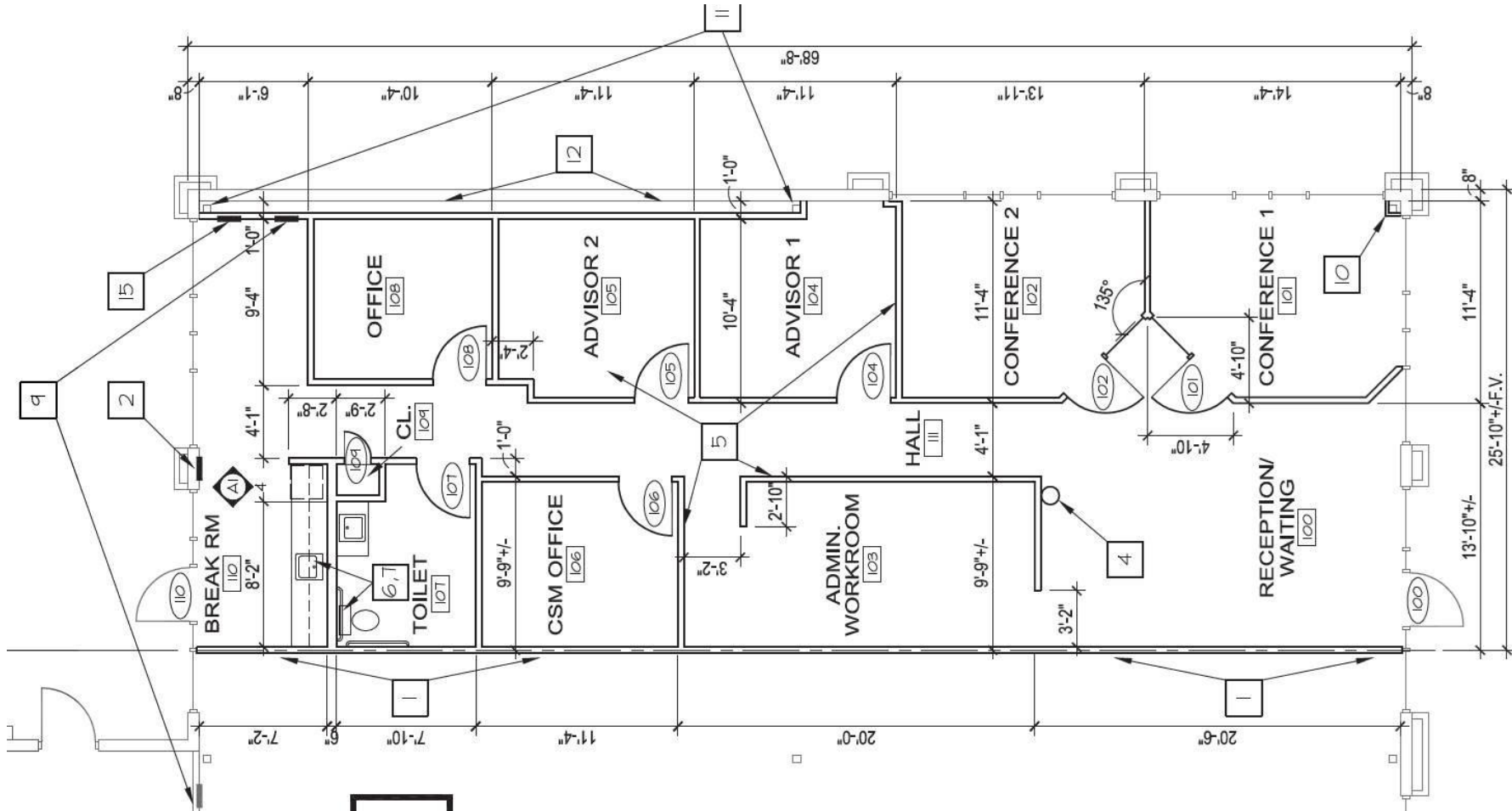

1 FLOOR PLAN
1/8" = 1'-0"

John Handley
jhandley@fishmancommercial.com
 913.747.3314 O 913.909.1304 C



FURNISHED EXECUTIVE OFFICE SPACE

22308 Midland Drive, Shawnee, KS 66226



John Handley

jhandley@fishmancommercial.com

913.747.3314 O 913.909.1304 C



2021 DEMOGRAPHICS

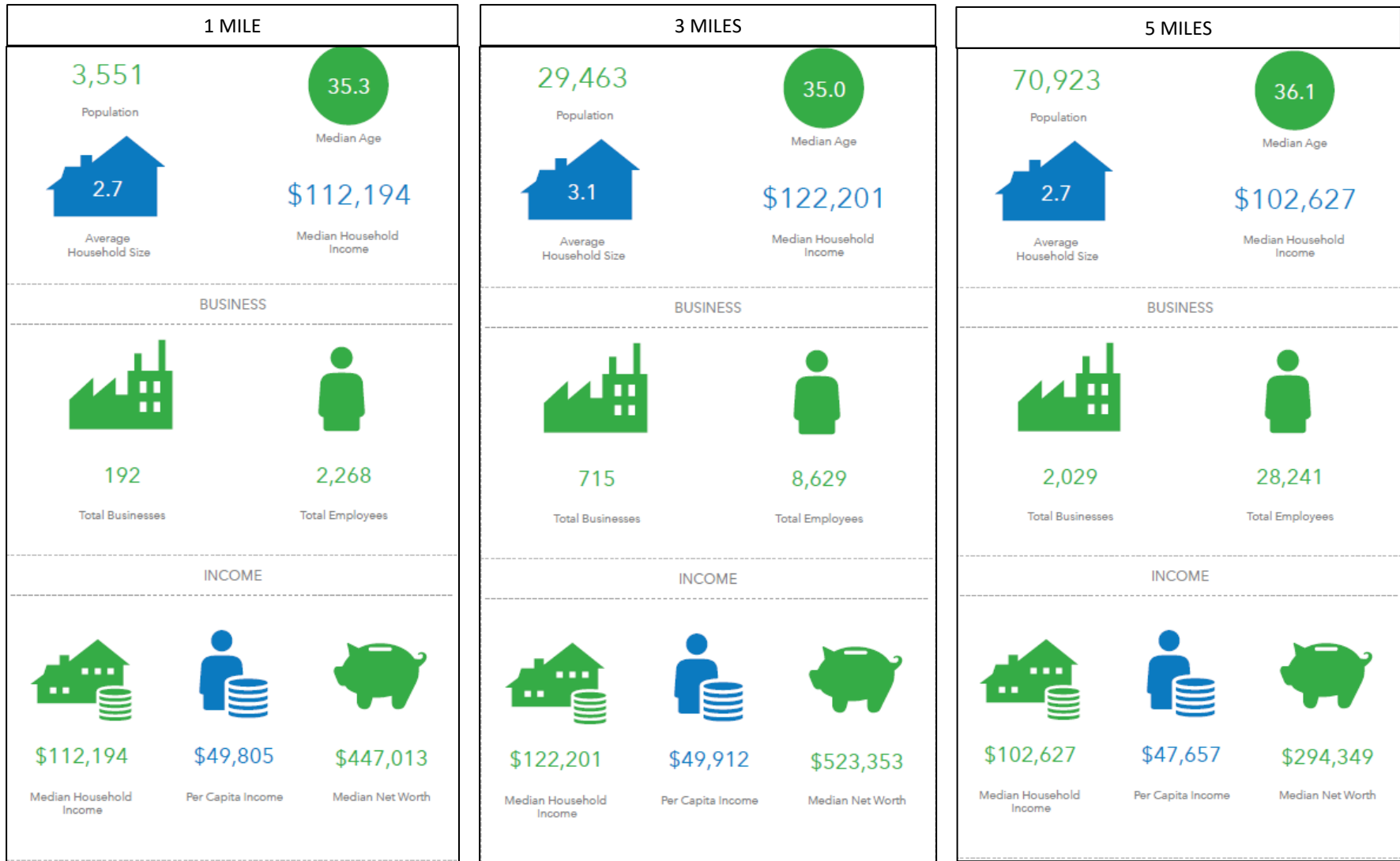

John Handley
 jhandley@fishmancommercial.com
 913.747.3314 O 913.909.1304 C

