

ellis COMMERCIAL
DEVELOPMENT
LEASING & MANAGEMENT

For Lease



1010 Stillwater Avenue
Bangor, Maine

For more information contact

Christina Mudie, Director of Lease Development

(O) 207-848-5704 Ext. 1

(C) 207-745-3307

(e) cmudie@hrsservices.net

www.elliscommercial.com

AREA INFORMATION

1010 Stillwater Ave
Bangor, Maine



This busy strip center is located less than one mile from Exits 186 and 187 of Interstate 95 on the section of Stillwater Avenue that is home to a variety of retailers as well as medical facilities. 1010 Stillwater Avenue is close to some of the areas largest employers like the University of Maine, Orono and Eastern Main Medical Center. Bangor is the second largest metropolitan statistical area in the State serving almost 154,000 residents of Bangor and surrounding Penobscot, Washington, Hancock, Waldo, Somerset, Piscataquis, and Aroostook County cities and towns.

For more information contact

Christina Mudie, Director of Lease Development

(O) 207-848-5704 Ext. 1

(C) 207-745-3307

(e) cmudie@hrsservices.net

www.elliscommercial.com

SITE SPECS

1010 Stillwater Ave
Bangor, Maine



Available:	4,675 +/- SF and 2,020 +/- SF
Zoning:	General Commercial Service District
Traffic Count:	25,000 +/- VPD
Access:	Ample parking on-site in paved lot, space for 150 +/- vehicles
Water/Sewer:	Public
Signage:	Excellent signage with great visibility from Stillwater Ave on large pylon and sign band on building
Exterior:	Wood exterior framed wall
Max Ceiling Height:	14'
Roof:	Rubber membrane
Interior Finish:	Flooring: Exposed concrete ready for custom fit-up Walls: Exposed beams ready for drywall
Fire suppression:	Sprinkler system
HVAC & Electrical:	TBD based on need
Lease Rate:	Negotiable

For more information contact

Christina Mudie, Director of Lease Development
(O) 207-848-5704 Ext. 1
(C) 207-745-3307
(e) cmudie@hrsservices.net

www.elliscommercial.com

FLOOR PLAN

1010 Stillwater Ave
Bangor, Maine

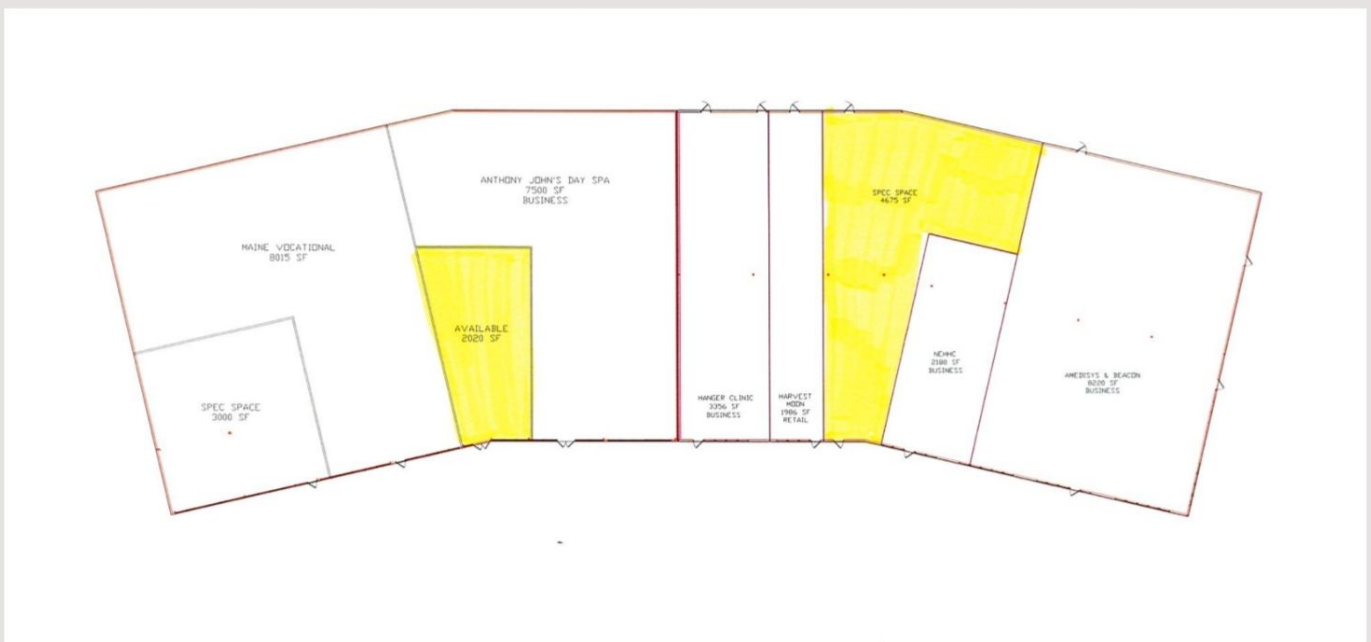

For more information contact

Christina Mudie, Director of Lease Development

(O) 207-848-5704 Ext. 1

(C) 207-745-3307

(e) cmudie@hrsservices.net

www.elliscommercial.com

AERIAL

1010 Stillwater Ave
Bangor, Maine



For more information contact

Christina Mudie, Director of Lease Development

(O) 207-848-5704 Ext. 1

(C) 207-745-3307

(e) cmudie@hrsservices.net

www.elliscommercial.com