

LAND FOR LEASE

RETAIL PAD AVAILABLE

10210 152ND STREET EAST

PUYALLUP, WASHINGTON



PROPERTY INFORMATION

25,000 SF pad

- + \$5,000 per month, NNN
- + Parcel #: 0419223015
- + At lighted intersection
- + High traffic retail corridor Meridian Ave E
- + Utilities included on site
- + 120 feet of frontage
- + Zoning, Urban Village, Pierce County



CONTACT US

KETNER SHEEAN

Senior Associate
+1 253 596 0028
ketner.sheean@cbre.com

CBRE
1201 Pacific Avenue
Suite, 1502
Tacoma, WA 98402

www.cbre.com/tacoma

CBRE

LAND FOR LEASE RETAIL PAD AVAILABLE

10210 152ND ST E
Puyallup, Washington



2016 Estimated Demographics

	1 mile	3 mile	5 mile
Population	8,302	79,107	159,023
# of Households	2,857	27,140	55,950
Avg. Household Income	\$82,203	\$83,662	\$83,152
Daytime Population	4,071	20,897	43,175

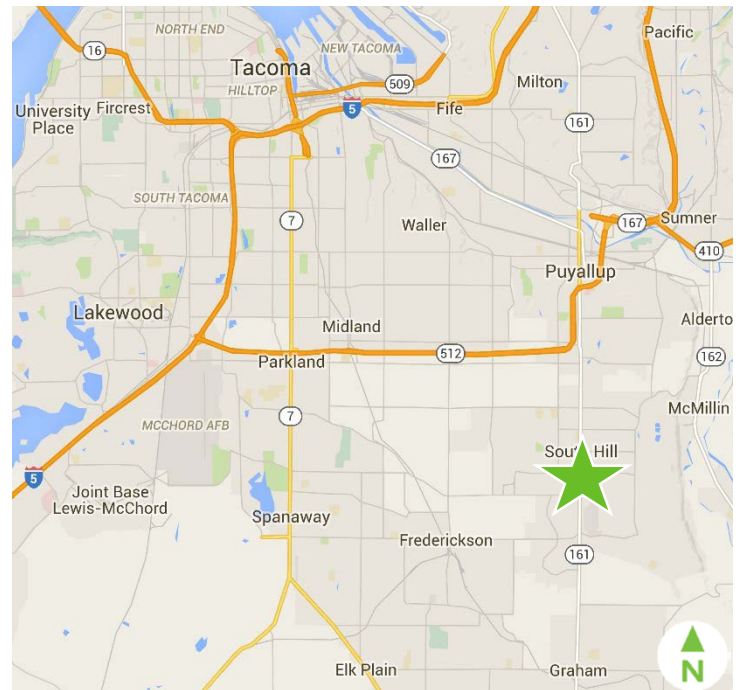

© 2016 CBRE, Inc. This information has been obtained from sources believed reliable. We have not verified it and make no guarantee, warranty or representation about it. Any projections, opinions, assumptions or estimates used are for example only and do not represent the current or future performance of the property. You and your advisors should conduct a careful, independent investigation of the property to determine to your satisfaction the suitability of the property for your needs. Photos herein are the property of their respective owners and use of these images without the express written consent of the owner is prohibited. CBRE and the CBRE logo are service marks of CBRE, Inc. and/or its affiliated or related companies in the United States and other countries. All other marks displayed on this document are the property of their respective owners. mmp 03/28/16

www.cbre.com/tacoma

CBRE

LAND FOR LEASE RETAIL PAD AVAILABLE

10210 152ND ST E
Puyallup, Washington

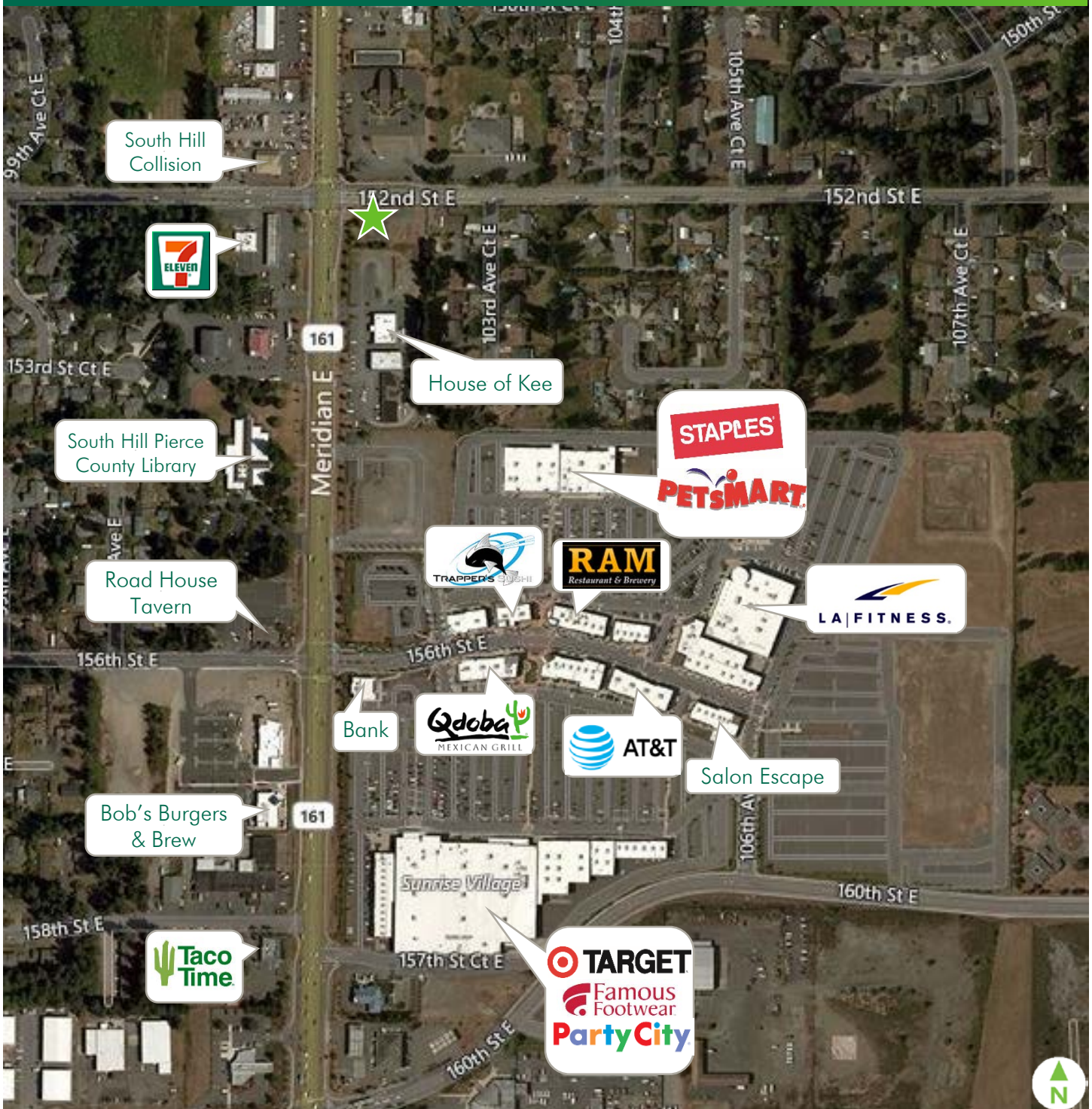

© 2016 CBRE, Inc. This information has been obtained from sources believed reliable. We have not verified it and make no guarantee, warranty or representation about it. Any projections, opinions, assumptions or estimates used are for example only and do not represent the current or future performance of the property. You and your advisors should conduct a careful, independent investigation of the property to determine to your satisfaction the suitability of the property for your needs. Photos herein are the property of their respective owners and use of these images without the express written consent of the owner is prohibited. CBRE and the CBRE logo are service marks of CBRE, Inc. and/or its affiliated or related companies in the United States and other countries. All other marks displayed on this document are the property of their respective owners. mmp 03/28/16

www.cbre.com/tacoma

CBRE