

# 1120 STEVENSON MILL ROAD

Coraopolis, Pennsylvania 15108



**CARGO CORPORATE CENTER**  
11,410 SF Flex Space Available For Lease

**BAKER  
YOUNG**  
CORPORATION

# 1120 STEVENSON MILL ROAD

Coraopolis, Pennsylvania 15108

- ❖ **11,410 SF Flex Space Available**
- ❖ 54,000 SF Building
- ❖ Open space plan
- ❖ Subdividable space
- ❖ Ability to add docks or drive-in doors
- ❖ 320-car parking lot
- ❖ 16' ceiling height
- ❖ HVAC through entire space
- ❖ Convenient access to Pittsburgh International Airport
- ❖ **For Lease at \$7.50/SF to \$10.50/SF, NNN**



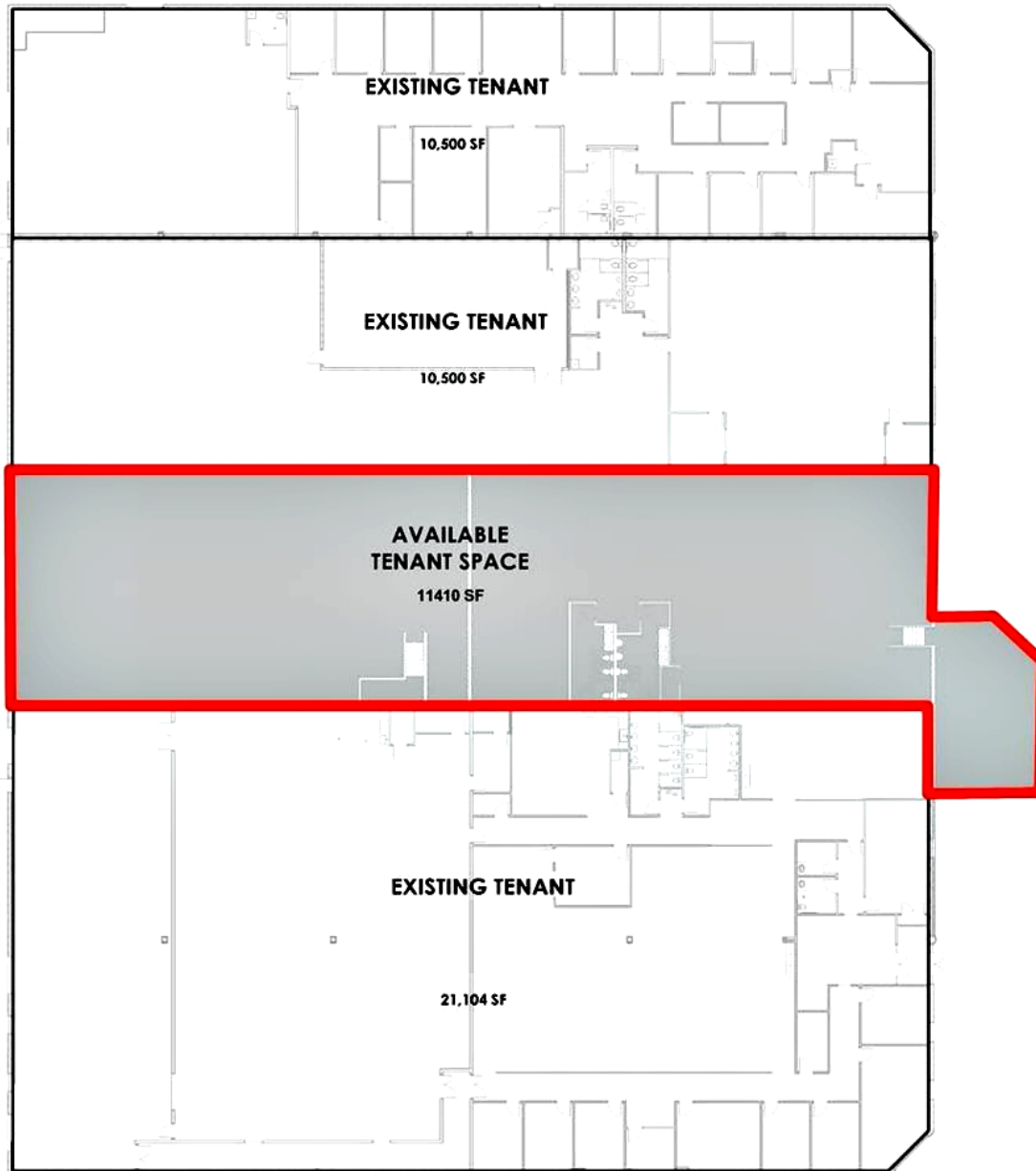

**1** AREA LEASING PLAN  
1" = 20'-0"

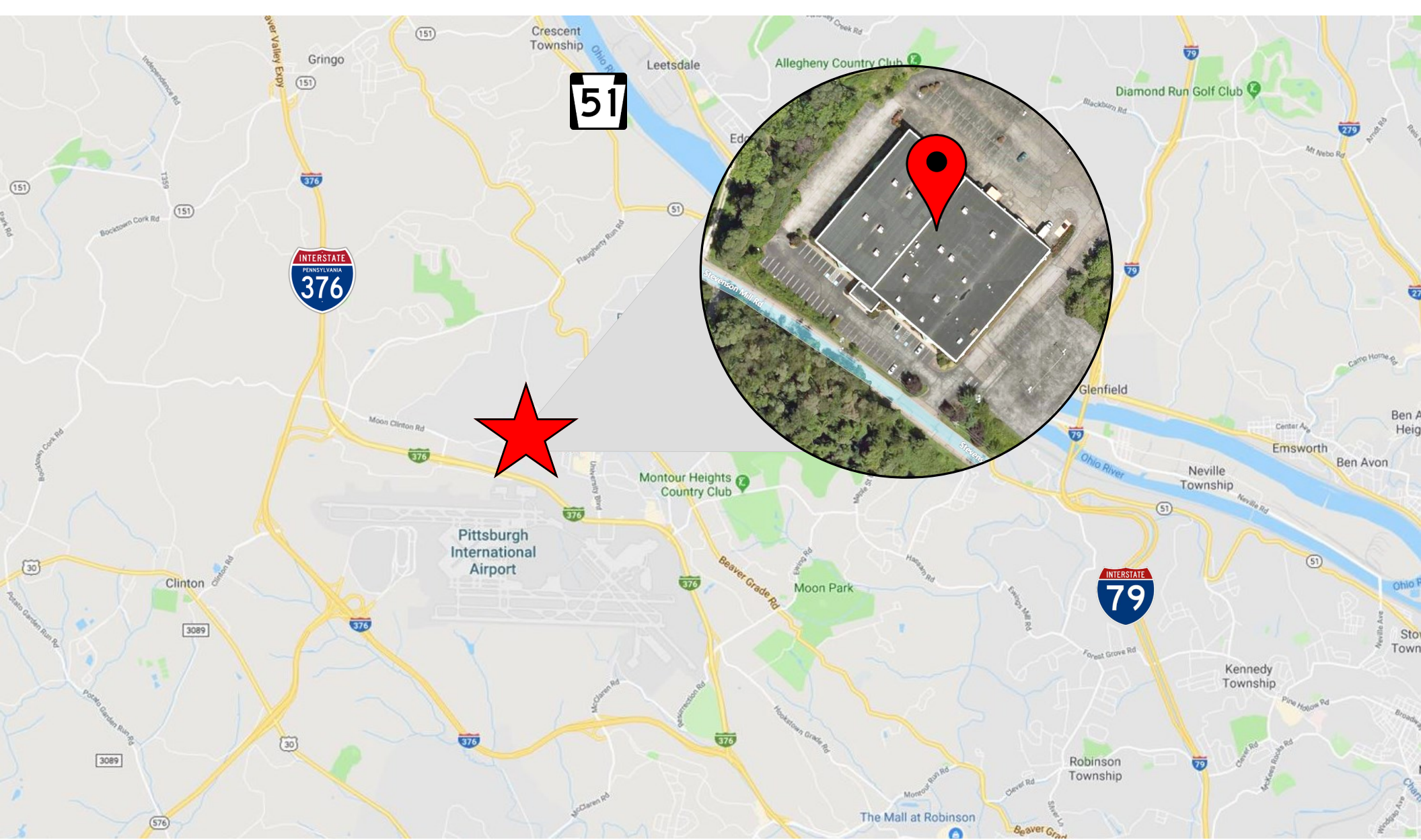

**Michael R. Locke**

Baker Young Corporation  
7440 McKnight Road | Suite 202 | Pittsburgh, PA 15237  
(412) 227-1400 x22  
[mlocke@bakeryoung.com](mailto:mlocke@bakeryoung.com)

**BAKER  
YOUNG**  
CORPORATION

[www.bakeryoung.com](http://www.bakeryoung.com)

*All information furnished regarding this property for sale, rental, or financing is from sources deemed reliable, but no warranty or representation is made as to the accuracy thereof and same is submitted subject to errors, omissions, change of price, rental or other conditions prior to sale, lease or financing or withdrawal without notice. You and your advisors should conduct a careful, independent investigation of the property to determine to your satisfaction the suitability of the property for your needs.*