

Price Reduction

Spokane's South Hill  
Retail Space For Lease  
57<sup>th</sup> & Regal Center

Space  
Available



**5620 S. Regal Street**  
Spokane, WA 99223

### Property Features

- Space Available: 3,000 SF ±
- Double ADA Restrooms
- Travertine Tiled Shower
- Large Enclosed Activity Class Room
- Open Ceiling
- High Parapet Signage Opportunity
- Pylon Sign Availability
- Access off 55<sup>th</sup> St. and Regal St.
- Ample Parking
- Well-Maintained Property

For More Information, Please Contact:

**Stephen Pohl**  
Managing Broker  
+1 509 622 3568  
spohl@naiblack.com



Available Space on Pylon Sign

**Lease Rate: \$22.00 PSF/NNN**

NO WARRANTY OR REPRESENTATION, EXPRESS OR IMPLIED, IS MADE AS TO THE ACCURACY OF THE INFORMATION CONTAINED HEREIN, AND THE SAME IS SUBMITTED SUBJECT TO ERRORS, OMISSIONS, CHANGE OF PRICE, RENTAL OR OTHER CONDITIONS, PRIOR SALE, LEASE OR FINANCING, OR WITHDRAWAL WITHOUT NOTICE, AND OF ANY SPECIAL LISTING CONDITIONS IMPOSED BY OUR PRINCIPALS NO WARRANTIES OR REPRESENTATIONS ARE MADE AS TO THE CONDITION OF THE PROPERTY OR ANY HAZARDS CONTAINED THEREIN ARE ANY TO BE IMPLIED

**NAI Black**

Black Commercial, Inc.  
801 W. Riverside Ave; Suite 300  
Spokane, Washington 992010  
+1 509 623 1000  
naiblack.com



For More Information, Contact:

**Stephen Pohl**  
Managing Broker  
+1 509 622 3568  
spohl@naiblack.com



NAI Black respects the intellectual property rights of others. If you believe that your intellectual property rights have been violated by NAI Black or by a third party who has uploaded Content on our Site, please provide the following information to the NAI Black designated copyright agent as addressed below: a. A description of the copyrighted work or other intellectual property that you claim has been infringed; b. A specific description of where the material that you claim is infringing is located on the Site so the agent is able to locate it; c. An address, telephone number, and e-mail address where NAI Black can contact you and, if different, an e-mail address where the alleged infringing party, if not NAI Black, can contact you; d. A signed statement that you have a good-faith belief that the material use is not authorized by the copyright owner or other intellectual property rights owner, by its agent, or by law. e. A signed statement by you under penalty of perjury that the information in your notice is accurate and that you are the copyright or intellectual property owner or are authorized to act on the owner's behalf; After reviewing the complaint and determining if the complaint is valid, NAI Black will work to quickly remove the infringing material or disable access to it. Note: There are substantial penalties for false claims. NAI Black may request additional information before removing any infringing material. NAI Black may provide the alleged infringing party with your e-mail address so that that person can respond to your allegations. NAI Black has registered a designated agent with the Copyright Office pursuant to 17 U.S.C. 512(c). If you believe your copyright material is being used on this Site without permission, please notify the designated agent as follows:

• **By e-mail:** MaryL@commercialmls.com | Subject Line: Copyright Concern  
• **By mail:** Commercial Brokers Association | Attn: DMCA Designated Agent | 12131 113<sup>th</sup> Ave NE Suite 101 | Kirkland, WA 98034  
If e-mailing your copyright infringement notice, then NAI Black must receive the signed statement(s) mentioned above by mail, or attached to the e-mail, before we are required to take action.

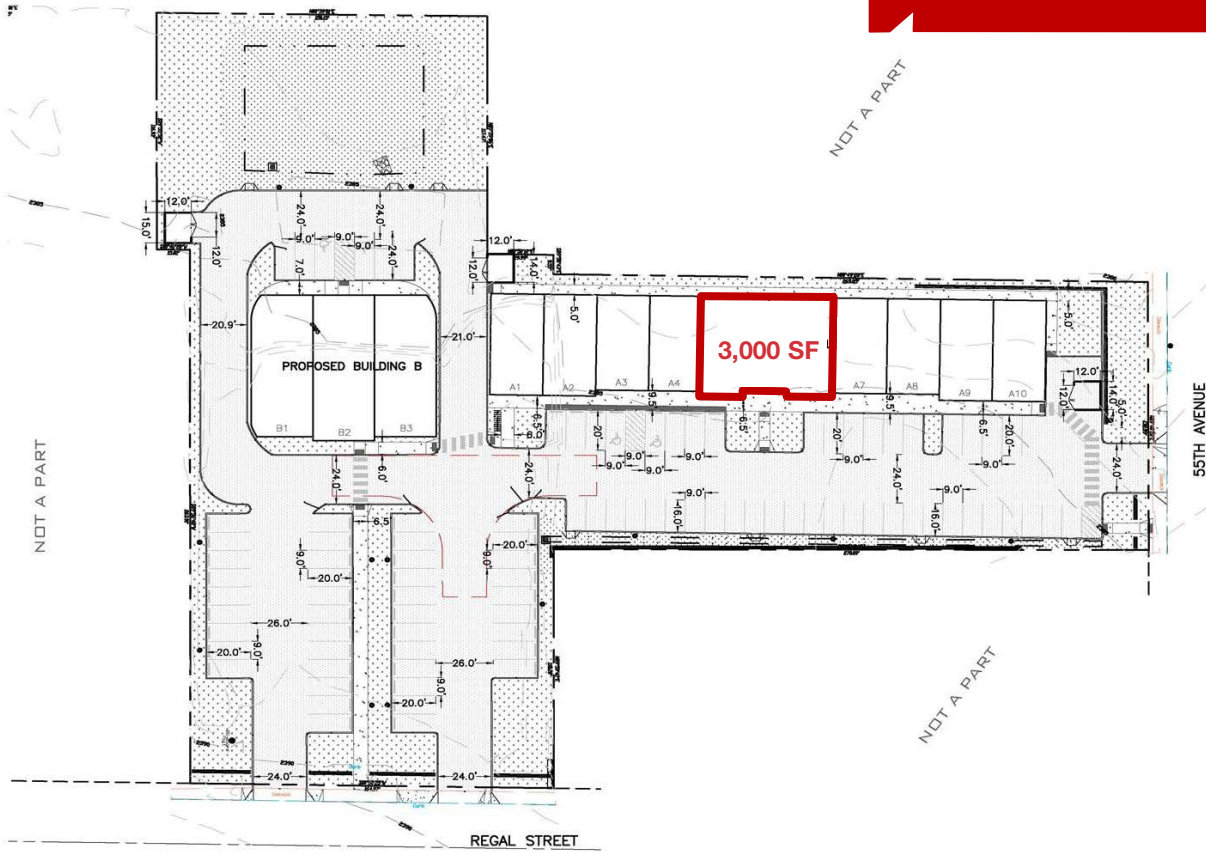

SITE PLAN  
SCALE: 1"=30'

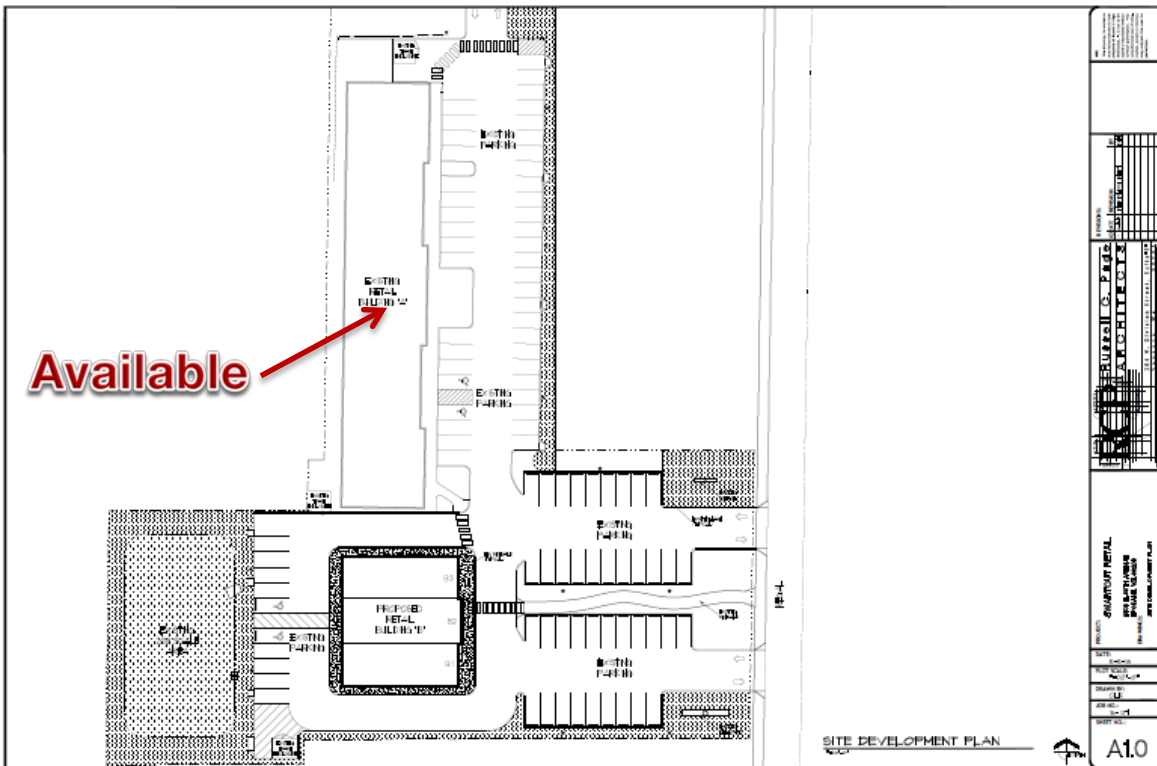

For More Information:

**Stephen Pohl,**  
Managing Broker  
+1 509 622 3568  
spohl@naiblack.com



## South Hill Retail From E. 29th to E. 57th

### 2019 Demographics:

#### Miles

	<u>3 Miles</u>	<u>5 Miles</u>	<u>7 Miles</u>
Population:	54,567	109,393	220,435
Average HHI:	\$101,121	\$83,521	\$73,099
Median Age:	42.6	39.7	38.0
2024 Projected Population:	57,788	115,152	231,654

#### Drive Times

	<u>5 Minutes</u>	<u>10 Minutes</u>	<u>15 Minutes</u>
Population:	20,069	55,361	100,112
Average HHI:	\$94,329	\$97,285	\$84,427
Median Age:	42.5	42.4	40.9
2024 Projected Population:	21,465	58,315	105,340

For More Information:

**Stephen Pohl,**  
**Managing Broker**

+1 509 622 3568  
spohl@naiblack.com

Traffic Counts: S. Regal Street- 16,636 VPD estimated  
E. 57th Avenue- 11,207 VPD estimated

