

MENLO BUSINESS PARK



 **Newmark
Knight Frank**

FRANK COX 408.982.8422
fcox@ngkf.com CA RE License #00889881

SAN JOSE, CA
AVAILABILITY SUMMARY

±3,793 SF

2372 QUME DRIVE | SUITE D:

±**3,793 SQUARE FEET**

- Market Ready Interiors
- ±80% Drop Ceiling Office / R&D Area
- Reception Area
- Two (2) Private Offices
- One (1) Conference Room
- Lunch Area
- Two (2) Restrooms
- Balance Open Ceiling Warehouse
- One (1) Grade Level Truck Door
- Call to Tour

**AVAILABLE
NOW**

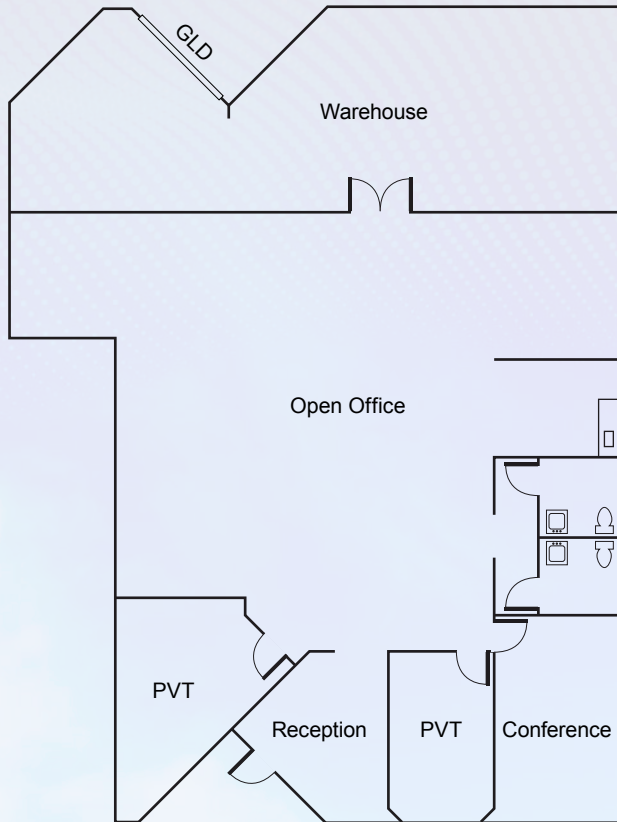

(Floorplan Not to Scale)



±3,793 SQUARE FEET

SITE PLAN

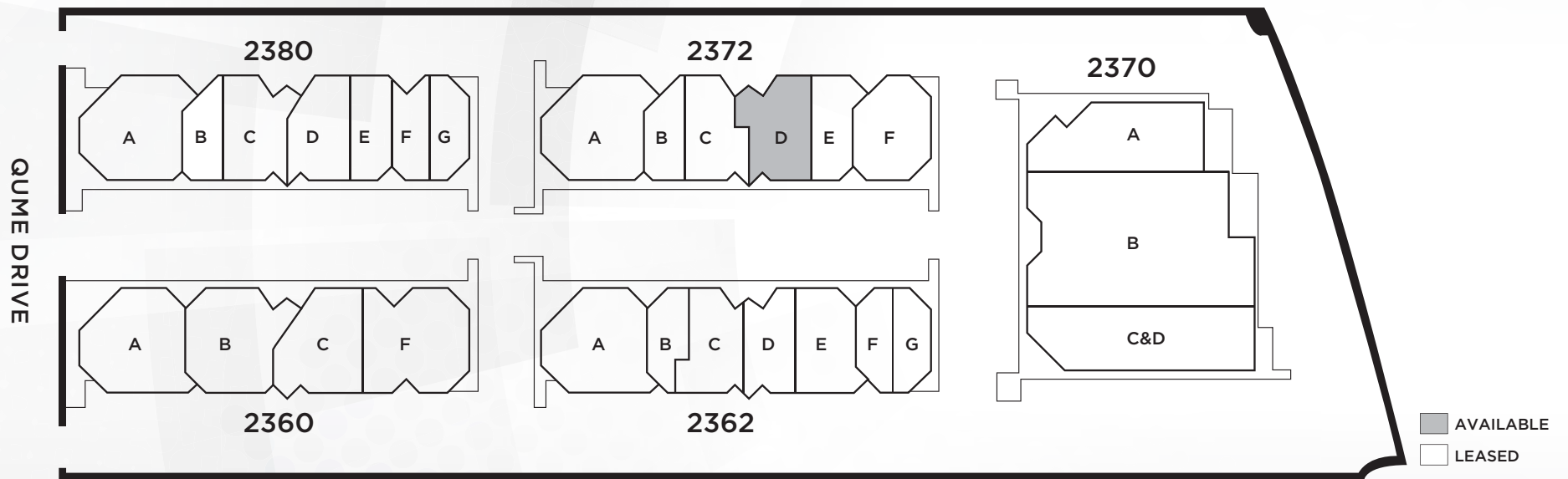

LOCATION MAP

MILPITAS

SANTA CLARA

SAN JOSE



2372 QUME DRIVE
SAN JOSE, CA

FRANK COX | 408.982.8422
fcox@ngkf.com | CA RE License #00889881



3055 Olin Street, Suite 2200
San Jose, CA 95128

The distributor of this communication is performing acts for which a real estate license is required. The information contained herein has been obtained from sources deemed reliable but has not been verified and no guarantee, warranty or representation, either express or implied, is made with respect to such information. Terms of sale or lease and availability are subject to change or withdrawal without notice. 19-1618 • 07/20