



FOR SALE

**624 S Kansas Avenue**

Olathe, KS 66061



**±2,564 SF of Buildings / ±.31 Acres**  
**Sale Price: \$240,000**

### Property Highlights

- M-2 Zoning (General Industrial District)
- 9 drive-in doors (drive through bays)
- Built in 1964
- Fenced, concrete outside storage
- Located in Opportunity Zone
- Great access to 56 Highway and I-35

**Rob M. Holland, CCIM**  
Director  
+1 816 412 0214  
rob.holland@cushwake.com

4600 Madison Avenue, Suite 800  
Kansas City, MO 64112  
Main +1 816 221 2200  
Fax +1 816 842 2798  
**cushmanwakefield.com**

## Buildings Features

### OVERVIEW

**Address** 624 S Kansas Avenue, Olathe, KS 66061

**Square Feet** ±2,564

**Office Square Feet** None

**Taxes** \$3,098

### CONSTRUCTION

**Construction** Cherokee Block on Steel Frame

**Roof Type** Corrugated Metal

**Fire Protection** None

**Heat** None

### FEATURES

**Site Area** ±.31 Acres

**Zoning** M-2

**Year Built** 1964

**Clear Height** 10' - 12'

**Loading** 9 DI (7 - 10'x12') (2 - 12'x12')

**Lights** Fluorescent



Floor Plan

**Warehouse Structure**  
2564.0 sf

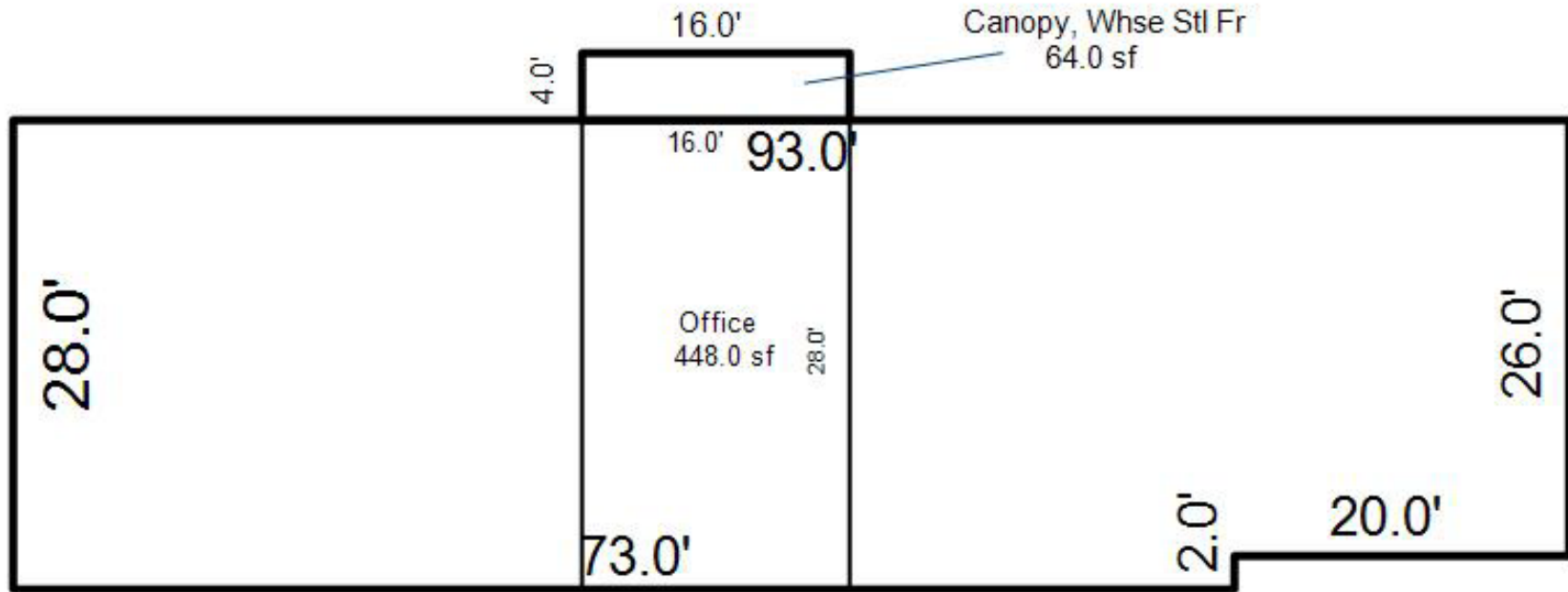

**Location Aerial**

