

EST.  2015

# THE VILLAGE

AT TOTEM LAKE







# FOR LEASE

OFFICE SPACE AT



**THE VILLAGE**  
AT TOTEM LAKE

**EXCLUSIVELY REPRESENTED BY**

## JOE LYNCH

Executive Managing Director  
joe.lynch@ngkf.com  
425.362.1399

## DAN HARDEN

Senior Managing Director  
dan.harden@ngkf.com  
425.362.1393

Newmark Knight Frank  
10900 NE 4th St, Suite 1430  
Bellevue, WA 98004

ngkf.com

The distributor of this communication is performing acts for which a real estate license is required. The information contained herein has been obtained from sources deemed reliable but has not been verified and no guarantee, warranty or representation, either express or implied, is made with respect to such information. Terms of sale or lease and availability are subject to change or withdrawal without notice.





# BUILDING FEATURES

HIGHLY DESIRABLE  
 LIVE, WORK, PLAY  
 LOCATION

EASY ACCESS TO  
 I-405 WITH A  
 VARIETY OF  
 COMMUTING  
 OPTIONS

UNIQUE  
 ENVIRONMENT  
 OFFERING A HIGH  
 QUALITY OF LIFE  
 EXPERIENCE



ABUNDANCE OF  
 WALKABLE  
 AMENITIES

STATE-OF-THE-ART,  
 MIXED-USE,  
 LIFESTYLE CENTER







**\$48.00**  
 ASKING  
 LEASE RATE  
 (FULL SERVICE)

**13,970**  
 NET RENTABLE  
 SQUARE FEET

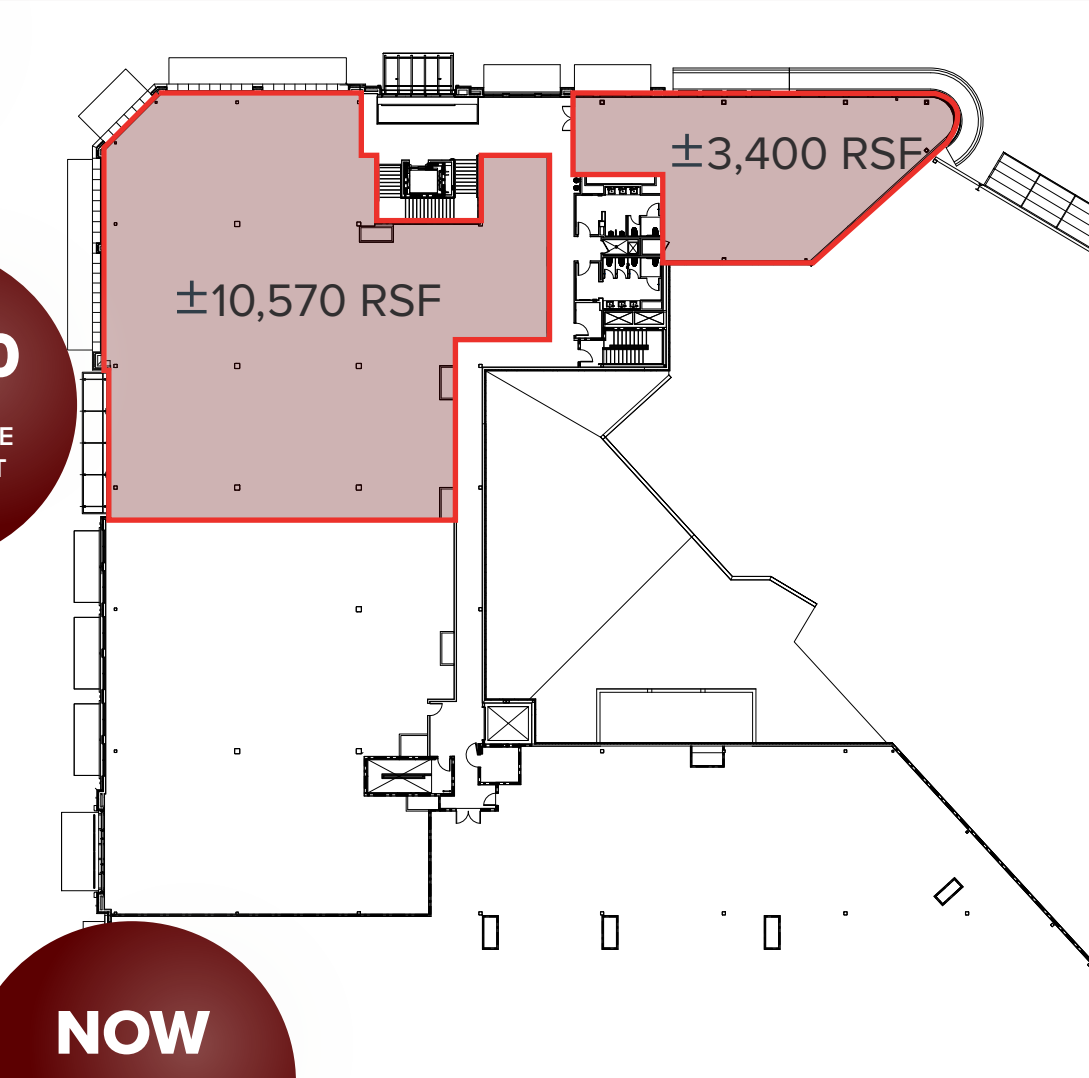

**NOW**  
 AVAILABLE TO  
 BEGIN TENANT SHELL  
 BUILD-OUT





**2ND-STORY OFFICE**