



Vermillion Warehouse

1212 N. Norbeck St., Vermillion, SD 57069

Property Features

- Building size: 45,440 sq. ft.
- Lot size: 8.2 acres
- Zoning: Light Industrial
- Year built: 1995
- Two loading docks, two grade doors
- 1600 amp, 3-Phase power
- 24' sidewalls
- Multiple overhead cranes
- Heated & cooled
- Entire building sprinklered

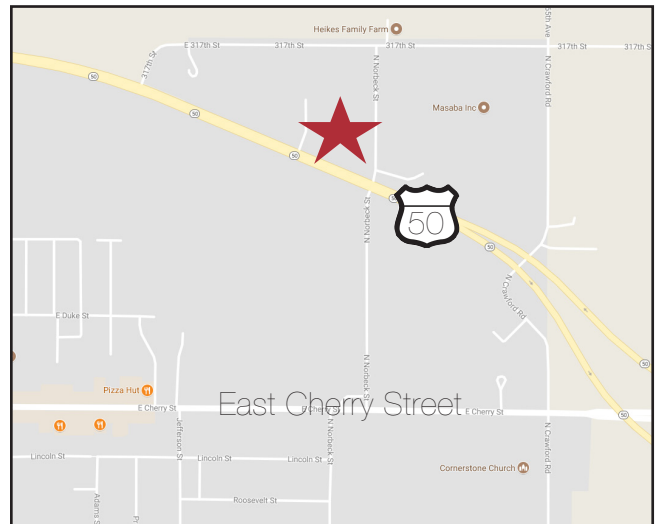

Pricing

- Lease rate is \$4.00/ sq. ft. NNN
- NNN estimated at \$1.00/ sq. ft.

Location

- Located on Highway 50
- Area neighbors include: Masaba Inc., Johnson Feeds, Coyote Chemical, Midwest Ready Mix & Equipment



Troy Fawcett, CCIM, SIOR
President/Principal Broker

+1 605 444-7120 Direct
+1 605 321-2199 Cell
tfawcett@naisiouxfalls.com

NO WARRANTY OR REPRESENTATION, EXPRESS OR IMPLIED, IS MADE AS TO THE ACCURACY OF THE INFORMATION CONTAINED HEREIN, AND THE SAME IS SUBMITTED SUBJECT TO ERRORS, OMISSIONS, CHANGE OF PRICE, RENTAL OR OTHER CONDITIONS, PRIOR SALE, LEASE OR FINANCING, OR WITHDRAWAL WITHOUT NOTICE, AND OF ANY SPECIAL LISTING CONDITIONS IMPOSED BY OUR PRINCIPALS NO WARRANTIES OR REPRESENTATIONS ARE MADE AS TO THE CONDITION OF THE PROPERTY OR ANY HAZARDS CONTAINED THEREIN ARE ANY TO BE IMPLIED.

2500 W. 49th Street, Suite 100
Sioux Falls, SD 57105
+1 605 357 7100
naisiouxfalls.com

For Lease
Industrial Building
Vermillion, SD



For Lease
 Industrial Building
 Vermillion, SD



AMERICAN MIDWEST POWER <small>DIVISION OF A.M.P. MANUFACTURING & SUPPLY, INC. MINNEAPOLIS, MN</small>		WARNING DEVICES INSTALLED IN THIS EQUIPMENT MUST BE NEW, NOT USED, OF IDENTICAL TYPE, QUALITY AND MANUFACTURE AS THOSE INSTALLED BY AMERICAN MIDWEST POWER. OR THE EQUIPMENT MAY BE MADE DANGEROUS FOR ITS INTENDED USE.	
TYPE	F-FDP	ENCL	1
FILE	96-17151C	DATE	2-29-96
VOLTAGE	480Y/277	SYSTEM	3Ø 4W
AMPS-SUPPLY	1600	SECTION	1600
USE	75°C	CONDUCTORS HERTZ	60
		SECTION NO.	1 OF 1
SUITABLE FOR USE AS SERVICE ENTRANCE EQUIPMENT L1289			
Underwriters Laboratories Inc.® <small>LISTED</small> DEAD FRONT SWITCHBOARD SECTION No. C 820575 OF		DANGER HAZARD OF ELECTRICAL SHOCK OR BURN TURN OFF POWER SUPPLYING THIS EQUIPMENT BEFORE WORKING INSIDE 3401A1285	P 062347418

