



## PROMINENT CORNER LOCATION

Join Midtown South at 475 Park Avenue South. This unbeatable corner location features an all-glass, double-height facade steps from the entrance to the 6 subway line with 9.5 million annual riders.

Located at the southeast corner of East 32nd Street

### SIZE

Ground Floor	7,000 SF
Mezzanine	2,500 SF
Total	9,500 SF

### POSSESSION

January 2022

### TERM

Negotiable

### FRONTAGE

168 FT of wraparound

### SITE STATUS

Currently TD Bank

## GROUND FLOOR

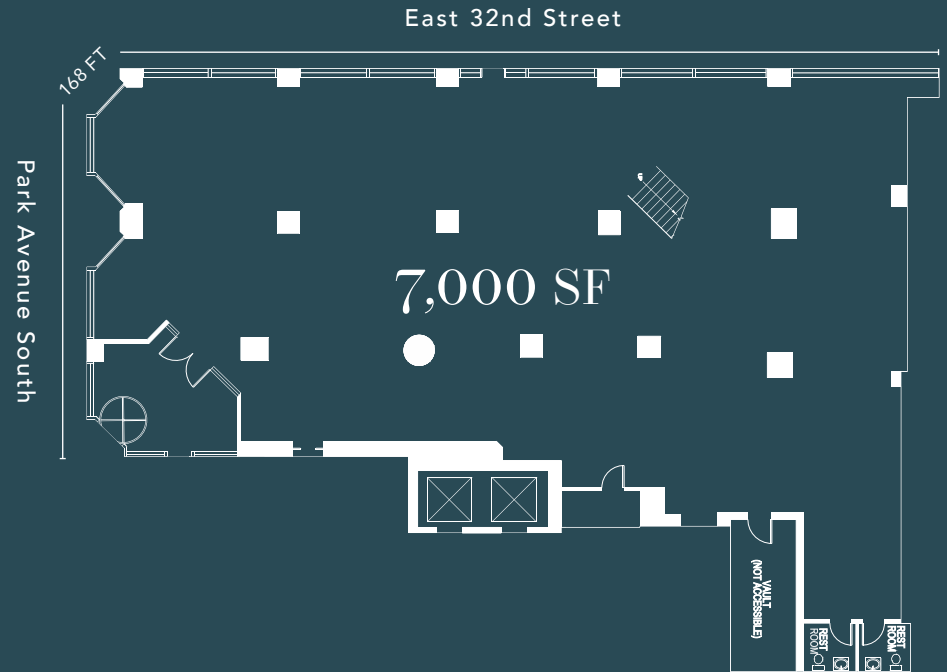

## MEZZANINE

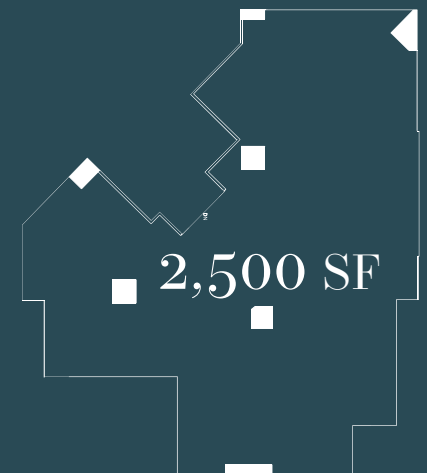

## AREA RETAIL

Join neighbors Starbucks, Citibank, Capital One Bank, Sweetgreen, Chase Bank, Wolfgang's Steakhouse and Equinox.

CONTACT  
EXCLUSIVE AGENTS

Lucas Kooyman

212.372.2384

lkooyman@ngkf.com

Jason Pruger

212.372.2092

jpruger@ngkf.com

Adam Weinblatt

212.372.2103

aweinblatt@ngkf.com

# NEWMARK

© 2020 NEWMARK. The information contained herein has been obtained from sources deemed reliable but has not been verified and no guarantee, warranty or representation, either express or implied, is made with respect to such information. Terms of sale or lease and availability are subject to change or withdrawal without notice.

