

2359 JOSLYN COURT  
LAKE ORION, MICHIGAN

RETAIL/LAND FOR SALE

47,063 Square Feet / 15.6 Acres Available



**SIGNATURE  
ASSOCIATES**  
KNOW SIGNATURE | KNOW RESULTS

**OLDE WORLD CANTERBURY VILLAGE**



## PROPERTY FEATURES

- 47,063 available square feet
- Site is set up as two condos
  - Canterbury Village
  - Woodside Bible Church
- 15.6 acres
- Zoned SP-1
- Built in 1993
- 771 parking spaces
- Sale Price: \$5,200,000 (\$110.49/sq.ft.)

**Comments:** Olde World Canterbury Village is a one-of-a-kind opportunity with 15.6 acres of land and several buildings on-site. It has a convenient location off of Joslyn Road and is an attraction for the local community.



For more information, please contact:

**ANGELA THOMAS**  
(248) 359 3838  
athomas@signatureassociates.com

**ERICA DUNLAP**  
(248) 359 3808  
edunlap@signatureassociates.com

**BRAD VIERGEVER**  
(248) 799 3146  
bviergever@signatureassociates.com



# 2359 Joslyn Court – Lake Orion, Michigan

Retail / Land For Sale

47,063  
Square Feet /  
15.6 Acres  
AVAILABLE

## DEMOGRAPHICS

	POPULATION	MED. HH INCOME
1 MILE	2,832	\$108,222
3 MILE	29,972	\$104,511
5 MILE	90,172	\$99,438

## TRAFFIC COUNTS (TWO-WAY)

12,576	Joslyn Rd. N. of Scripps Rd. 2-Way
11,696	Joslyn Rd. S. of Scripps Rd. 2-Way
1,295	Scripps Rd. E. of Joslyn Rd. 2-Way



For more information, please contact:

**ANGELA THOMAS**  
(248) 359 3838

**ERICA DUNLAP**  
(248) 359 3808

**BRAD VIERGEVER**  
(248) 799 3146

**SIGNATURE ASSOCIATES**  
One Towne Square, Suite 1200  
Southfield, MI 48076  
[www.signatureassociates.com](http://www.signatureassociates.com)

# 2359 Joslyn Court – Lake Orion, Michigan

## Retail / Land For Sale

47,063  
Square Feet /  
15.6 Acres  
AVAILABLE

### Site Plan

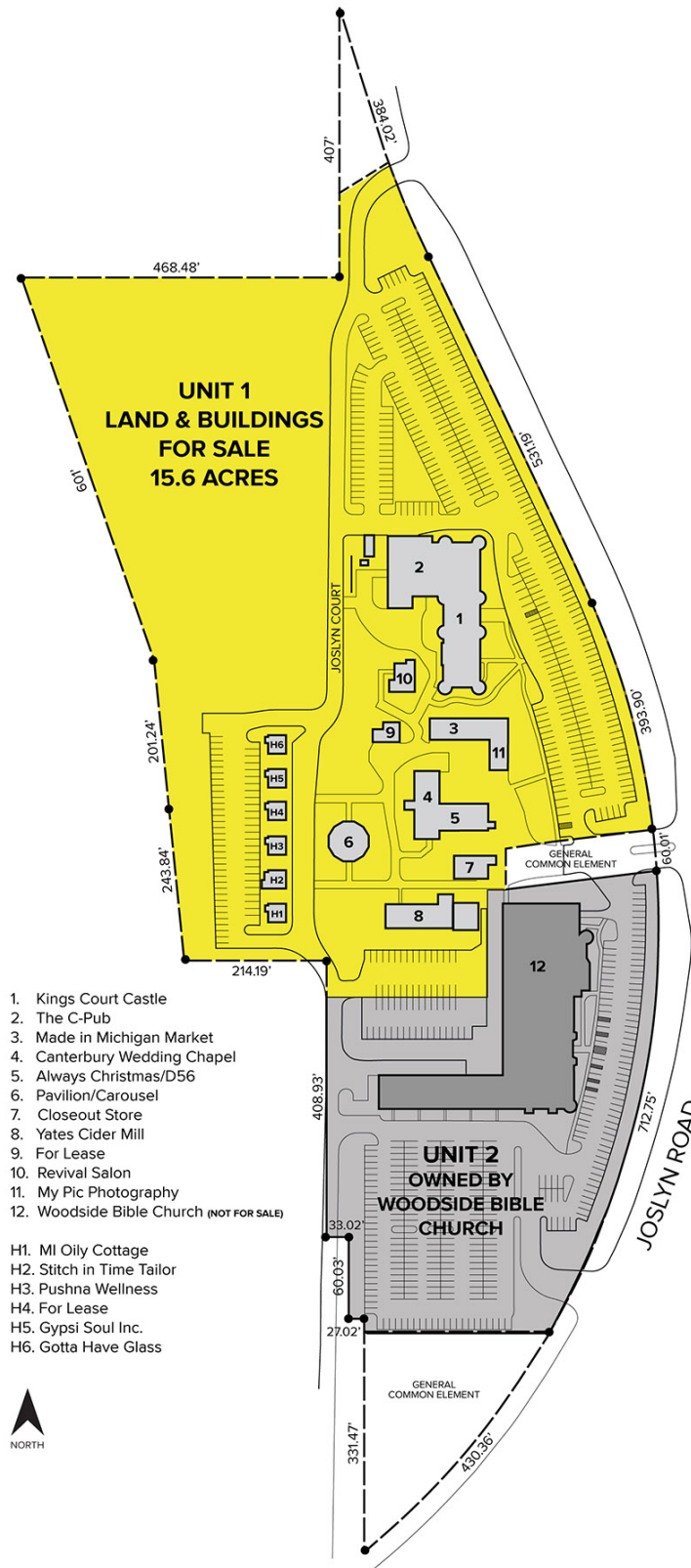

- 1. Kings Court Castle
  - 2. The C-Pub
  - 3. Made in Michigan Market
  - 4. Canterbury Wedding Chapel
  - 5. Always Christmas/D56
  - 6. Pavilion/Carousel
  - 7. Closeout Store
  - 8. Yates Cider Mill
  - 9. For Lease
  - 10. Revival Salon
  - 11. My Pic Photography
  - 12. Woodside Bible Church (NOT FOR SALE)
- H1. MI Oily Cottage
  - H2. Stitch in Time Tailor
  - H3. Pushna Wellness
  - H4. For Lease
  - H5. Gypsi Soul Inc.
  - H6. Gotta Have Glass



For more information, please contact:

**ANGELA THOMAS**  
(248) 359 3838

**ERICA DUNLAP**  
(248) 359 3808

**BRAD VIERGEVER**  
(248) 799 3146

**SIGNATURE ASSOCIATES**  
One Towne Square, Suite 1200  
Southfield, MI 48076  
www.signatureassociates.com