

THE PERFECT BASS
6441 JONES CREEK ROAD
BATON ROUGE, LOUISIANA

TENANT FINISH OUT FOR

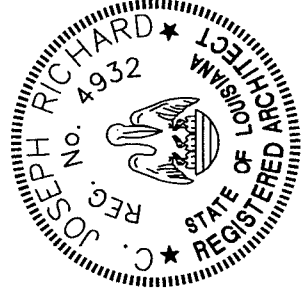

EXISTING SITE PLAN
1/32" = 1'-0"

1

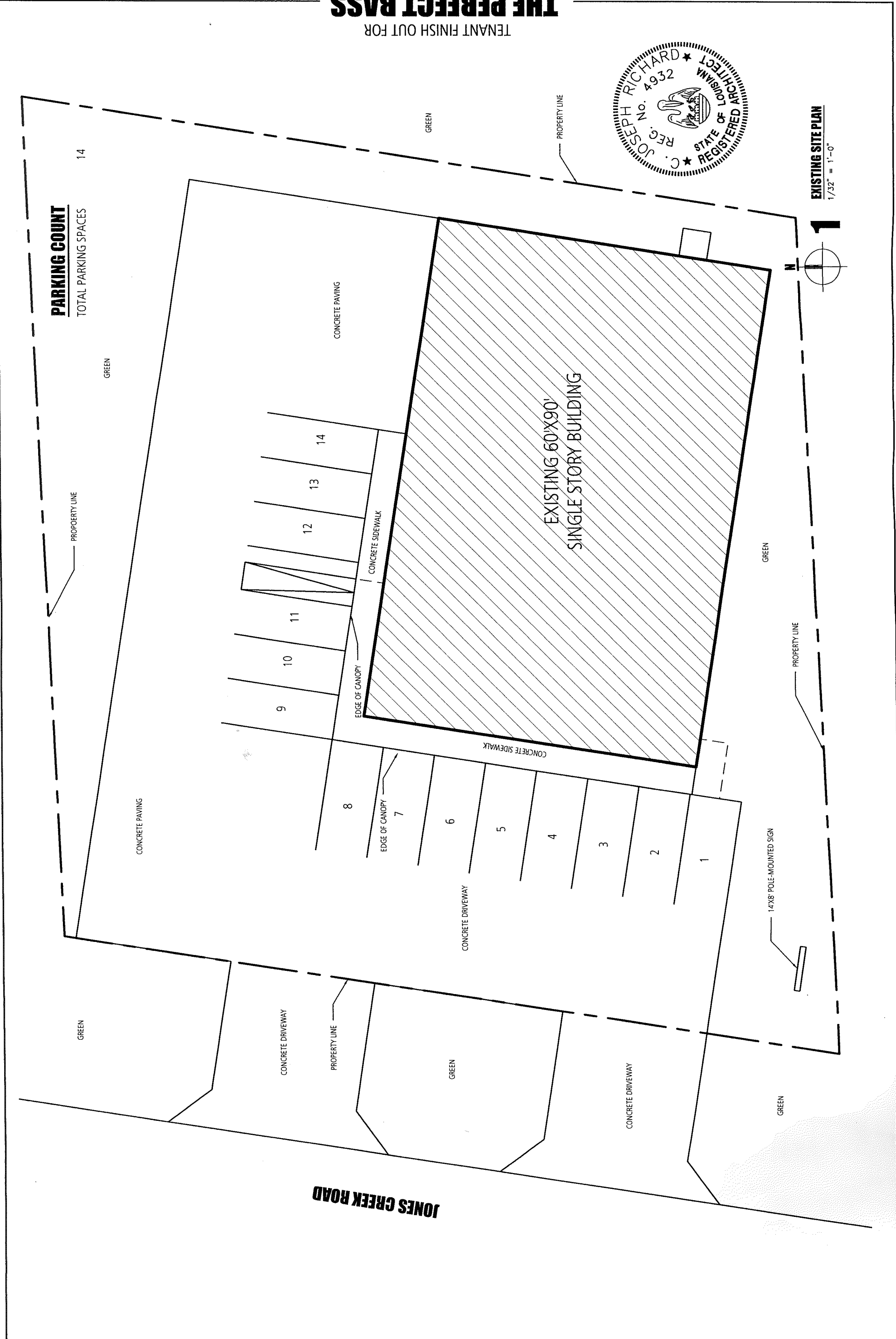
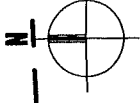

PARKING COUNT

TOTAL PARKING SPACES

14

GREEN

PROPERTY LINE

CONCRETE PAVING

GREEN

CONCRETE DRIVEWAY

PROPERTY LINE

GREEN

CONCRETE DRIVEWAY

GREEN

14'x8' POLE-MOUNTED SIGN

PROPERTY LINE

GREEN

EXISTING 60'x90'
SINGLE STORY BUILDING

CONCRETE PAVING

GREEN

PROPERTY LINE

EDGE OF CANOPY

CONCRETE SIDEWALK

CONCRETE SIDEWALK

CONCRETE DRIVEWAY

EDGE OF CANOPY

CONCRETE DRIVEWAY

JONES CREEK ROAD