



AVAILABLE



Retail Condominium Property For Sale



LOCATION: 3709 Westbank Expressway, Harvey, LA
Units 4, 6 and 7-12

DESCRIPTION: Total of 12,150 s/f;

- Units 4 & 6 are approximately 1,440 s/f each
- Units 7-12 are approximately 9,240 s/f total and function presently as a Grocery store by Seller.

Units 4 and 6 are currently rented at \$1,000/month Gross each. Both are on 1 year leases.

CONDO DUES: Presently \$910 per month

OFFERED AT: \$1,095,000.00

**JACK STUMPF
& ASSOCIATES, INC.**

COMMERCIAL REAL ESTATE SERVICES

1700 Central Boulevard
Harvey, Louisiana 70058
(504) 366-6800
www.jackstumpf.com

**Contact: Joseph Maerke, CCIM
504-366-6800**

Licensed In LA

The information presented herein has been furnished by the owner or obtained from sources we deem reliable. No warranties or representations, either expressed or implied are made as to the accuracy of the data provided, and same is subject to error, omission, change of price, and/or conditions of availability without notice.

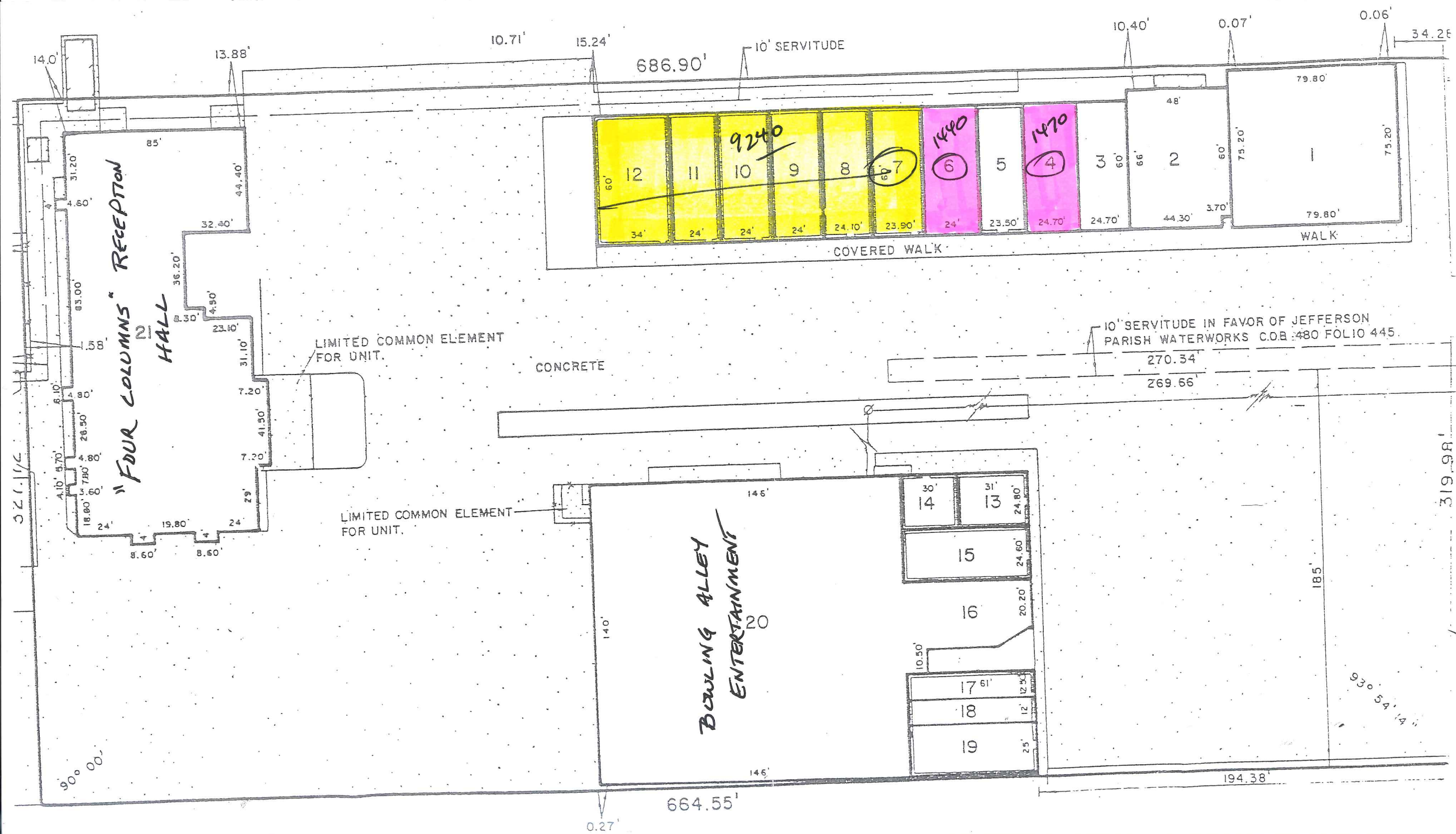

10' SERVITUDE IN FAVOR OF JEFFERSON PARISH WATERWORKS C.O.B. 480 FOLIO 445.

WESTBANK EXPRESSWAY

93° 54' 14"