



Altamonte Capital Center

MEDICAL / OFFICE SPACE FOR LEASE

249 & 251 Maitland Ave., Altamonte Springs, FL 32701

Contact: Dan Van Nada, CCIM
Vice President of Brokerage Services

E: Dan@FCPG.com
P: 407.872.0177 ext. 117

Contact: Ben Kuykendall
Sales & Leasing Associate

E: Ben@FCPG.com
P: 407.872.0177 ext. 131

For Lease: \$18.00 / RSF, Full Service

± 496 - 3,963 RSF Available

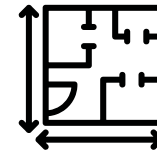

**FLEXIBLE SUITE
LAYOUTS AVAILABLE**

**5% COMMISSION TO
PROCURING BROKER**

Under new management & ownership: extensive building renovations recently completed

On-site parking with a ratio of 7 / 1,000

Prominent monument signage available

Strategically located just South of high-traffic Semoran Blvd / SR 436 (AADT 66,000) and 4 minutes from I-4 interchange

Varied suite layouts available for high degree of flexibility and customization

Within 1 mile of Florida Hospital, Uptown Altamonte / Cranes Roost, Altamonte Mall, Sunrail Station and Eastmonte Park

DEMOGRAPHICS

2023



Total Population



Total Households



Average HH Income

1 Mile

11,640

5,659

\$82,894

3 Miles

89,554

39,144

\$98,403

5 Miles

253,463

107,101

\$99,089

615 E. Colonial Dr., Orlando, FL 32803 Phone: 407.872.0209 www.FCPG.com

Information furnished regarding the subject property is believed to be accurate, but no guarantee or representation is made. References to square footage are approximate. This offering is subject to errors, omissions, prior sale or lease or withdrawal without notice. ©2024 First Capital Property Group, Inc., Licensed Real Estate Brokers & Managers.

LOCATION

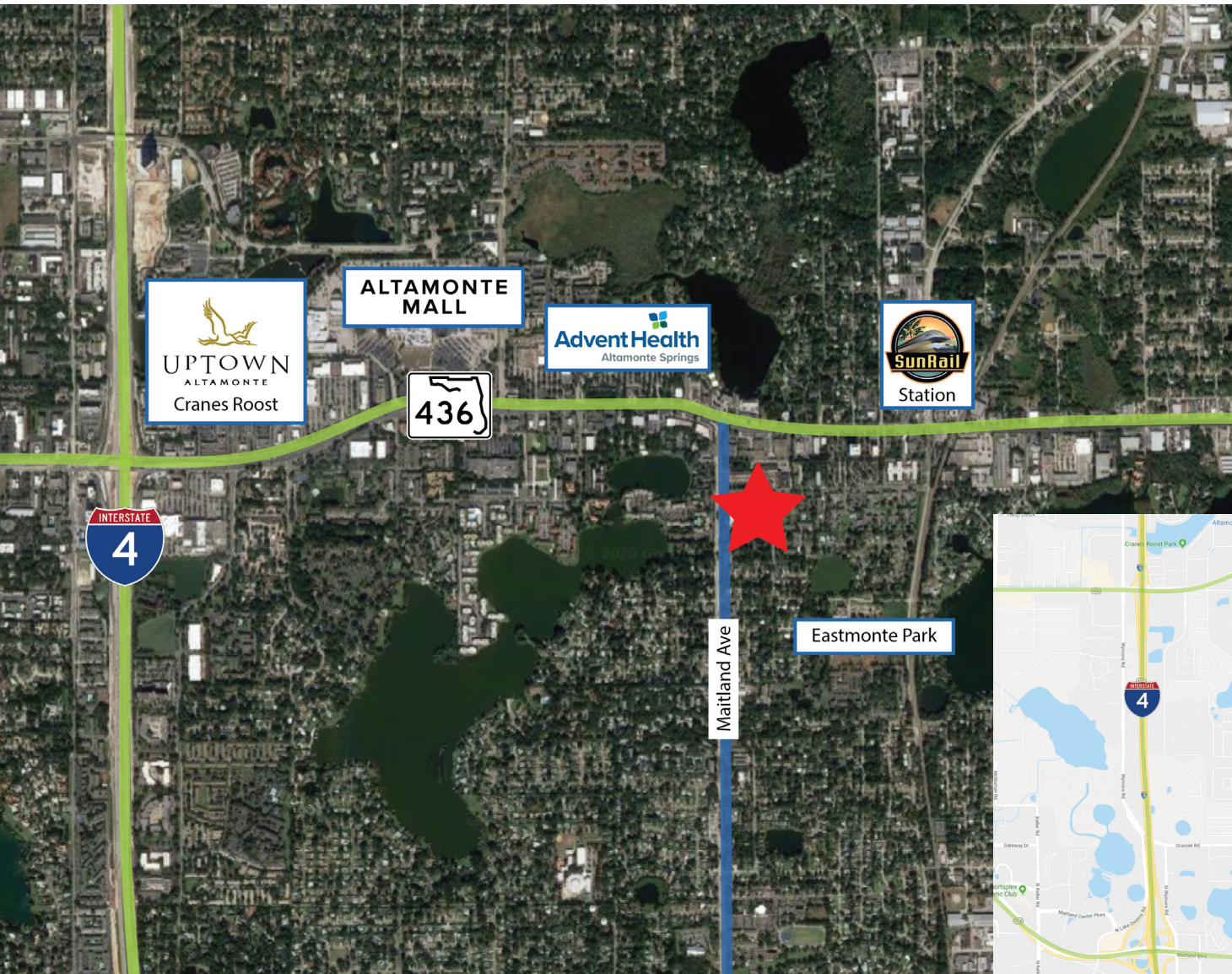

\$99,089
AVERAGE HH INCOME
WITHIN 5 MILE RADIUS



107,101
HOUSEHOLDS
WITHIN 5 MILE RADIUS

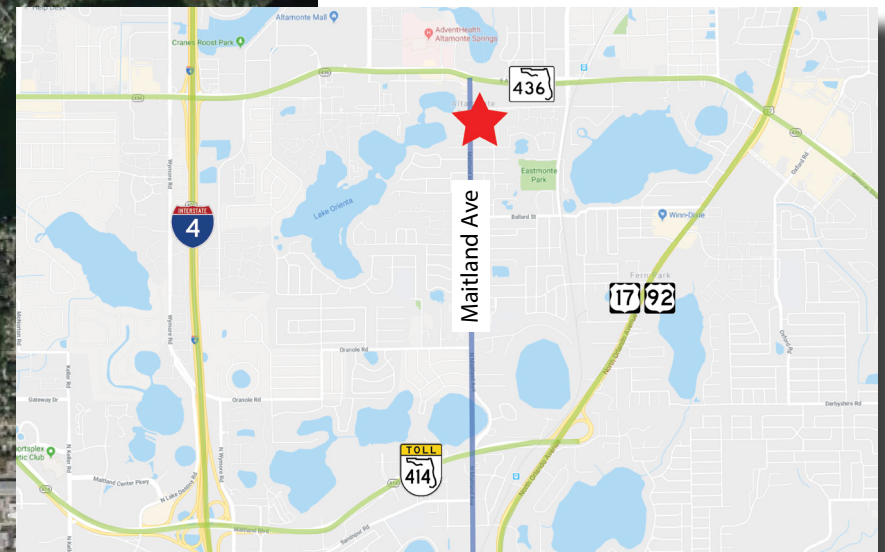

■ 615 E. Colonial Dr., Orlando, FL 32803 ■ Phone: 407.872.0209 ■ www.FCPG.com ■

Information furnished regarding the subject property is believed to be accurate, but no guarantee or representation is made. References to square footage are approximate. This offering is subject to errors, omissions, prior sale or lease or withdrawal without notice. ©2024 First Capital Property Group, Inc., Licensed Real Estate Brokers & Managers.

AVAILABILITY

AVAILABLE IMMEDIATELY

Building 249

Suite 3100: 1,981 RSF

Suite 3200: 1,982 RSF

Suite 3100 / 3200: 3,963 RSF

Building 251

Suite 201: 1,049 RSF

Suite 204: 496 RSF

Suite 304: 1,039 RSF

Floorplans Available by Request.

■ 615 E. Colonial Dr., Orlando, FL 32803 ■ Phone: 407.872.0209 ■ www.FCPG.com ■

Information furnished regarding the subject property is believed to be accurate, but no guarantee or representation is made. References to square footage are approximate. This offering is subject to errors, omissions, prior sale or lease or withdrawal without notice. ©2024 First Capital Property Group, Inc., Licensed Real Estate Brokers & Managers.

