



RETAIL FOR LEASE

# VALLEY CREEK COMMONS

SEQ I-494 & Valley Creek Rd | Woodbury, MN



BIELLENB...



SAVERS

95,000 VPD



KOHL'S

Woodbury THEATRE

Total Wine



VALLEY CREEK RD



SUBWAY



MGM



WOODBURY VILLAGE

BARNES NOBLE



38,500 VPD



SITE



WELLS FARGO

26,000 VPD



CONTACT

MOLLY TOWNSEND | 612.359.1693  
molly.townsend@transwestern.com



# OVERVIEW



## PROPERTY INFORMATION

- Location: SEQ I-494 & Valley Creek Rd | Woodbury, MN
- Building GLA: 5,000 sf
- Delivery: Construction starting summer 2020 w/ fall delivery



## AVAILABLE

- 5,000 sf strip w/ drive-thru
- Divisible to 1,500 sf



## DEMOGRAPHICS

Radius:	1 Mile	3 Mile	5 Mile
Population	6,939	69,641	179,745
Total Employees	7,482	42,071	64,221
Average HH Income	\$89,111	\$102,430	\$93,907

*\*Sources: ESRI 2019 est & MN Dept of Transportation 2019 Study avgs are per day total cars*



## TRAFFIC COUNTS

- 38,500 vpd - Valley Creek Rd
- 92,000 vpd - I-494



## COMMENTS

- Chick-fil-A opening on-site
- Located across Valley Creek from Target, Lunds & Byerlys, Total Wine and Walgreens
- High income area
- Strong traffic counts
- Endcap and drive-thru available



## AREA TENANTS



## CONTACT

**MOLLY TOWNSEND | 612.359.1693**

molly.townsend@transwestern.com

The information provided herein was obtained from sources believed reliable; however, Transwestern makes no guarantees, warranties or representations as to the completeness or accuracy thereof. The presentation of this property is submitted subject to errors, omissions, change of price or conditions, prior sale or lease, or withdrawal without notice. Copyright © 2018 Transwestern.

# OVERALL SITE PLAN

# VALLEY CREEK COMMONS

SEQ I-494 & VALLEY CREEK RD | WOODBURY, MN

## CONTACT

MOLLY TOWNSEND | 612.359.1693

molly.townsend@transwestern.com

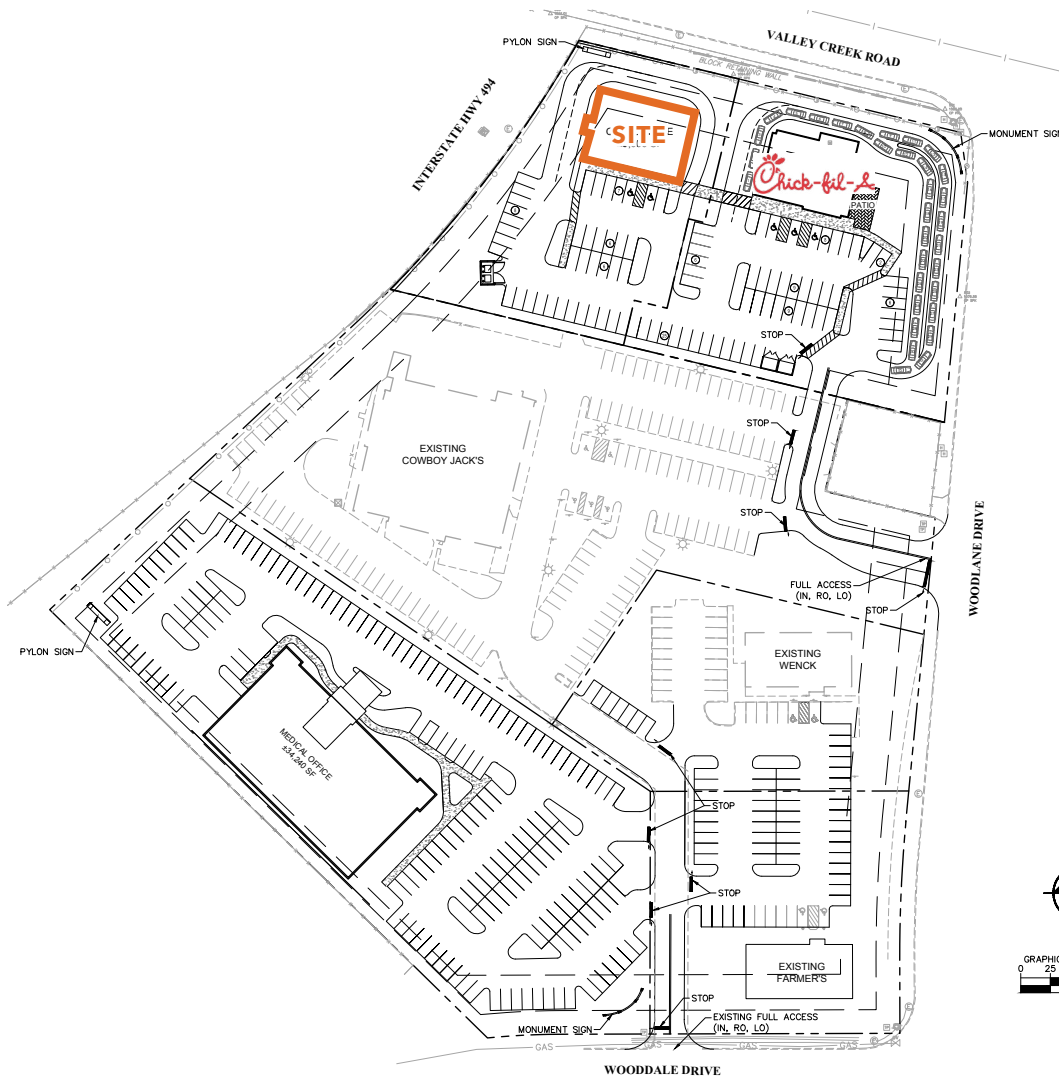

OVERALL BUILDING/SITE DATA TABLE

	LOT AREA	BUILDING	PARKING PROVIDED	PARKING RATIO (PROVIDED)	PARKING REQUIRED	ADA STALLS REQ'D/PROVIDED
REST.	1.27 AC.	± 4,860 SQ. FT.	54 SPACES	11.1	54 SPACES	3 STALLS/3 STALLS
QSR/ COFFEE	0.97 AC.	± 5,000 SQ. FT.	39 SPACES	7.8	—	2 STALLS/2 STALLS
**MED OFFICE	2.63 AC	± 34,240 SQ. FT.	170 SPACES	5.0	172 SPACES	6 STALLS/6 STALLS
**WENCK	1.00 AC	± 8,300 SQ. FT.	44 SPACES	5.3	42 SPACES	2 STALLS/2 STALLS
**FARMERS	1.00 AC	± 8,300 SQ. FT.	43 SPACES	5.2	42 SPACES	2 STALLS/2 STALLS

\*CITY OF WOODBURY MINIMUM REQUIRED PARKING RATIOS:  
 OFFICE - 1 SPACE / 200 SF  
 RESTAURANT - 1 1/2 SEATS + EMPLOYEE PARKING  
 \*\*IT IS ASSUMED THAT A SHARED PARKING AGREEMENT WILL BE COMPLETED TO SATISFY THE CITY'S MINIMUM PARKING REQUIREMENT BETWEEN THESE PARCELS

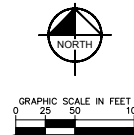



## SITE PLAN

# VALLEY CREEK COMMONS

SEQ I-494 & VALLEY CREEK RD | WOODBURY, MN

## CONTACT

MOLLY TOWNSEND | 612.359.1693

molly.townsend@transwestern.com

