

# Rainbow Robindale Plaza

7795 S Rainbow Blvd, Las Vegas NV 89139  
South of SEC of Rainbow Blvd & Robindale Rd



**FOR LEASE**

**Approx. 1,712 SF Available**



## DELIVERY 2Q 2020

- Excellent visibility. Frontage along South Rainbow Blvd
- Located in the desirable rapidly expanding Southwest market
- Great small user opportunity
- Easy access to I-215 and Blue Diamond Rd
- Zoned C-1 (Local Business)



### LEASING CONTACT

**JIM HILL**

702.550.4917 | jim@roicre.com  
NV Lic# S.0173080

**TODD BOYER**

702.550.4923 | todd@roicre.com  
NV Lic# S.0024286

9121 W Russell Rd Suite 111  
Las Vegas, NV 89148  
(P) 702.363.3100 (F) 702.363.0450  
roicre.com

# Rainbow Robindale Plaza

7795 S Rainbow Blvd, Las Vegas NV 89139  
 South of SEC of Rainbow Blvd & Robindale Rd



## LEASING CONTACT

**JIM HILL**

702.550.4917 | jim@roicre.com  
 NV Lic# S.0173080

**TODD BOYER**

702.550.4923 | todd@roicre.com  
 NV Lic# S.0024286

9121 W Russell Rd Suite 111  
 Las Vegas, NV 89148  
 (P) 702.363.3100 (F) 702.363.0450  
 roicre.com

# Rainbow Robindale Plaza

7795 S Rainbow Blvd, Las Vegas NV 89139  
South of SEC of Rainbow Blvd & Robindale Rd

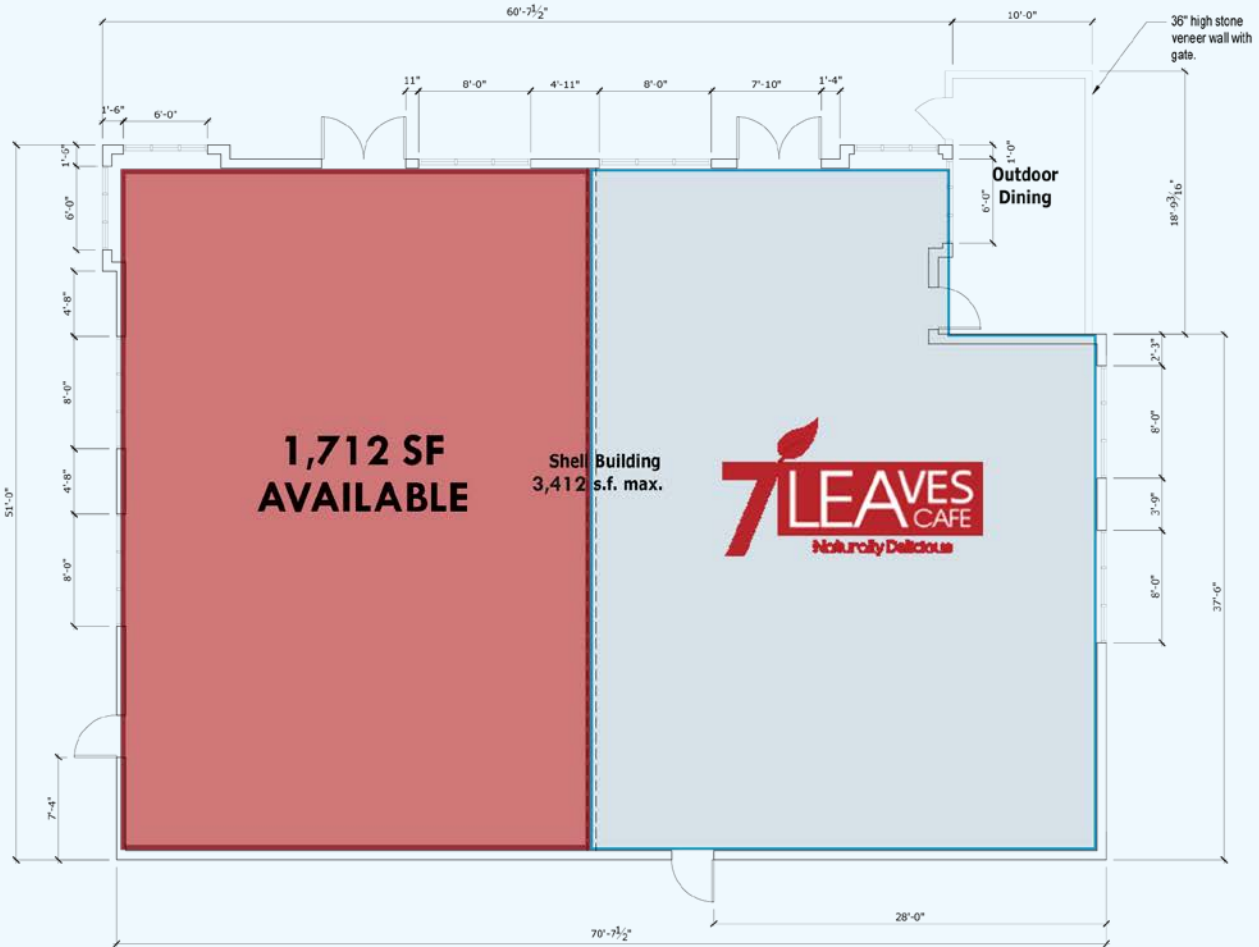

Floor Plan  
1/4" = 1'-0"  
North

## LEASING CONTACT

**JIM HILL**  
702.550.4917 | jim@roicre.com  
NV Lic# S.0173080

**TODD BOYER**  
702.550.4923 | todd@roicre.com  
NV Lic# S.0024286

9121 W Russell Rd Suite 111  
Las Vegas, NV 89148  
(P) 702.363.3100 (F) 702.363.0450  
roicre.com

# Rainbow Robindale Plaza

7795 S Rainbow Blvd, Las Vegas NV 89139  
South of SEC of Rainbow Blvd & Robindale Rd

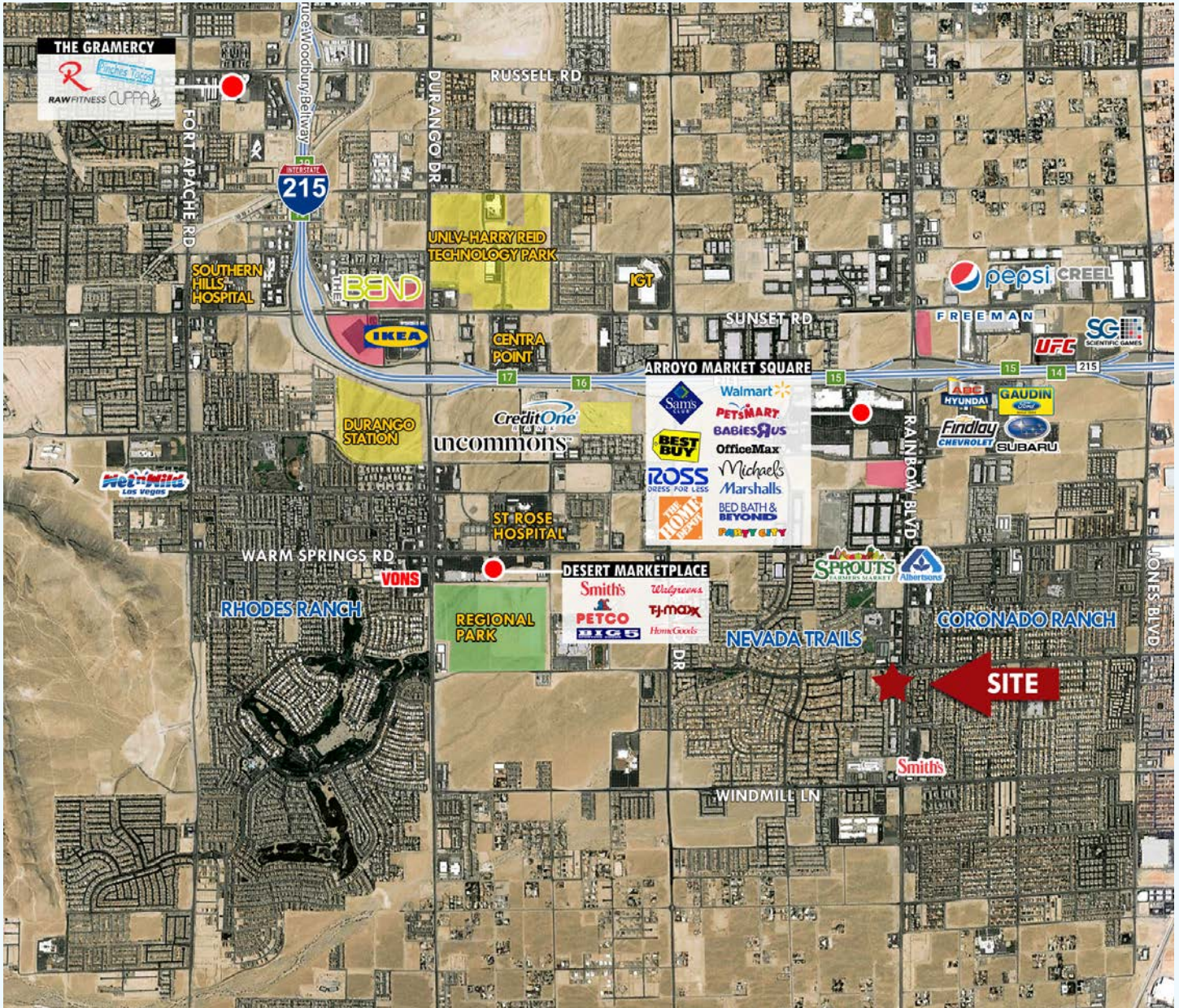

## LEASING CONTACT

**JIM HILL**

702.550.4917 | jim@roicre.com  
NV Lic# S.0173080

**TODD BOYER**

702.550.4923 | todd@roicre.com  
NV Lic# S.0024286

9121 W Russell Rd Suite 111  
Las Vegas, NV 89148  
(P) 702.363.3100 (F) 702.363.0450  
roicre.com