

St. Johns Square Space for Lease

NAI Black

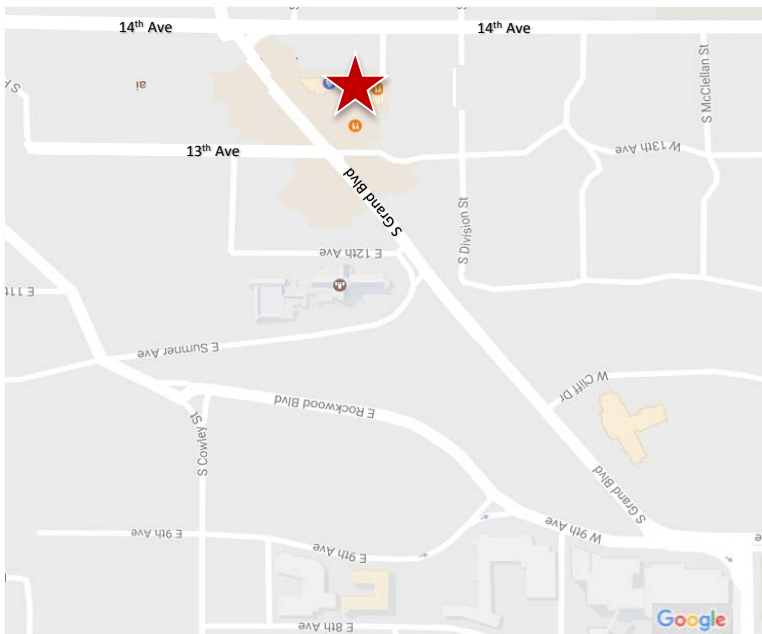

1314 S. Grand Blvd Spokane, WA 99202

Property Features

- Great South Hill Exposure
- Space Available:
 - Unit #4: 1,200 SF **
 - Lease Rate: \$17.00/SF NNN
- Grand Blvd Traffic: 19,934 ADT **
- Businesses Nearby Include:
Papa Murphy's, Lindaman's Bistro,
AAA Cruise & Travel, Allie's Vegan Pizzeria &
Café, 7-Eleven, Verizon, & Baskin-Robbins.

Chris Bell, SIOR
+1 509 622 3538
cbell@naiblack.com

James Black III, CCIM
+1 509 622 3551
jblack@naiblack.com

NO WARRANTY OR REPRESENTATION, EXPRESS OR IMPLIED, IS MADE AS TO THE ACCURACY OF THE INFORMATION CONTAINED HEREIN, AND THE SAME IS SUBMITTED SUBJECT TO ERRORS, OMISSIONS, CHANGE OF PRICE, RENTAL OR OTHER CONDITIONS, PRIOR SALE, LEASE OR FINANCING, OR WITHDRAWAL WITHOUT NOTICE, AND OF ANY SPECIAL LISTING CONDITIONS IMPOSED BY OUR PRINCIPALS NO WARRANTIES OR REPRESENTATIONS ARE MADE AS TO THE CONDITION OF THE PROPERTY OR ANY HAZARDS CONTAINED THEREIN OR ANY TO BE IMPLIED.

Black Commercial, Inc.
801 W Riverside, Suite 300
Spokane, WA 99201
+1 509 623 1000
naiblack.com

St. Johns Square
For Lease

Site Plan

14th Avenue

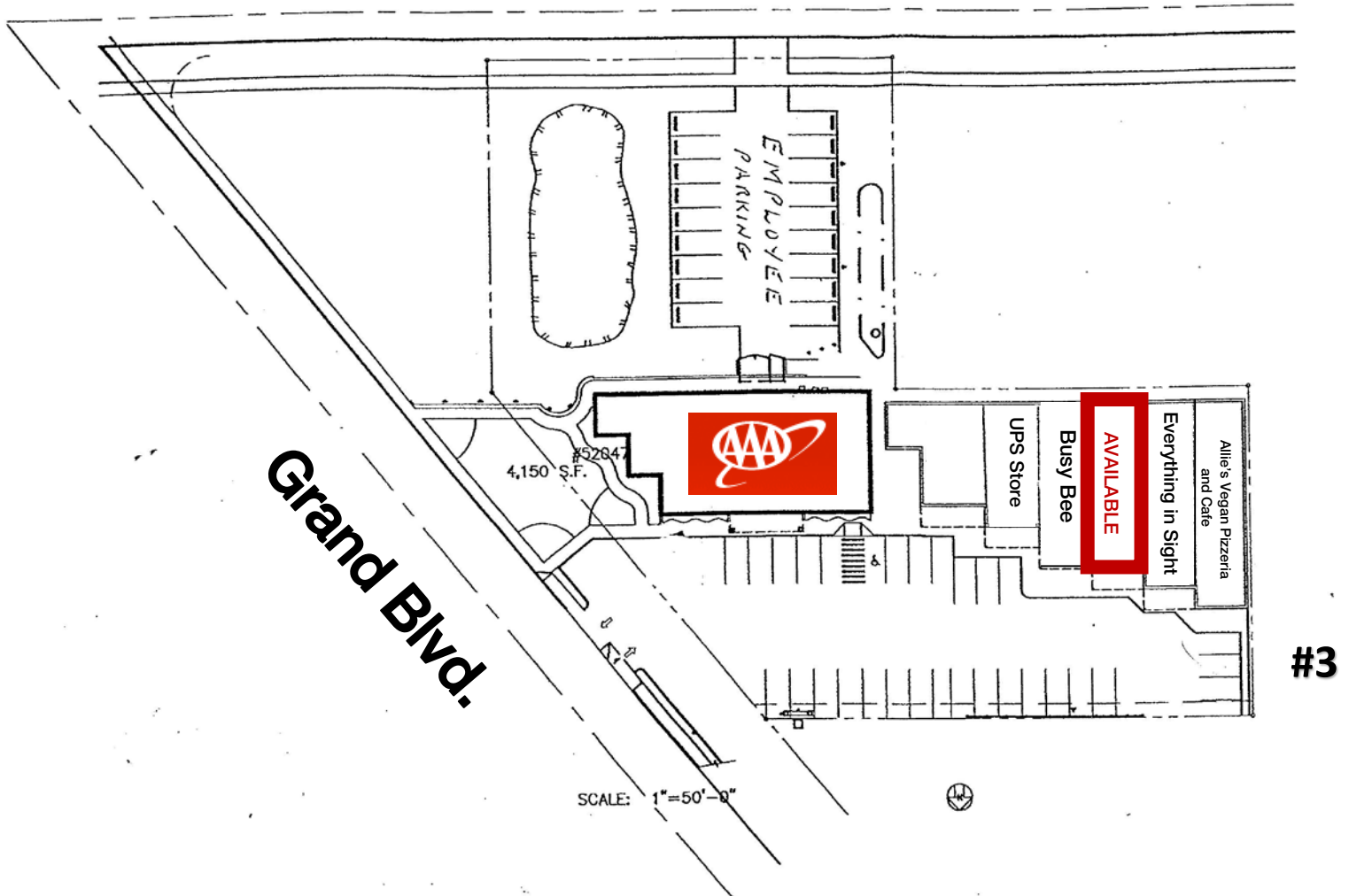

Demographics:

Population:

3 Mile Radius: 98,791

5 Mile Radius: 187,926

No. of Households:

3 Mile Radius: 42,878

5 Mile Radius: 79,322

Average Family Income:

3 Mile Radius: \$55,722

5 Mile Radius: \$56,573

NAI Black respects the intellectual property rights of others. If you believe that your intellectual property rights have been violated by NAI Black or by a third party who has uploaded Content on our Site, please provide the following information to the NAI Black designated copyright agent as addressed below: a. A description of the copyrighted work or other intellectual property that you claim has been infringed; b. A specific description of where the material that you claim is infringing is located on the Site so the agent is able to locate it; c. An address, telephone number, and e-mail address where NAI Black can contact you and, if different, an e-mail address where the alleged infringing party, if not NAI Black, can contact you; d. An assigned statement by you under penalty of perjury that the information in your notice is accurate and that you are the copyright or intellectual property owner or are authorized to act on the owner's behalf; After reviewing the complaint and determining if the complaint is valid, NAI Black will work to quickly remove the infringing material or disable access to it. Note: There are substantial penalties for false claims. NAI Black may request additional information before removing any infringing material. NAI Black may provide the alleged infringing party with your e-mail address so that that person can respond to your allegations. NAI Black has registered a designated agent with the Copyright Office pursuant to 17 U.S.C. 512(c). If you believe your copyright material is being used on this Site without permission, please notify the designated agent as follows:

By e-mail: MaryL@commercialmls.com | Subject Line: Copyright Concern

By mail: Commercial Brokers Association | Attn: DMCA Designated Agent | 12131 113th Ave NE Suite 101 | Kirkland, WA 98034

If e-mailing your copyright infringement notice, then NAI Black must receive the signed statement(s) mentioned above by mail, or attached to the e-mail, before we are required to take action.