



# EXCLUSIVE LISTING MULTI-SPORTS FACILITY FOR SALE OR LEASE

(856) 985-9522 • ROSECOMMERCIAL.COM

## 14 FEDERAL STREET, MOUNT LAUREL, NJ



### Property Description:

Multi-use sports facility for sale or lease

**Size:**

40,000 +/- SF Total

**Available:**

13,118 +/- SF

**Taxes:**

\$34,354.89 (2019)

**Lease Rate:**

\$7.00/ SF NNN

**Sale Price:**

\$3,495,000.00

**Details:**

- Income producing investment
- 32' clear height building
- Includes two basketball courts
- Minimum columns throughout
- Directly adjacent to Route 295 with highly visible backlit signage
- Join Warrior Gyms

**Adam Rose (Ext. 22)**

[arose@rosecommercial.com](mailto:arose@rosecommercial.com)

(856) 985-9522

**Jeffrey Lucas (Ext. 32)**

[jeffreylucas@me.com](mailto:jeffreylucas@me.com)

(856) 985-9522

Rose Commercial Real Estate is a full service commercial real estate firm, specializing in all facets of the industry ~ representing buyers and sellers, landlords and tenants as well as investors both big and small. Key to our growth is experience combined with in depth understanding of the South Jersey real estate market. But that alone is only a part of the comprehensive service we provide clients. With our unique **CIRCLES FOR SUCCESS** and start-to-finish commitment, we make things happen.



# EXCLUSIVE LISTING MULTI-SPORTS FACILITY FOR SALE OR LEASE

(856) 985-9522 • ROSECOMMERCIAL.COM

## 14 FEDERAL STREET, MOUNT LAUREL, NJ

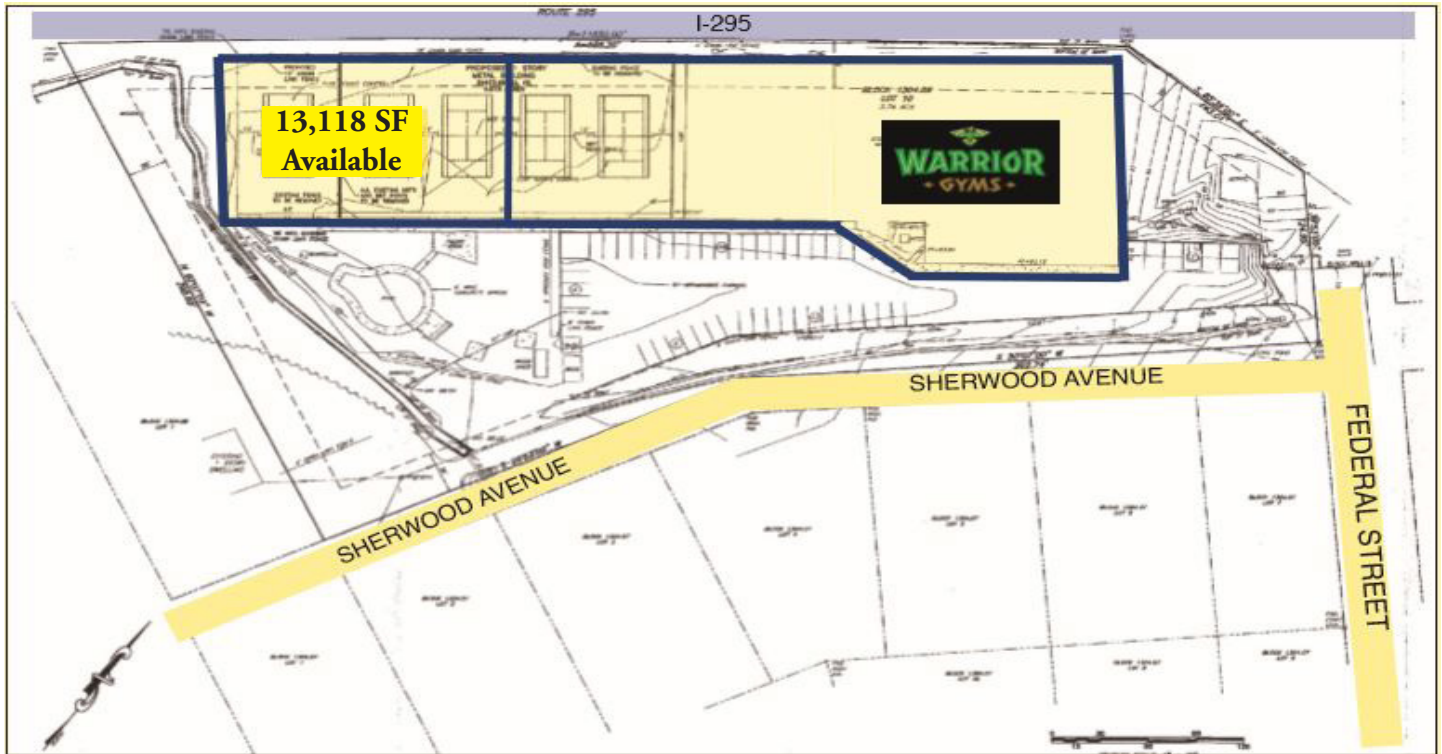

Rose Commercial Real Estate is a full service commercial real estate firm, specializing in all facets of the industry ~ representing buyers and sellers, landlords and tenants as well as investors both big and small. Key to our growth is experience combined with in depth understanding of the South Jersey real estate market. But that alone is only a part of the comprehensive service we provide clients. With our unique **CIRCLES FOR SUCCESS** and start-to-finish commitment, we make things happen.