

# BUILDING FOR SALE

## 96 RICKENBACKER CIRCLE, LIVERMORE



### FEATURES

#### 5,266± SF Office/Warehouse

- .34± acre site
- Corner lot location in West Livermore

#### OFFICE

- **High end interior finishes:**
  - 6 large private offices
  - Conference room with built in cabinets
  - Full kitchen area with top of the line appliances
  - Two interior restrooms / one warehouse restroom

#### WAREHOUSE

- 1,700± SF insulated warehouse with roll up truck door
- 400 amp 120/280v electrical service

**Price: \$1,212,000**

### AREA MAP



#### BRETT HOLDEN

LIC. ID# 00883982

BHOLDEN@LEE-ASSOCIATES.COM

925-737-4141



The information contained herein is based on estimates and assumptions and is presented for illustration purposes only. No representations, warranties or guarantees of any kind are made.

# BUILDING FOR SALE

## 96 RICKENBACKER CIRCLE, LIVERMORE

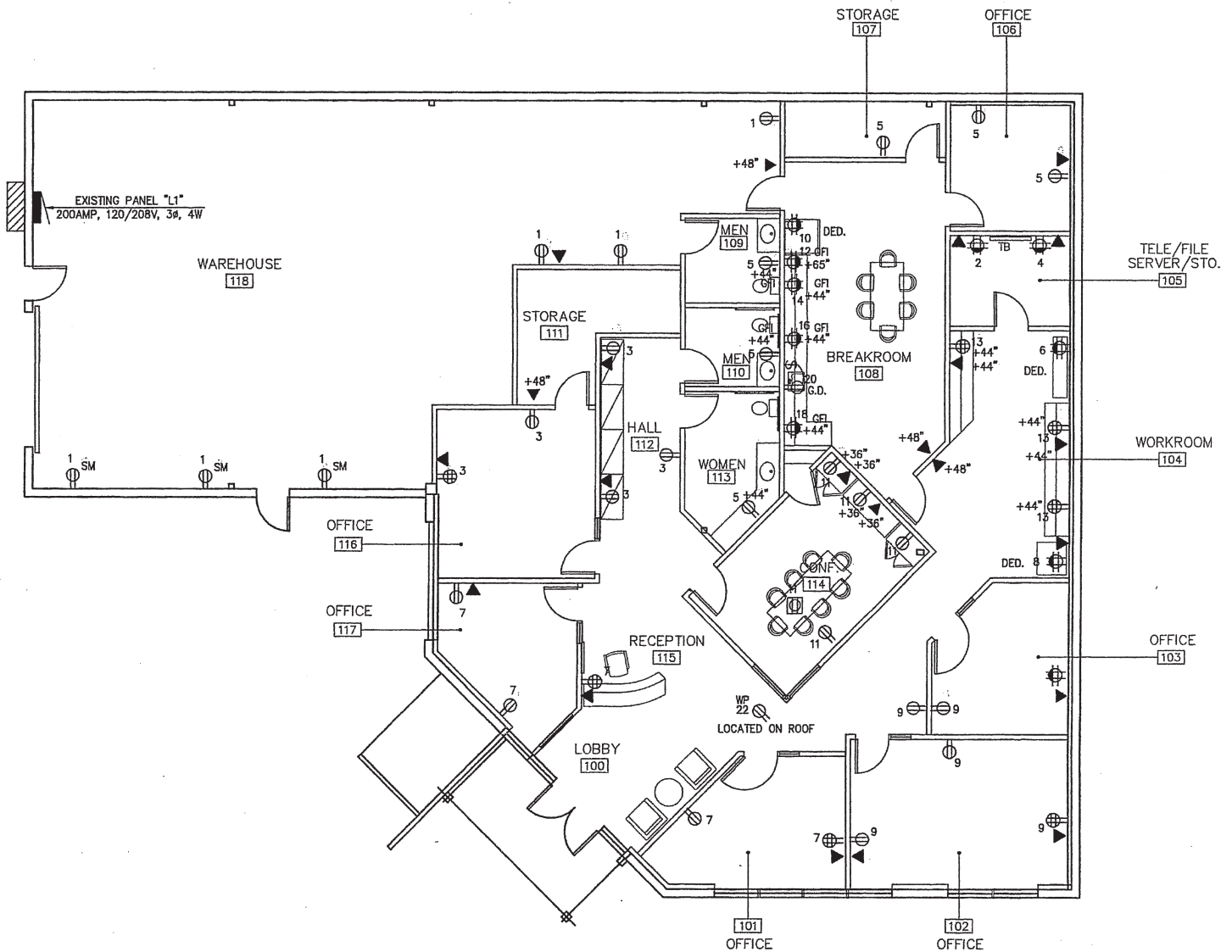

**BRETT HOLDEN**

LIC. ID# 00883982

BHOLDEN@LEE-ASSOCIATES.COM

925-737-4141



The information contained herein is based on estimates and assumptions and is presented for illustration purposes only.  
No representations, warranties or guarantees of any kind are made.