

For Sale or Lease

680 Industrial Drive

Cary, Illinois

MIDWEST
INDUSTRIAL FUNDS
REAL ESTATE INVESTMENT & DEVELOPMENT

79,048 SF Building | 14,575 - 54,199 Available



Building Specifications:

Total Building Size:	±79,048 SF (footprint) on 2.9 Acres
Clear Height:	18' Clear
Office:	6,814 SF on 1st Floor (additional 4,800 SF on 2nd floor)
Loading:	6 Interior Docks; 2 Drive-in Doors
Fire Suppression:	Fully Sprinklered
Electrical:	2,000 Amps @ 480 Volts; 3-Phase
Parking:	100 Cars
Available Space:	<ul style="list-style-type: none">• 14,575 - 54,199 SF• 4,800 SF Office on 1st Floor (and 4,800 SF office on 2nd floor not included in available SF but available to lease)• 3 Interior Docks; 2 Drive-in Doors• 38' x 37'11" Bay Size• Power to Suit
Lease Rate:	\$5.95 PSF Gross (including current taxes & CAM) & \$50,000 Office Allowance
Sale Price:	\$3,625,000 (\$45.85 PSF)
Comments:	<ul style="list-style-type: none">• Fantastic User/Investor Opportunity• New Roof, Renovated Warehouse & Office to Suit• Professionally Owned and Managed by Midwest Industrial Funds

For More Information Contact:

Dan Jones, SIOR
Email: djones@entreccommercial.com
Direct: 847-310-4299

Dan Benassi, SIOR
Email: dbenassi@entreccommercial.com
Direct: 847-310-4298

Mike DeSerto
Email: mdeserto@entreccommercial.com
Direct: 224-588-3026

ENTRE
Commercial Realty LLC

Midwest Industrial Funds | 1301 W. 22nd Street, Suite 711, Oak Brook, IL 60523 | www.midwestindustrialfunds.com

No warranty or representation, expressed or implied, is made as to the accuracy of the information contained herein, and same is submitted subject to error and omission.

For Sale or Lease

680 Industrial Drive

Cary, Illinois

MIDWEST
INDUSTRIAL FUNDS
REAL ESTATE INVESTMENT & DEVELOPMENT

Floor Plan and Photos

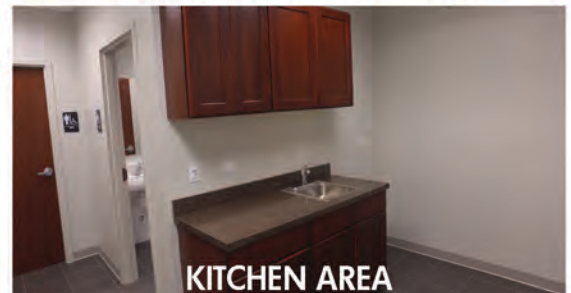
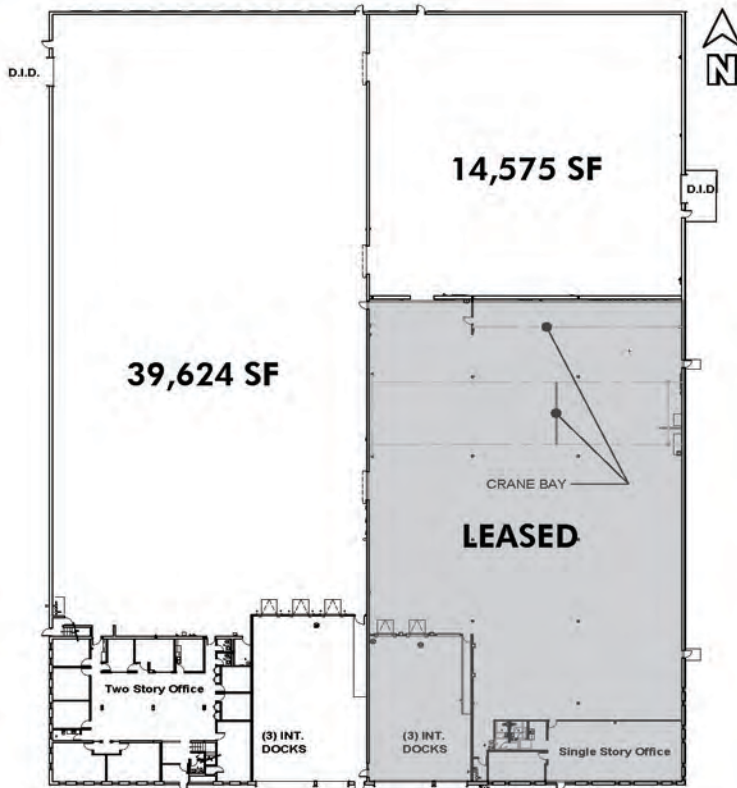

For More Information Contact:

Dan Jones, SIOR
Email: djones@entrecommercial.com
Direct: 847-310-4299

Dan Benassi, SIOR
Email: dbenassi@entrecommercial.com
Direct: 847-310-4298

Mike DeSerto
Email: mdeserto@entrecommercial.com
Direct: 224-588-3026

ENTRE
Commercial Realty LLC

Midwest Industrial Funds | 1301 W. 22nd Street, Suite 711, Oak Brook, IL 60523 | www.midwestindustrialfunds.com

No warranty or representation, expressed or implied, is made as to the accuracy of the information contained herein, and same is submitted subject to error and omission.