

Aerial



Contact

Caryl Brown
503.721.2725
cbrown@kiddermathews.com

This information supplied herein is from sources we deem reliable. It is provided without any representation, warranty or guarantee, expressed or implied as to its accuracy. Prospective Buyer or Tenant should conduct an independent investigation and verification of all matters deemed to be material, including, but not limited to, statements of income and expenses. Consult your attorney, accountant, or other professional advisor.

Heart of the Pearl

914 NW Everett Street
Portland, OR



Retail-showroom-restaurant
±5,400 SF is \$26.50/SF NNN
.....
Plus outdoor pocket park ±2,400
SF is \$12.00/SF NNN
.....
NNN's ±\$4.00 SF
.....
Zoned EXD
.....
Rare one level Pearl District
Building with open floor plan
.....
Built in 1917
.....
Classic brick and timber
construction with exposed
beam ceiling with Skylights
.....

Location

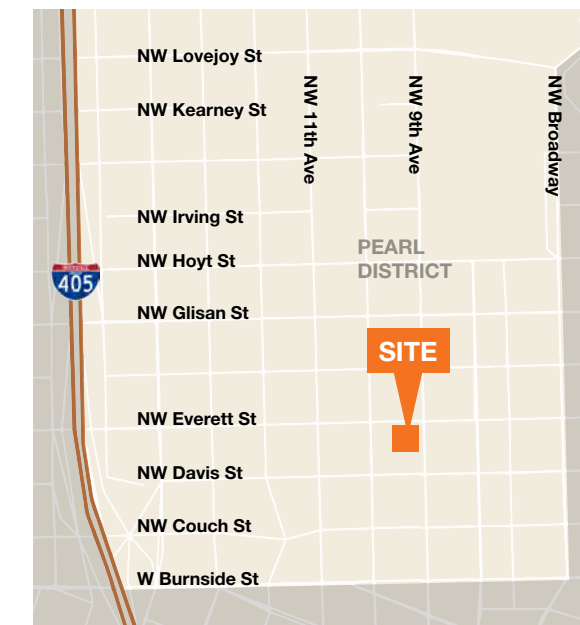

Contact

Caryl Brown
503.721.2725
cbrown@kiddermathews.com

Site Plan

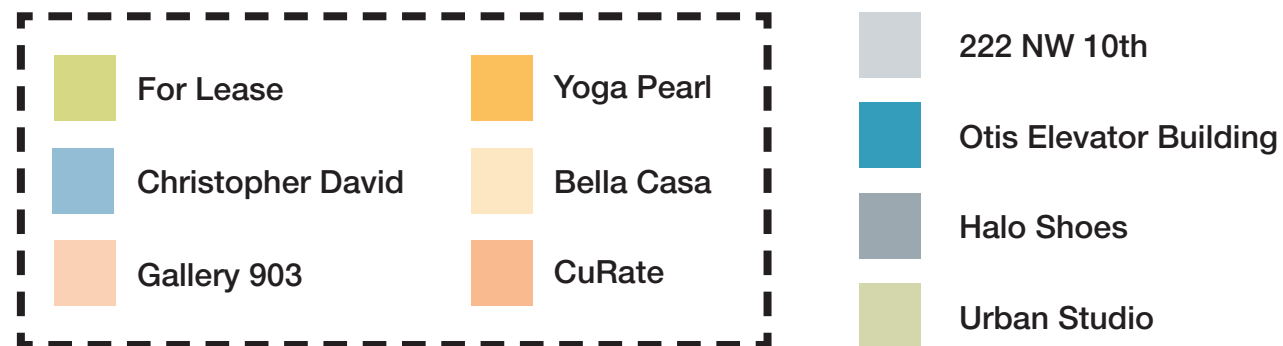
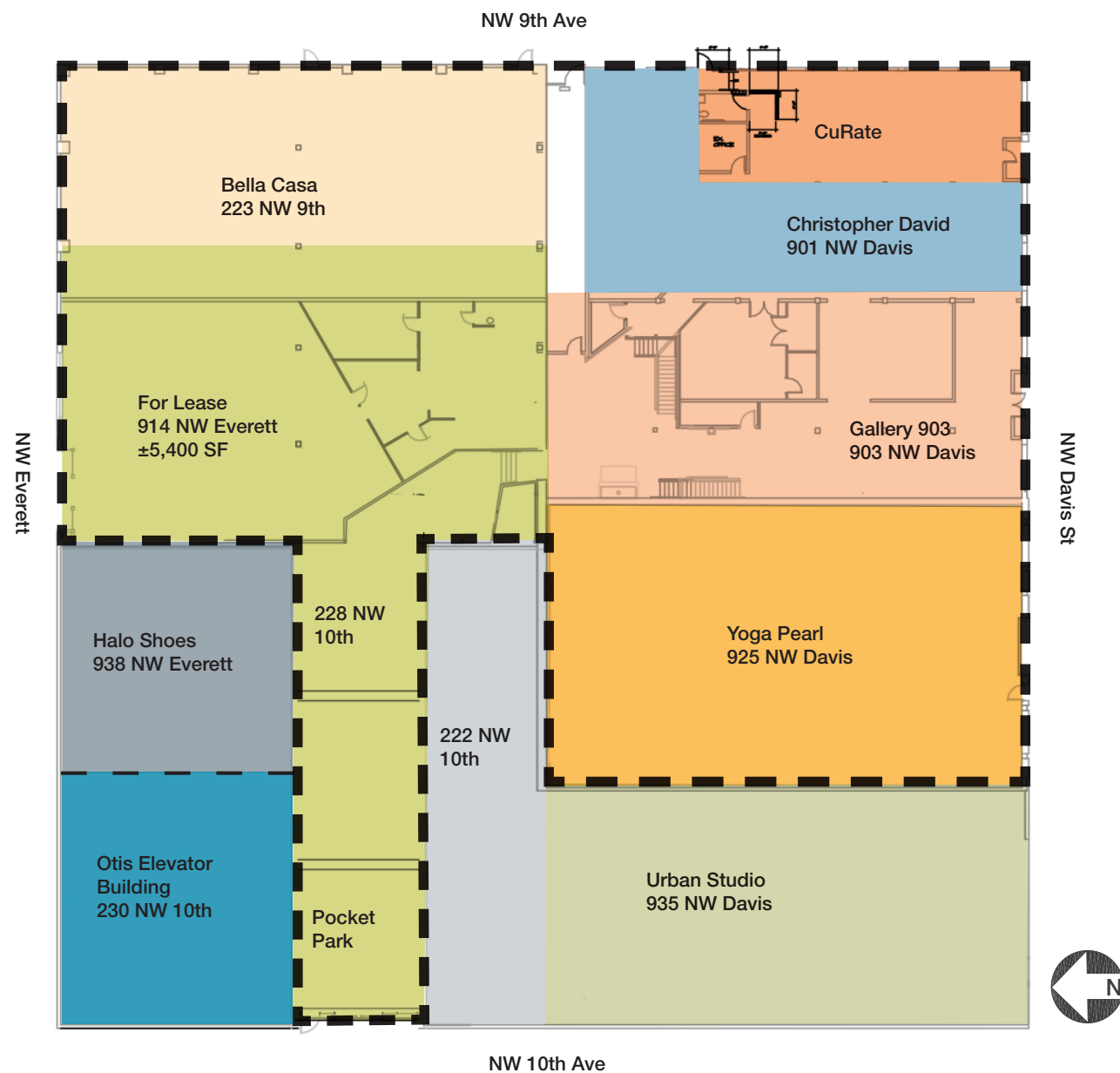

Premises

New HVAC to be combined with existing units

600 AMP, 3 phase power

In ground plumbing, to suit Tenant

Two 75 gallon grease traps

2 ADA and 1 GN ADA restroom in common exit

New concrete floor

Fully sprinklered and seismic completed 2016

Building permit in hand for restaurant/night club

Construction

