



# BRIDGE POINT WOODRIDGE TWO

1020 DAVEY ROAD  
WOODRIDGE, ILLINOIS



### Building Specifications:

<b>Site Area:</b>	7.002 acres	› Immediate access to I-55/I-355 via full interchange at Lemont Road and Joliet Road
<b>Total Building:</b>	119,122 SF	› Excellent ingress/egress via new signalized traffic light at Lemont and Davey Roads
<b>Available:</b>	55,946 SF	› Low DuPage County taxes
	<ul style="list-style-type: none"> <li>▪ 17,193 SF</li> <li>- 2 exterior docks (expandable)</li> <li>- 1 drive-in door</li> </ul>	› 30' clear height
	<ul style="list-style-type: none"> <li>▪ 38,753 SF (divisible)</li> <li>- 2 exterior docks (expandable)</li> <li>- 2 drive-in doors</li> </ul>	› 40' x 50' bay spacing
<b>Office:</b>	To Suit	› ESFR sprinkler system
		› Fully-adhered "white" roof system
		› High image, new construction

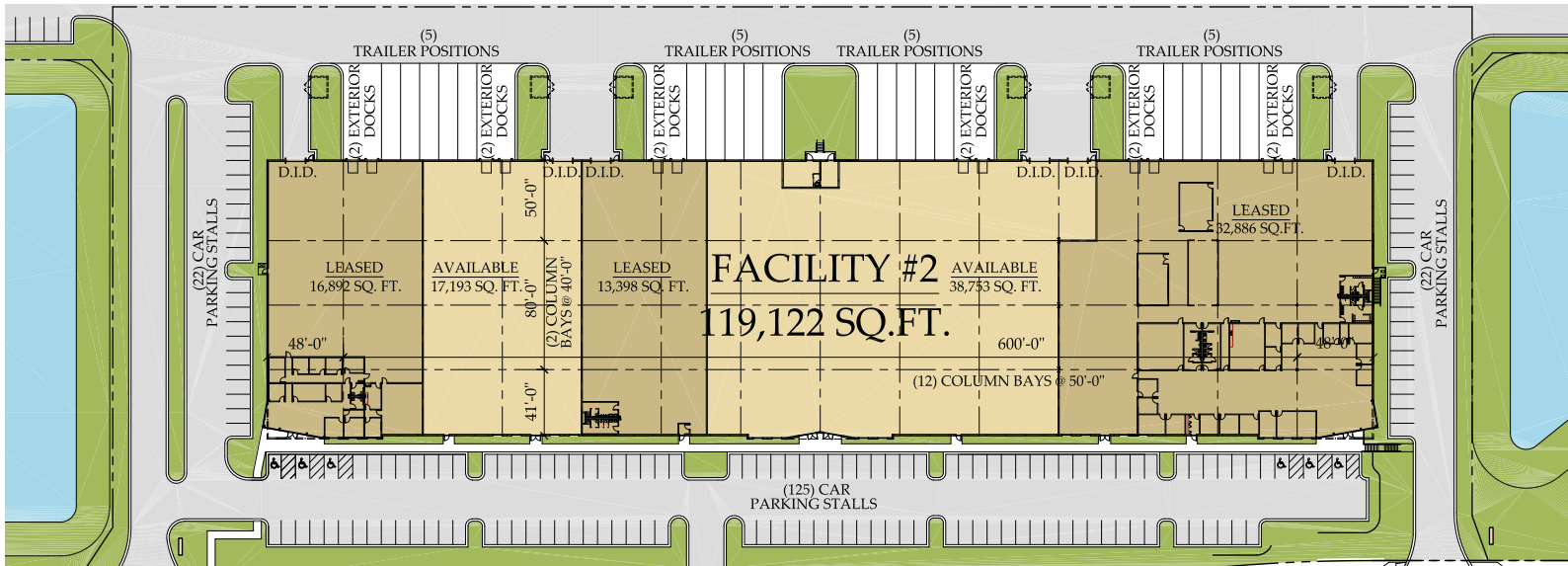

**Lee & Associates®**  
 COMMERCIAL REAL ESTATE SERVICES  
 8755 West Higgins Road  
 Suite 1000  
 Chicago, Illinois 60631  
 Main | (773) 355-3000  
 Fax | (773) 693-9921  
 www.lee-associates.com

For more information:

**JEFFREY A. GALANTE**  
 PRINCIPAL  
 (773) 355-3007 direct  
 jgalante@lee-associates.com

**BRIAN C. VANOSKY**  
 PRINCIPAL  
 (773) 355-3023 direct  
 bvanosky@lee-associates.com

Developed by:



In partnership with:



GLOBE CORPORATION



# BRIDGE POINT WOODRIDGE TWO

1020 DAVEY ROAD  
WOODRIDGE, ILLINOIS



**Lee & Associates®**  
COMMERCIAL REAL ESTATE SERVICES  
8755 West Higgins Road  
Suite 1000  
Chicago, Illinois 60631  
Main | (773) 355-3000  
Fax | (773) 693-9921  
www.lee-associates.com

For more information:

**JEFFREY A. GALANTE**  
PRINCIPAL  
(773) 355-3007 direct  
jgalante@lee-associates.com

**BRIAN C. VANOSKY**  
PRINCIPAL  
(773) 355-3023 direct  
bvanosky@lee-associates.com

Developed by:



In partnership with:



GLOBE CORPORATION

No warranty or representation is made as to the accuracy of the foregoing information. Terms of sale or lease and availability are subject to change or withdrawal without notice.