

WELCOME TO
FINLEY POINT



ADAM SHOWWALTER

312 819 4140

adam.showalter@cushwake.com

DANIEL SVACHULA

847 518 3256

daniel.svachula@cushwake.com



**CUSHMAN &
WAKEFIELD**



3333 FINLEY ROAD
DOWNERS GROVE, IL



WELCOME TO FINLEY POINT

Unavailable to the market for over 15 years, Finley Point is a premier Class A office property located in the epicenter of suburban Chicago's East West Corridor.

Designed to meet the standards of the most discerning office tenants, Finley Point offers tenants high-end finishes, spectacular views of downtown Chicago and an expansive amenity package rarely (if ever) found in a suburban property.





AN EXPANSIVE AMENITY PACKAGE



NOT YOUR TYPICAL SUBURBAN OFFICE AMENITIES

Renovations are underway to over 20,000 sf of amenity space including a 6,000 sf fitness center, conference center, full service cafeteria, 24-hour tenant lounge, and 5,000 sf outdoor patio.



AN EXPANSIVE AMENITY PACKAGE



1,500 SF PRIVATE OUTDOOR PATIO



5,000 SF OUTDOOR PATIO



AN EXPANSIVE AMENITY PACKAGE

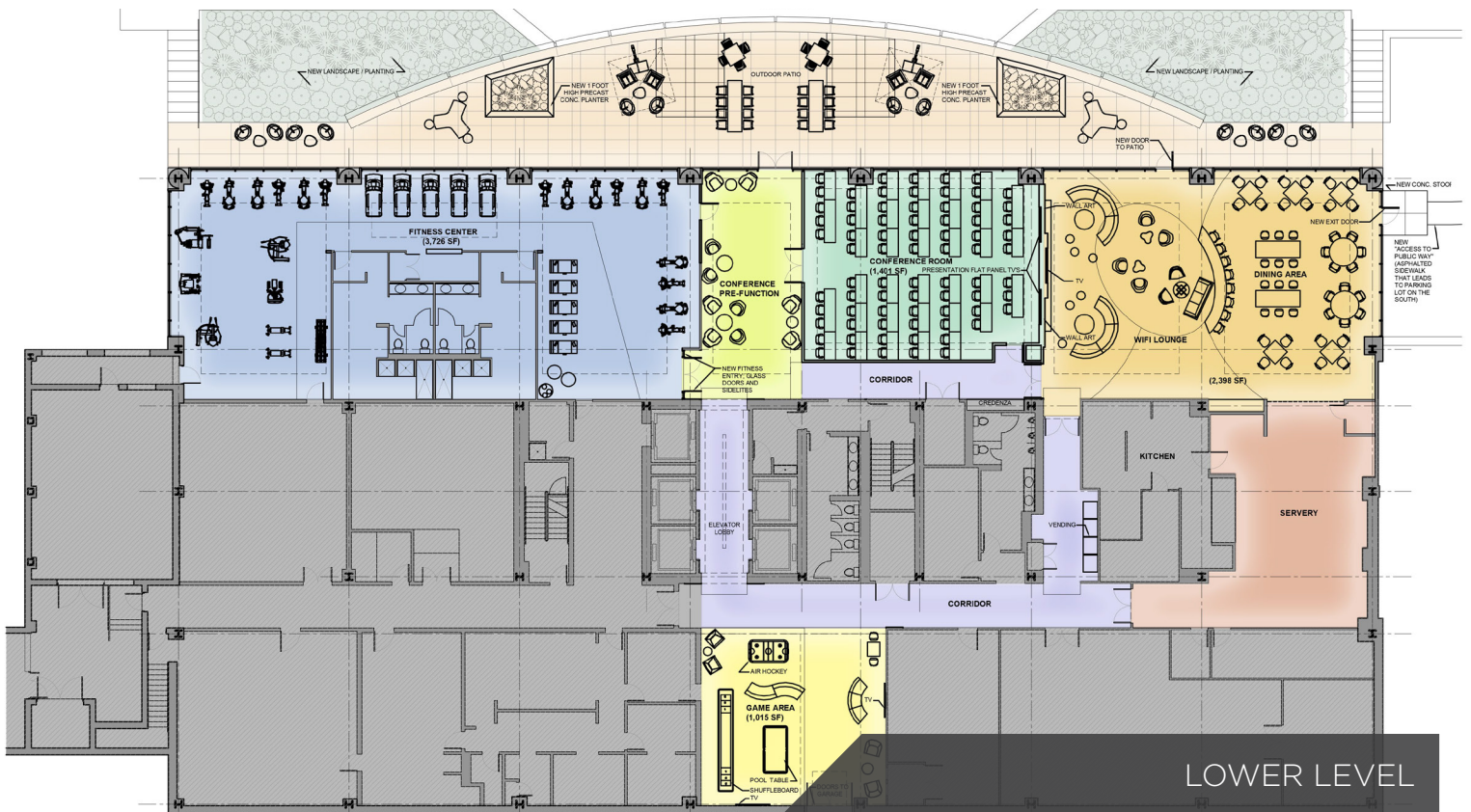

LOWER LEVEL



SUBURBAN CONVENIENCE

- 1 CHAMA GAÚCHA BRAZILIAN STEAKHOUSE
- 2 BRICK HOUSE TAVERN + TAP
- 3 CARLUCCI RESTAURANT
- 4 ROCKWOOD TAP HOUSE
- 5 PORTILLO'S HOT DOGS
- 6 OLIVE GARDEN
- 7 BENIHANA
- 8 BARBAKOA
- 9 UNCLE JULIO'S FINE MEXICAN
- 10 WEBER GRILL RESTAURANT



CRAFTED CONVENIENCE

- Located at the epicenter of the East West Corridor
- Adjacent to the I-88/I-355 interchange
- Outstanding signage opportunity, visible to 160,000+ cars on a daily basis
- Abundant retail and restaurant accessibility

