

THE CHILDREN'S HOSPITAL OF PHILADELPHIA

27TH & SCHUYLKILL AVENUE & SOUTH STREET

PHILADELPHIA, PA

±6,500 SF AVAILABLE FOR LEASE



property highlights.

- One of a kind retail/restaurant opportunity on the ground floor on The Children's Hospital of Philadelphia's newest research center – Roberts Center for Pediatric Research
- Located in the booming Graduate Hospital neighborhood
- Great visibility and easy access from highly trafficked South Street Bridge
- Approximately 2,000 employees in the 466,314 SF building



The Children's Hospital
of Philadelphia®



METRO®
COMMERCIAL
REAL ESTATE, INC.

MetroCommercial.com | PHILADELPHIA, PA | PLYMOUTH MEETING, PA | MOUNT LAUREL, NJ | NAPLES, FL

get in touch.

IRYNA IRYK

office 215.893.0300
direct 215.282.0156
iiryk@metrocommercial.com

MICHAEL GORMAN

office 215.893.0300
direct 215.282.0152
mgorman@metrocommercial.com

SOUTH STREET 20,986 VPD

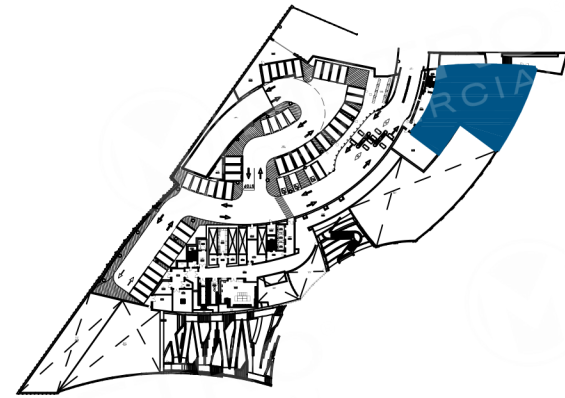
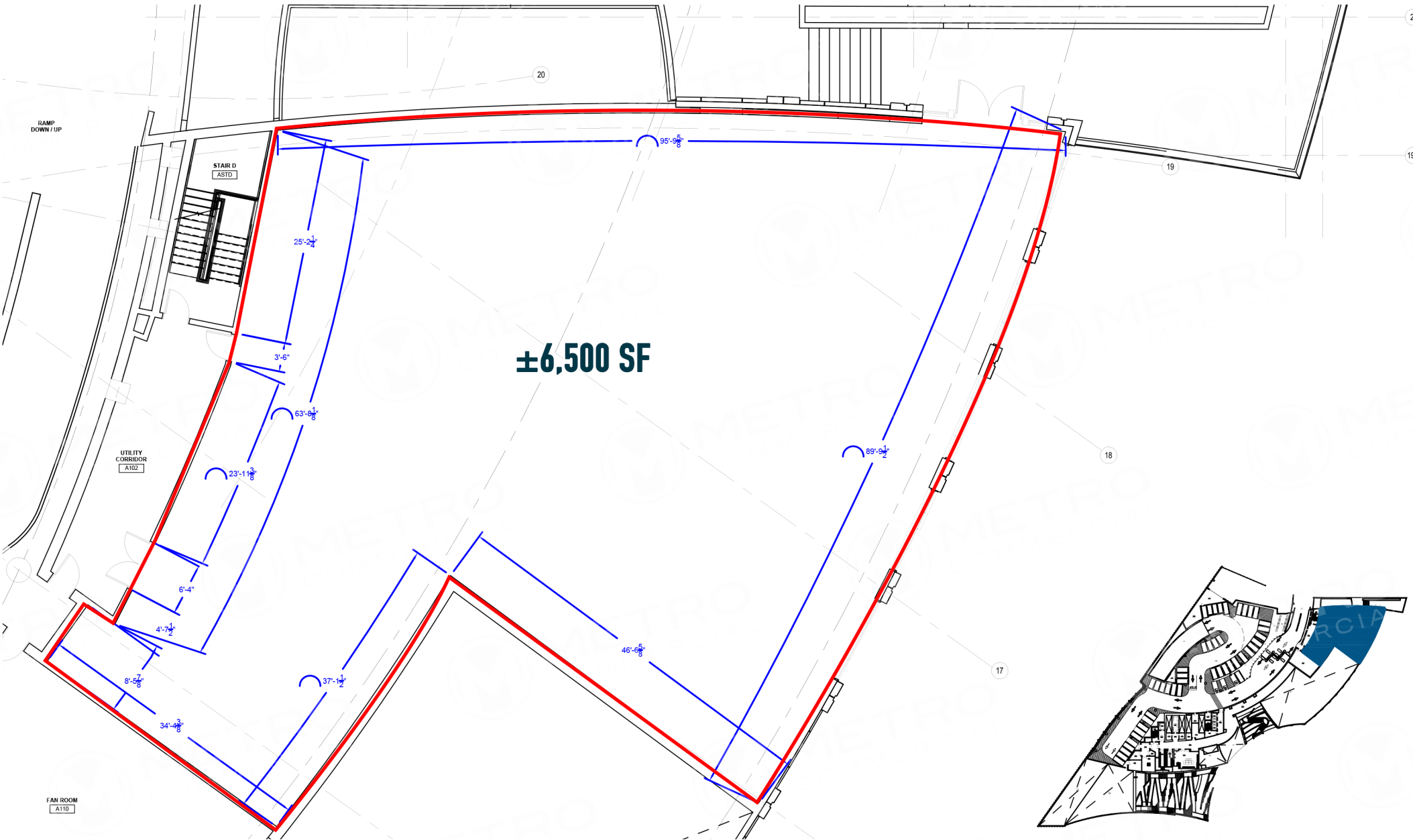

The information and images contained herein are from sources deemed reliable. However, Metro Commercial Real Estate, Inc. makes no representation whatsoever as to their accuracy or authenticity. Images shown may be modified for illustrative purposes. Images may be out-of-date and not current. 1.21.20

**27TH & SCHUYLKILL AVENUE & SOUTH STREET
PHILADELPHIA, PA**



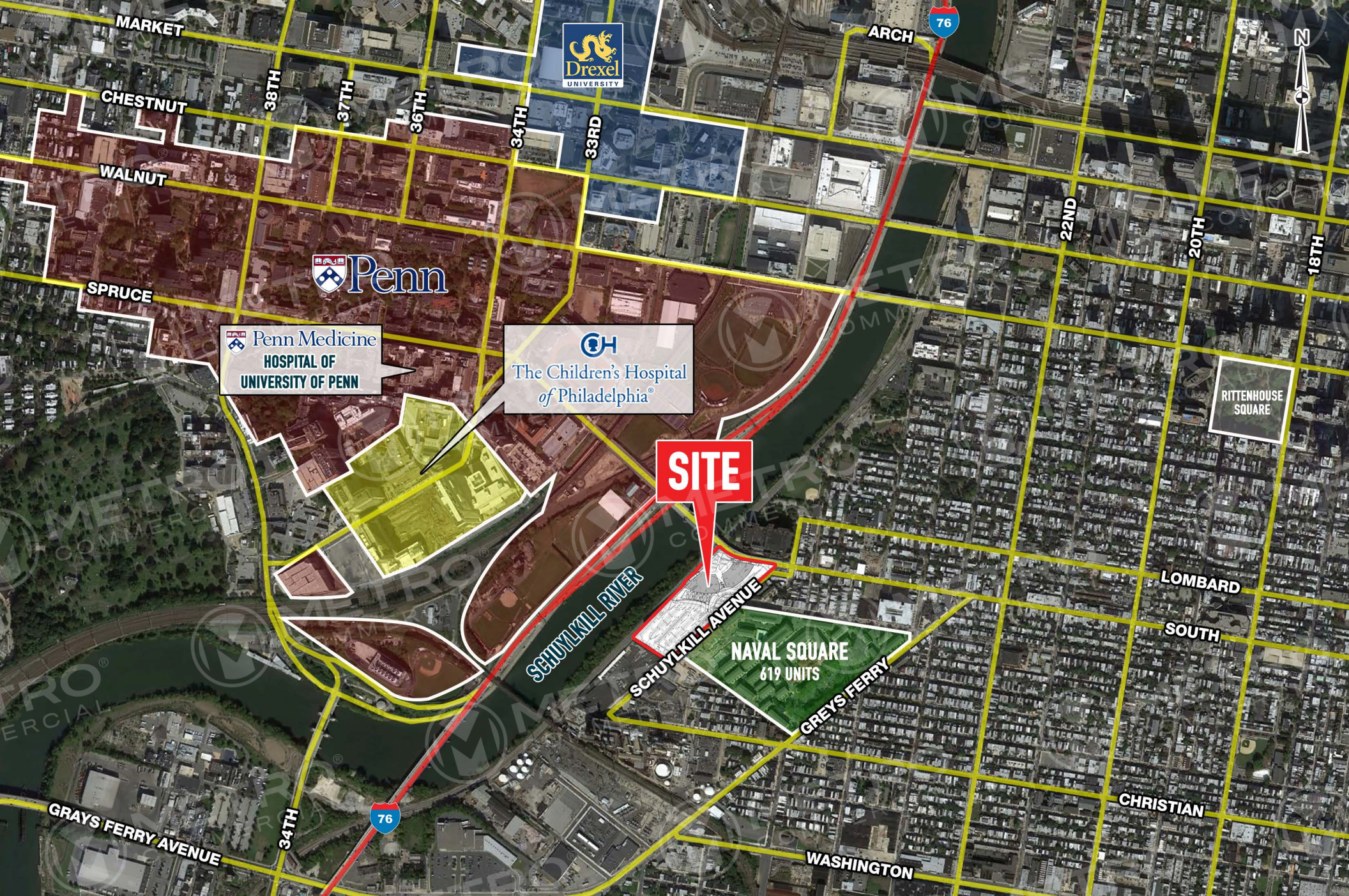

 Penn Medicine
HOSPITAL OF
UNIVERSITY OF PENN

 The Children's Hospital
of Philadelphia®

SITE

NAVAL SQUARE
619 UNITS

**27TH & SCHUYLKILL AVENUE & SOUTH STREET
PHILADELPHIA, PA**



The information and images contained herein are from sources deemed reliable. However, Metro Commercial Real Estate, Inc. makes no representation whatsoever as to their accuracy or authenticity. Images shown may be modified for illustrative purposes. Images may be out-of-date and not current. 1.21.20



The information and images contained herein are from sources deemed reliable. However, Metro Commercial Real Estate, Inc. makes no representation whatsoever as to their accuracy or authenticity. Images shown may be modified for illustrative purposes. Images may be out-of-date and not current. 1.21.20

**27TH & SCHUYLKILL AVENUE & SOUTH STREET
PHILADELPHIA, PA**

