

# FOR LEASE

## PROFESSIONAL OFFICE SUITES

519 Davisville Road  
Willow Grove, PA 19090



# North American Commercial Realty

### Space Available

- ± 782 SF
- ± 870 SF
- ± 954 SF
- ± 988 SF

DEMOGRAPHICS	1 mile	3 mile	5 mile
Population	12,027	83,248	234,873
Avg. HH income	\$85,518	\$99,498	\$106,856
Daytime Population	10,506	63,623	141,946



*Upper Moreland Township, Montgomery County*

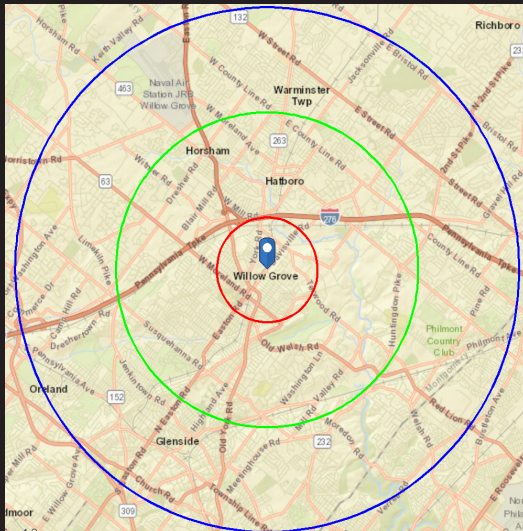

*Easy access to Easton Rd (Route 611) & PA Turnpike*

TRAFFIC COUNT	Davisville Rd.	11,000 AADT
---------------	----------------	-------------

### Jim Pointer

627 N. Duke Street  
Lancaster, PA 17602  
+1 800 481 8220  
jim@nacommercialrealty.com

# FOR LEASE

## PROFESSIONAL OFFICE SUITES

519 Davisville Road  
Willow Grove, PA 19090

<b>Suite 1</b>	<b>988 SF</b>
<b>Suite 2</b>	<b>954 SF</b>
<b>Suite 3 (occupied)</b>	<b>652 SF</b>
<b>Suite 4</b>	<b>870 SF</b>
<b>Suite 5</b>	<b>782 SF</b>

Subject to Change

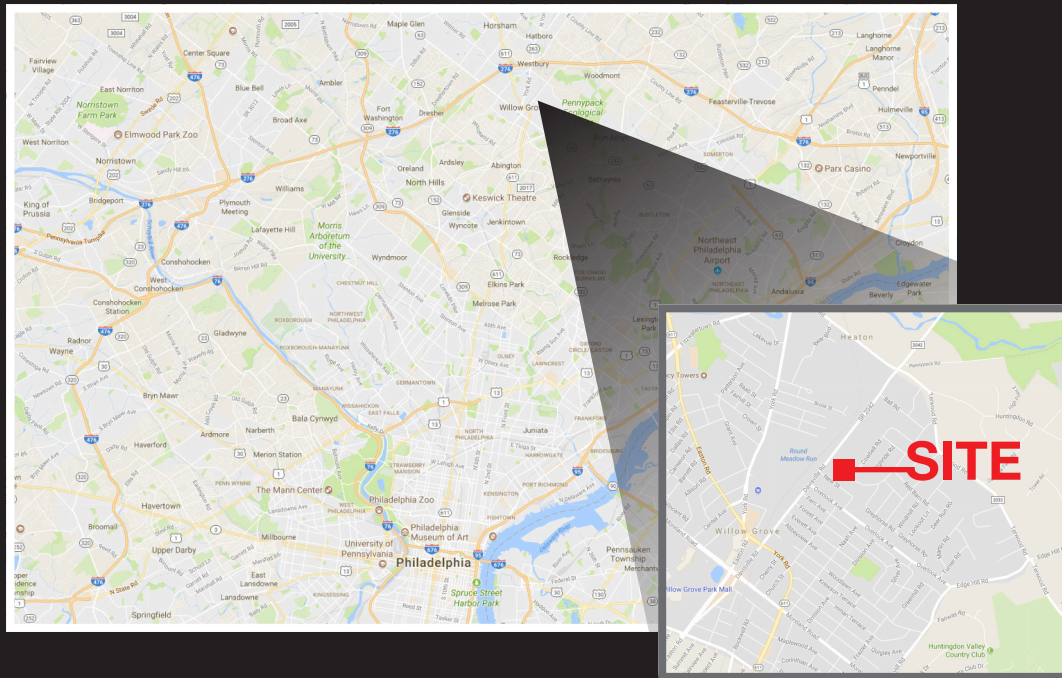
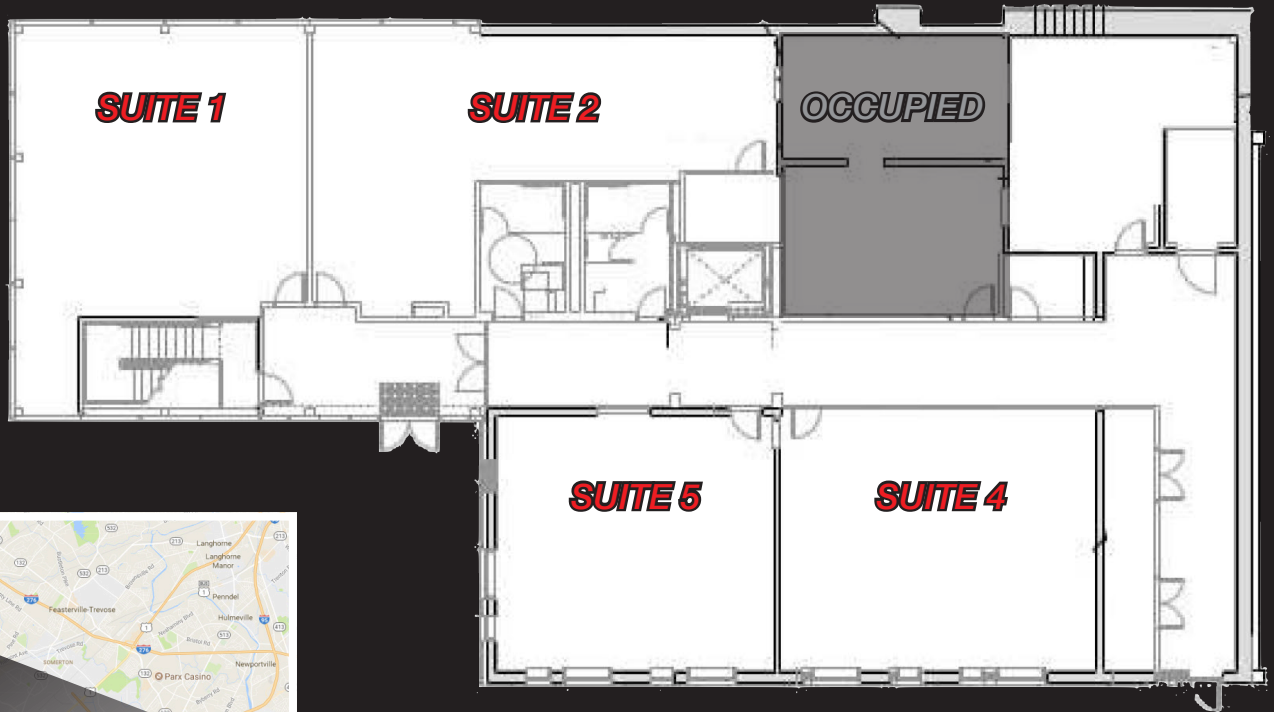

## FEATURES

- *First floor suites available for lease*
- *To code ADA accessibility, sprinklered*
- *Common entrance with security keypad system, lobby, ADA compliant restrooms*
- *Ample on site parking*
- *Close to Willow Grove/PA Turnpike interchange*



**North American  
Commercial Realty**

**Jim Pointer**

627 N. Duke Street  
Lancaster, PA 17602

+1 800 481 8220

[jim@nacommercialrealty.com](mailto:jim@nacommercialrealty.com)