

Offices @ **LOWE MILL**

2211 Seminole Drive
Huntsville, AL 35805

±9,000 SF of business space is now
available in the North Wing of
Lowe Mill.

Rate: \$12.50 psf + Utilities
& Janitorial

Space Offered by:
Samples Properties

Contact Jim Smoot for more info

525 Madison Street
Suite 205
Huntsville, AL 35801
256.533.0003

jim@samplesproperties.com
samplesproperties.com



The terms, prices, site plans and /or floor plans may change without notice. All information provided was acquired from the owner or reliable sources, however, Samples Properties is not responsible for typographical errors or erroneous information deemed accurate at the time of publication.

LOWE MILL was a massive former textile mill (originally opened in 1910) that has been restored into what it stands today. Among 200 working artists, makers and creatives, the North Building is now leasing office space & amenities include:

- * Glass Walls
- * Hardwood & Concrete Floors
- * Loading Dock
- * Secure Parking
- * Located in a HUBzone

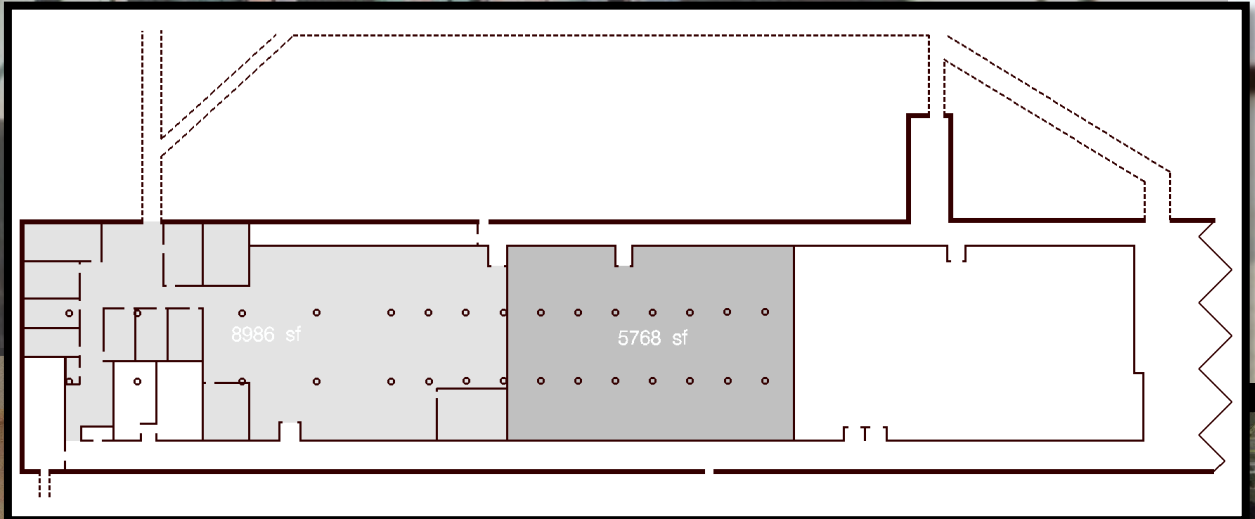

Contact Jim Smoot at:

525 Madison Street
Suite 205
Huntsville, AL 35801
256.533.0003

jim@samplesproperties.com
samplesproperties.com



The terms, prices, site plans and /or floor plans may change without notice. All information provided was acquired from the owner or reliable sources, however, Samples Properties is not responsible for typographical errors or erroneous information deemed accurate at the time of publication.