

FOR LEASE OFFICE / RETAIL

TWO CONSTITUTION DRIVE VIRGINIA BEACH, VIRGINIA | 23462 |



PROPERTY FEATURES

- Located in an Opportunity Zone (www.yesvirginiabeach.com/oz)
- Mixed-use development with residential, retail, and office located at the intersection of Bonney Road and Constitution Drive, gateway to Town Center of Virginia Beach
- 13,867 SF first floor office/retail for lease (Can subdivide)
- Zoned B4C (Central Business Mixed-Use District)
- Covered parking garage connected to suites
- Slated for delivery Fall 2021
- RENT: \$19.50 NNN

Demographics (2019)

	1 Mile	3 Miles	5 Miles
Population	14,801	134,700	292,817
Households	6,705	52,452	109,950
Ave. HH Inc.	\$77,232	\$85,608	\$90,251

HARVEY LINDSAY COMMERCIAL REAL ESTATE
 999 Waterside Drive • Suite 1400
 Norfolk, Virginia 23510
 757-640-8700
 www.HarveyLindsay.com
A Tradition of Forward Thinking

CONTACT: **LINDSAY HIMELRIGHT, CCIM**
(757) 640-9462
lindsayhimmelright@harveylindsay.com

FOR LEASE OFFICE / RETAIL

TWO CONSTITUTION DRIVE VIRGINIA BEACH, VIRGINIA | 23462 |

SOUTH BUILDING ELEVATION

SCALE: 1/16" = 1'-0"



Bonney Rd.

WEST BUILDING ELEVATION

SCALE: 1/16" = 1'-0"



Constitution Dr.

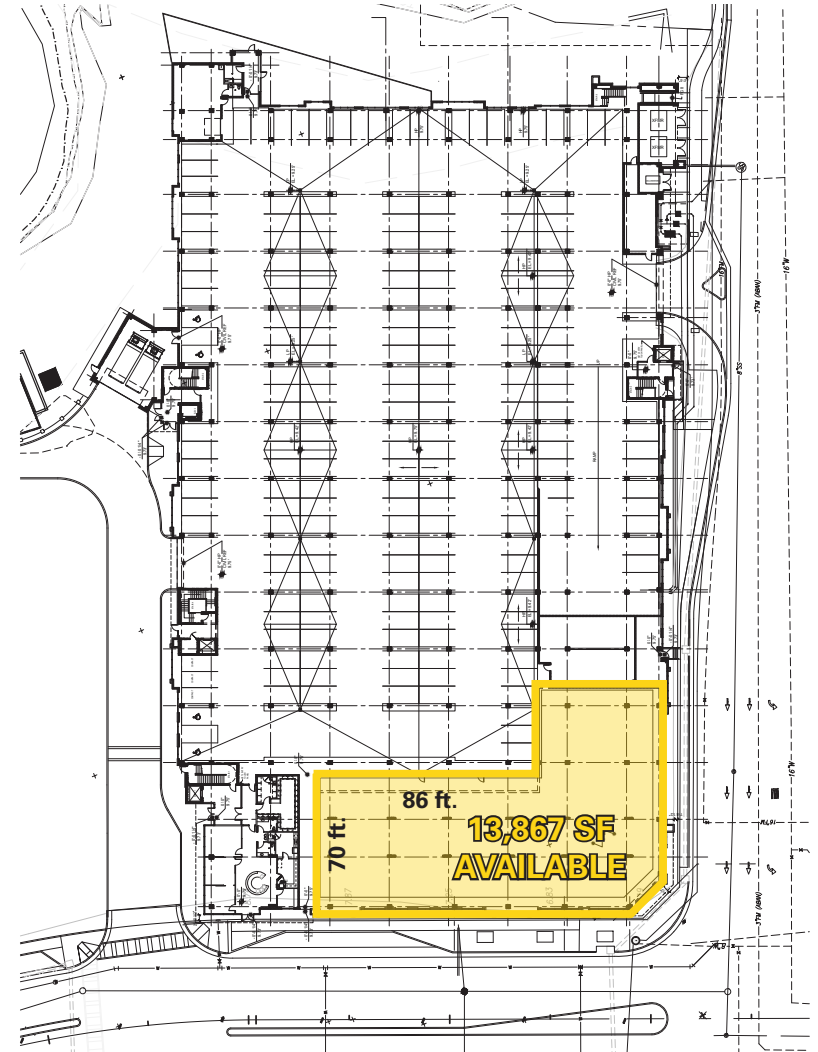

Constitution Dr.

HARVEY LINDSAY
COMMERCIAL REAL ESTATE

A Tradition of Forward Thinking

999 Waterside Drive • Suite 1400
Norfolk, Virginia 23510
757-640-8700
www.HarveyLindsay.com

CONTACT: **LINDSAY HIMELRIGHT, CCIM**
(757) 640-9462
lindsayhimelright@harveylindsay.com

FOR LEASE OFFICE / RETAIL

TWO CONSTITUTION DRIVE VIRGINIA BEACH, VIRGINIA | 23462 |

MIXED USE CONCEPTUAL PLAN

For Sale
2.66 Acres

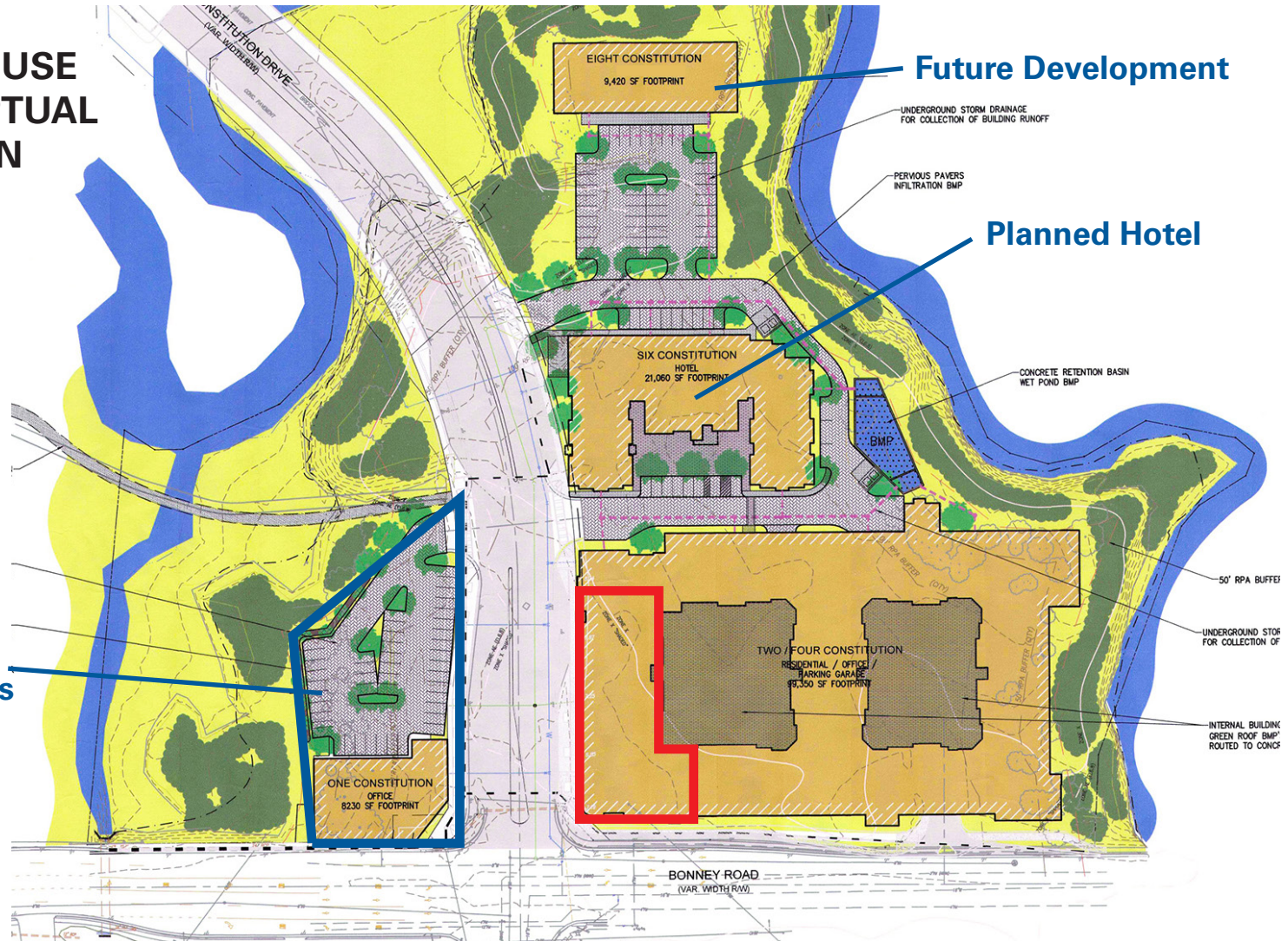

HARVEY LINDSAY
COMMERCIAL REAL ESTATE

A Tradition of Forward Thinking

999 Waterside Drive • Suite 1400
Norfolk, Virginia 23510
757-640-8700
www.HarveyLindsay.com

CONTACT: **LINDSAY HIMELRIGHT, CCIM**
(757) 640-9462
lindsayhimelright@harveylindsay.com