

FOR SALE OR LEASE

1857 ENTERPRISE DRIVE
ROCHESTER HILLS, MICHIGAN

27,000 Square Feet Available



**SIGNATURE
ASSOCIATES**
KNOW SIGNATURE | KNOW RESULTS

GREAT BUILDING



PROPERTY FEATURES

- 27,000 square feet building available
- 3,700 square feet of office
- (2) 12x14 grade level doors, (1) truckwell
- (1) 5-Ton crane
- ESFR Fire Protection
- Zoned Light Industrial
- 48 parking spaces
- 1,200 amps, 480 volts power, buss duct
- Building completely updated in 2014 with new roof in 2015 (15-year warranty)
- Epoxy flooring in shop
- Lease Rate: \$7.25/sq.ft. NNN



For more information, please contact:

JOHN BOYD
(248) 948 0102
jboyd@signatureassociates.com

PAUL HOGE
(248) 948 0103
paulhoge@signatureassociates.com

KRIS PAWLOWSKI
(248) 359 3801
kpawlowski@signatureassociates.com

1857 Enterprise Drive – Rochester Hills, Michigan

For Sale or Lease

Interior Photos

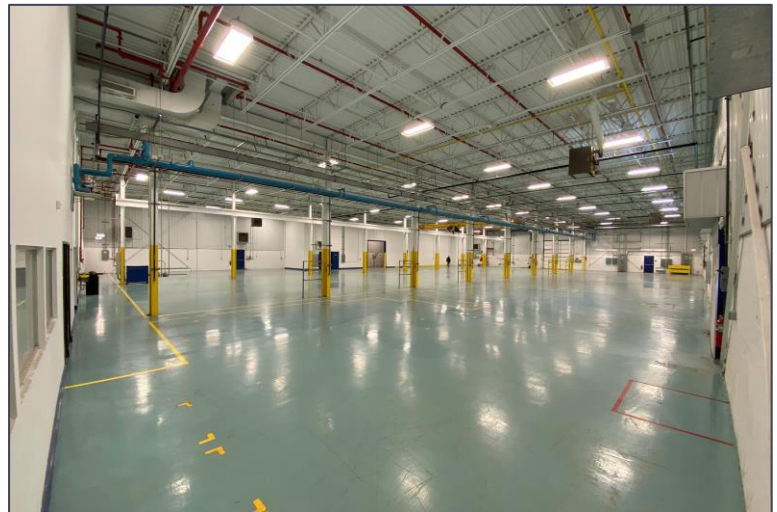

For more information, please contact:

JOHN BOYD
(248) 948 0102

PAUL HOGE
(248) 948 0103

KRIS PAWLOWSKI
(248) 359 3801

SIGNATURE ASSOCIATES
One Towne Square, Suite 1200
Southfield, MI 48076
www.signatureassociates.com

1857 Enterprise Drive – Rochester Hills, Michigan

For Sale or Lease

Site Plan

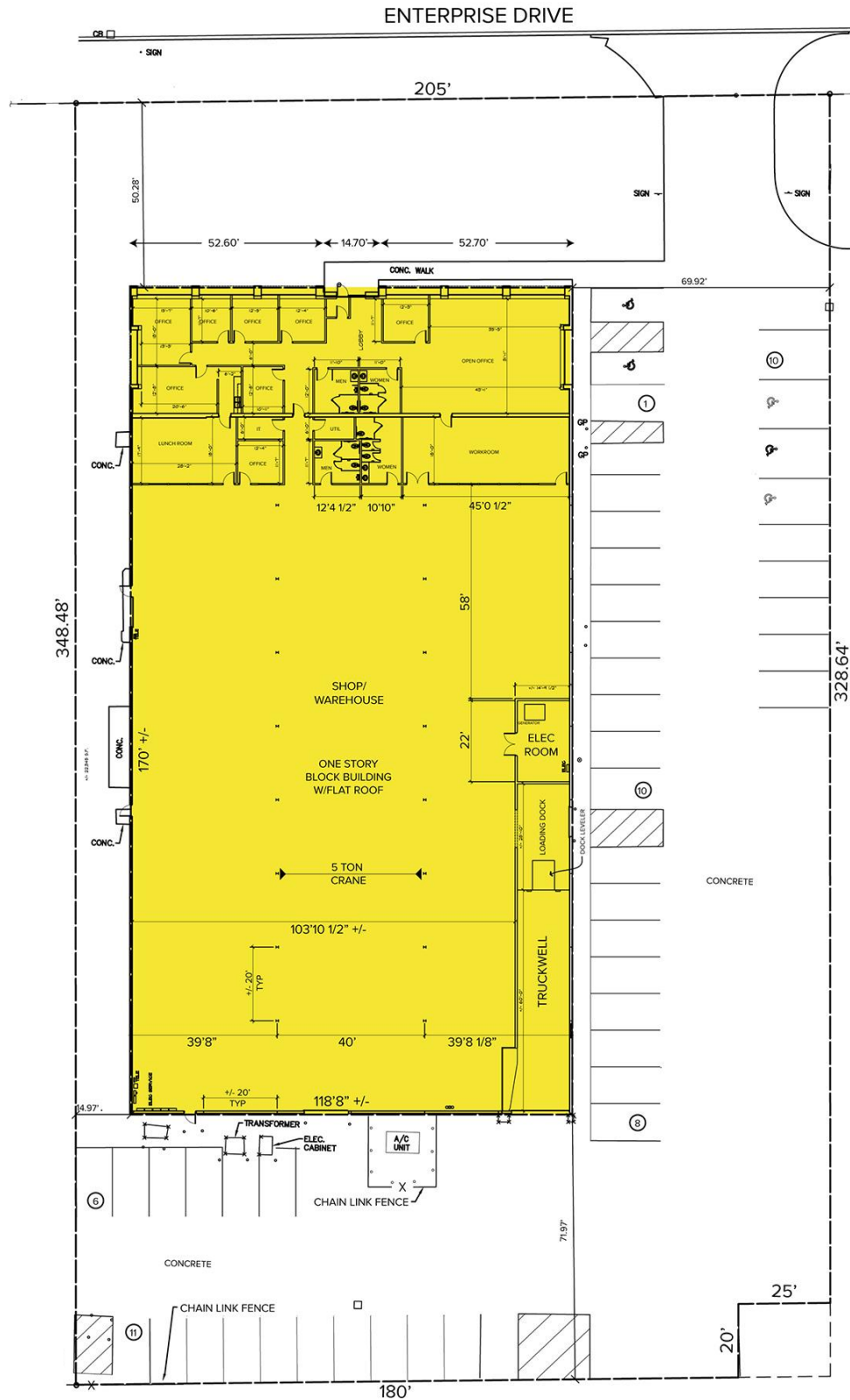

For more information, please contact:

JOHN BOYD
(248) 948 0102

PAUL HOGE
(248) 948 0103

KRIS PAWLOWSKI
(248) 359 3801

SIGNATURE ASSOCIATES
One Towne Square, Suite 1200
Southfield, MI 48076
www.signatureassociates.com

1857 Enterprise Drive – Rochester Hills, Michigan

For Sale or Lease

Floor Plan

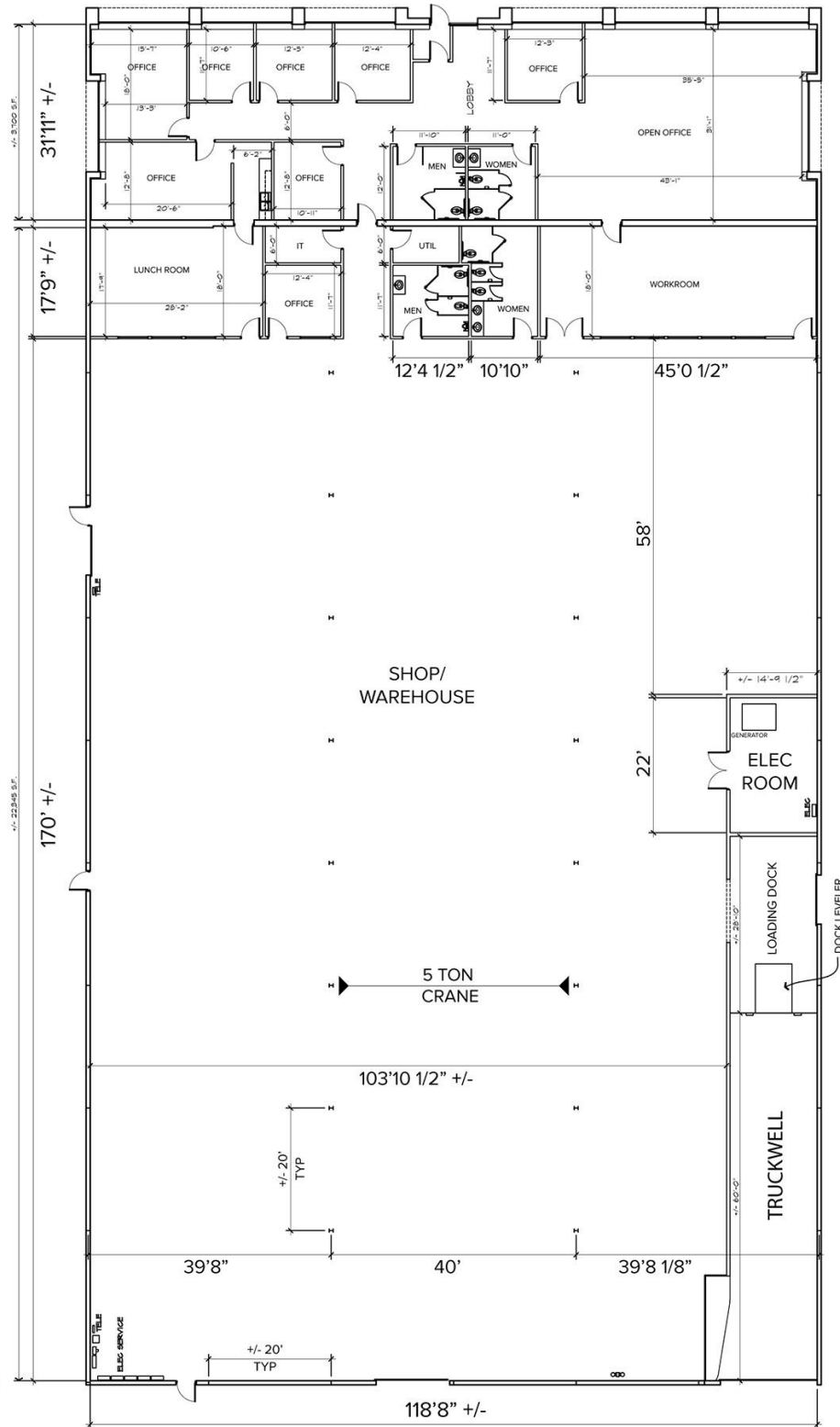

For more information, please contact:

JOHN BOYD
(248) 948 0102

PAUL HOGE
(248) 948 0103

KRIS PAWLOWSKI
(248) 359 3801

SIGNATURE ASSOCIATES
One Towne Square, Suite 1200
Southfield, MI 48076
www.signatureassociates.com

1857 Enterprise Drive – Rochester Hills, Michigan

For Sale or Lease

Aerial



For more information, please contact:

JOHN BOYD
(248) 948 0102

PAUL HOGE
(248) 948 0103

KRIS PAWLOWSKI
(248) 359 3801

SIGNATURE ASSOCIATES
One Towne Square, Suite 1200
Southfield, MI 48076
www.signatureassociates.com