

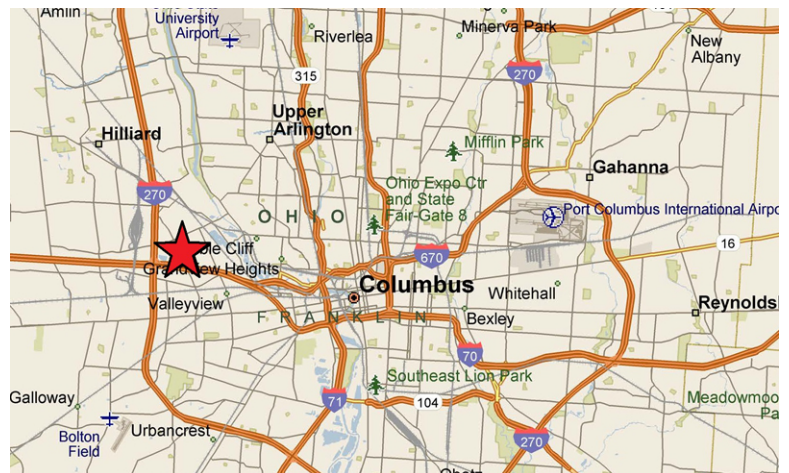

PROPERTY HIGHLIGHTS

- 52'x50' column spacing
- 22'-28' clear height
- Approx. 3,000 SF office
- 7 docks w/ levelers
- 2 drive-in door
- T5 High Efficiency Lighting
- Power: 480 V 250 amps
- Good access to I-70 and I-270



Michael R. Linder | 614.410.5628 | michael.linder@colliers.com
Jim Maneri | 610.648.1758 | jmaneri@libertyproperty.com



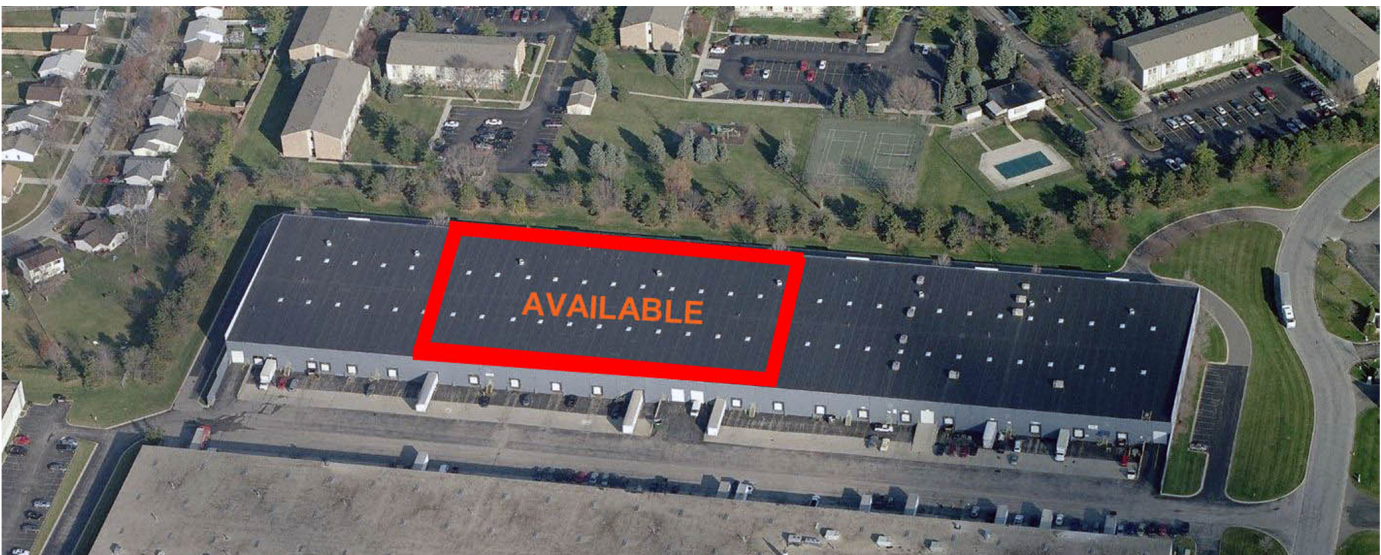
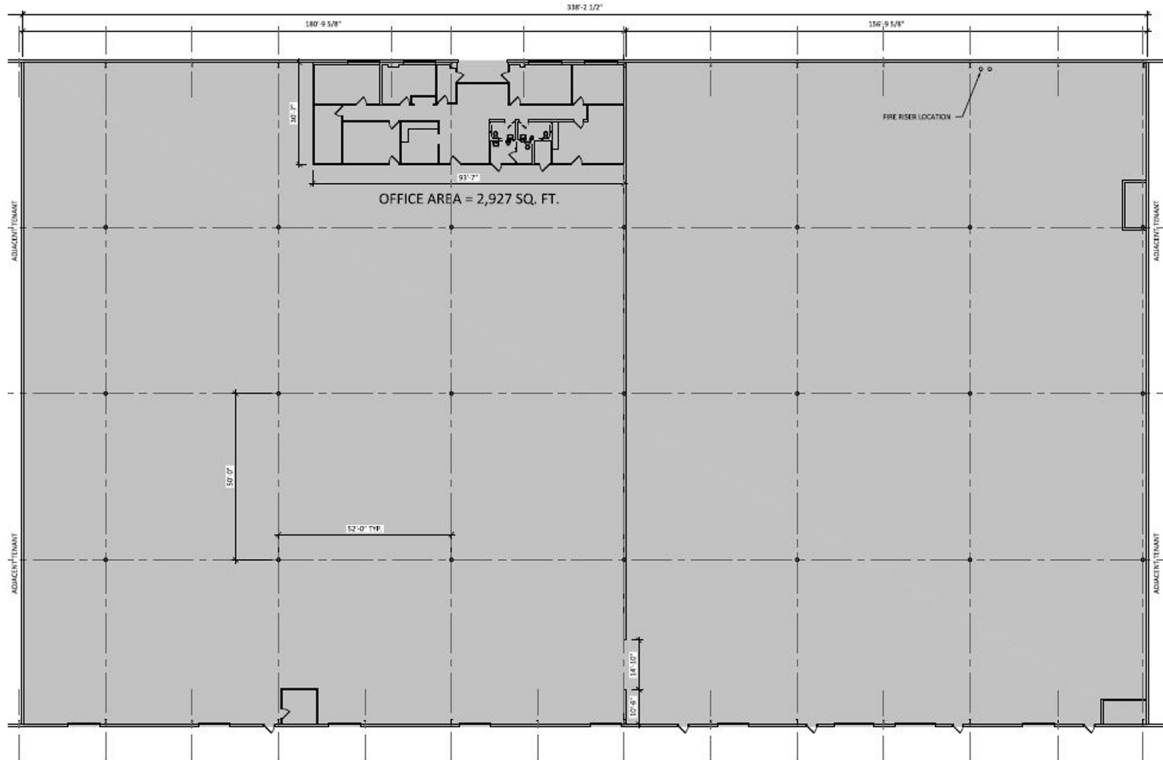

Michael R. Linder | 614.410.5628 | michael.linder@colliers.com
Jim Maneri | 610.648.1758 | jmaneri@libertyproperty.com

