

# AVAILABLE FOR LEASE

2351 Potshop Lane | East Norriton Twp | Montgomery County, PA

# NORRITON BUSINESS CAMPUS



The foregoing information has been obtained from sources deemed to be reliable; however, no warranty or representation is made as to accuracy. This information is subject to errors, omissions, prior sale or lease, or withdrawal without notice.

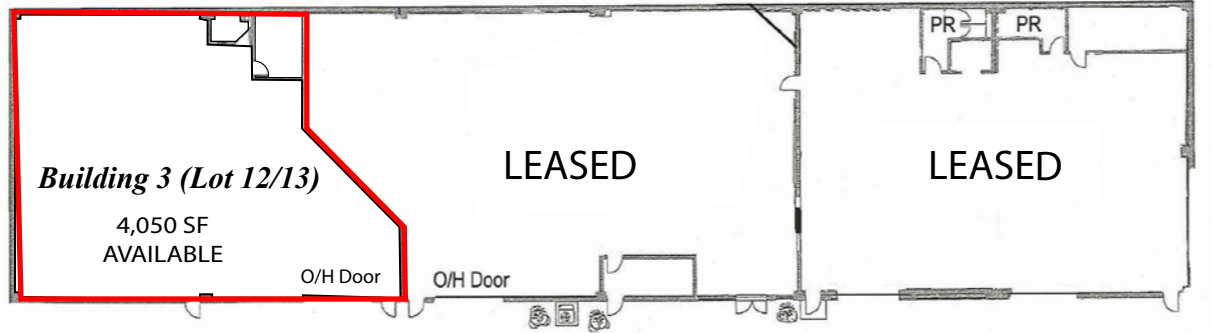

- ttc** 4,050 SF Available
- ttc** 1 Overhead Door, 10' x 14'
- ttc** Maximum Ceiling Height: 11'
- ttc** 3-Phase, 100 Amps, 208 Volts
- ttc** Warehouse / Storage Space
- ttc** Zoned Limited Industrial

Norriton Business Campus is strategically located on the Germantown Pike corridor in East Norriton Township. Join over 424,378 SF of Office, Commercial and Industrial space in the beautifully landscaped park like setting of Norriton Business Campus, complete with walking trails to enjoy the sunshine. The campus is 1 mile from Einstein Medical Center, and an array of restaurants, retail, personal, professional and medical services in close vicinity. Norriton Business Campus provides accessibility to all major markets in the Tri-State area and is a ten minute drive from the Mid-County / Plymouth Meeting Interchange of the PA Turnpike (I-276), Northeast Extension, and Blue Route (I-476), providing access to Philadelphia, New Jersey, and New York.

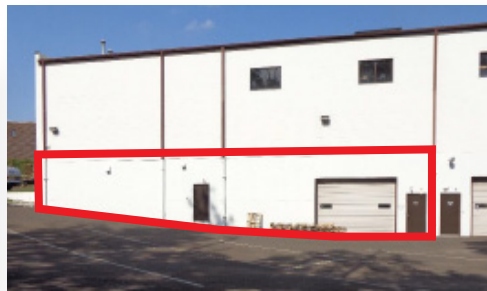
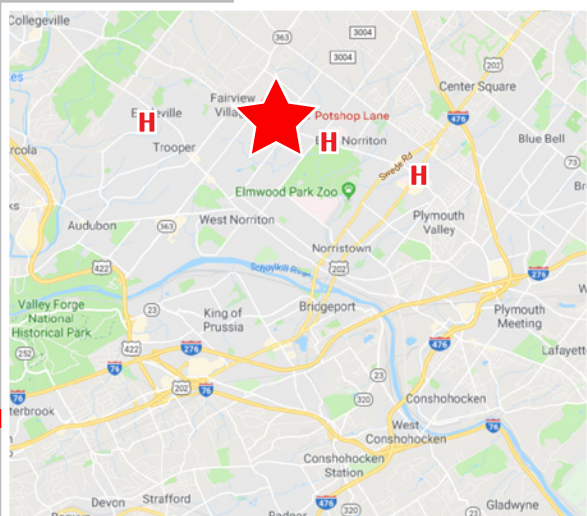

**Michael Tornetta**  
mtornetta@tornetta.com

**TORNETTA**  
REALTY CORP. **ttc**

910 Germantown Pike, Plymouth Meeting, PA 19462

**610-279-4000**





AVAILABLE FOR LEASE: 4,050 SF

2351 Potshop Lane | East Norriton Twp | Montgomery County, PA

# NORRITON BUSINESS CAMPUS LOT AERIAL



The foregoing information has been obtained from sources deemed to be reliable; however, no warranty or representation is made as to accuracy. This information is subject to errors, omissions, prior sale or lease, or withdrawal without notice.