

65 CRICKET AVENUE

ARDMORE, PA

±1,250 - 4,385 SF AVAILABLE FOR LEASE

NEARBY



lululemon **TRADER JOE'S**

SOULCYCLE **IRON HILL BREWERY**



PROPOSED RENDERING

property highlights.

- New Mixed-Use Development located in the active development center of Ardmore
- High-barrier to entry retail market
- Easy access from Lancaster Avenue (22,460 VPD) and surrounding residential population
- Ideal for full service restaurants, juice bars/cafes, fitness, and medical
- Parking available within the building for retail storefronts – approximately 30 dedicated parking spaces

stats.

2018 DEMOGRAPHICS*	1 MILE	3 MILES	5 MILES
EST. POPULATION	17,738	123,055	425,074
EST. HOUSEHOLDS	7,356	47,017	166,791
EST. AVG. HH INCOME	\$141,985	\$141,953	\$97,027

WILSON AVENUE TRAFFIC COUNT: 22,046 VPD *ESRI 2018



MetroCommercial.com | PHILADELPHIA, PA | PLYMOUTH MEETING, PA | MOUNT LAUREL, NJ | NAPLES, FL

get in touch.

JONATHAN SPOERL

office 215.893.0300
direct 215.282.0157
jspoerl@metrocommercial.com

SCOTT BENSON

office 215.893.0300
direct 215.282.0158
sbenson@metrocommercial.com

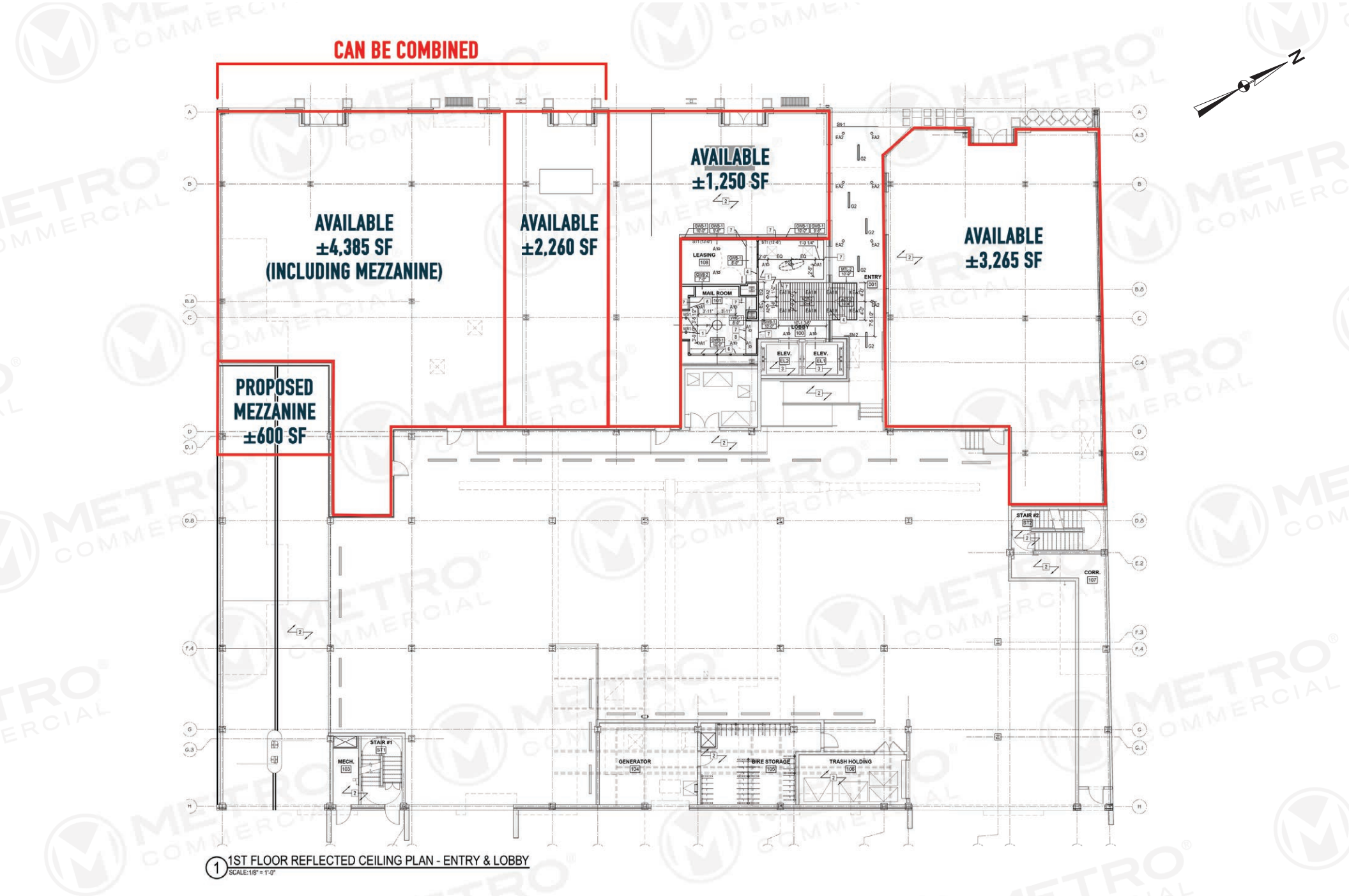

1 1ST FLOOR REFLECTED CEILING PLAN - ENTRY & LOBBY
SCALE: 1/8" = 1'-0"

The information and images contained herein are from sources deemed reliable. However, Metro Commercial Real Estate, Inc. makes no representation whatsoever as to their accuracy or authenticity. Images shown may be modified for illustrative purposes. Images may be out-of-date and not current. 7.02.20

65 CRICKET AVENUE
ARDMORE, PA





RESTAURANT

65 CRICKET

RETAIL

RETAIL

PROPOSED RENDERING

The information and images contained herein are from sources deemed reliable. However, Metro Commercial Real Estate, Inc. makes no representation whatsoever as to their accuracy or authenticity. Images shown may be modified for illustrative purposes. Images may be out-of-date and not current. 7.02.20

65 CRICKET AVENUE
ARDMORE, PA





- SUBURBAN SQUARE**
- GOVBERG
 - GAP
 - BANANA REPUBLIC
 - TRADER JOE'S
 - SEPHORA
 - BESITO
 - STARBUCKS
 - LIFETIME FITNESS
 - SOULCYCLE
 - Free People
 - Apricot Lane
 - west elm
 - ANN TAYLOR
 - Free People
 - URBAN OUTFITTERS
 - Madewell
 - lululemon
 - athletica

PROPOSED ONE ARDMORE PLACE DEVELOPMENT
 116 APARTMENTS
 133 PUBLIC PARKING SPACES

SITE
PROPOSED CRICKET FLATS DEVELOPMENT
 77 APARTMENTS

65 CRICKET AVENUE
ARDMORE, PA



The information and images contained herein are from sources deemed reliable. However, Metro Commercial Real Estate, Inc. makes no representation whatsoever as to their accuracy or authenticity. Images shown may be modified for illustrative purposes. Images may be out-of-date and not current. 7.02.20



GAP
ANTHROPOLOGIE
 lululemon **athletica**

VILLANOVA UNIVERSITY
 10,000 STUDENTS

ROSEMONT COLLEGE
 1,100 STUDENTS

BRYN MAWR VILLAGE
 ATHLETA
 bluemercury
 La COLOMBE
 KIRNA ZABÈTE
 TURNING POINT
 breakfast, brunch & lunch
 [solidcore]
 BRYN + DANE'S
 HEALTHY, FAST, FOOD

SUBURBAN SQUARE
 GOVBERG
GAP
 BANANA REPUBLIC
TRADER JOE'S
 SEPHORA
 BESITO MEXICAN
 YOUR JOE'S KITCHEN & BAR
 Starbucks
 LIFETIME FITNESS
 SOULCYCLE
 Pooey
 Apricot Lane BOUTIQUE
 west elm
 ANN TAYLOR
 Free People
 URBAN OUTFITTERS
 Madewell
 lululemon **athletica**

WAYNE
FIVE GUYS
FIVE BELOW
CHIPOTLE
 ANTHONY'S
 COULBERT'S PIZZA

GIANT MICRO CENTER
TJ-MAXX
BED BATH & BEYOND
 HomeGoods
 Visionworks
 smash burger
PNC

BRYN MAWR SQUARE
 ZOË'S KITCHEN
 at&t
 EUROPEAN CENTRE
 Trident Mortgage Company

BRYN MAWR FILM INSTITUTE

BRYN MAWR TRAIN STATION

BRYN MAWR

BRYN MAWR HOSPITAL
 1,700 EMPLOYEES

MERION GOLF CLUB

Haverford COLLEGE
 1,200 STUDENTS

EASTERN MOUNTAIN SPORTS

MERION CRICKET CLUB

BRYN MAWR COLLEGE
 1,300 STUDENTS

SITE

MERION CRICKET CLUB

ARDMORE STATION

ARDMORE PLAZA
 planet fitness
 IRON HILL BREWERY & RESTAURANT
 LESLIE'S SWIMMING POOL SUPPLIES

ACME
 petco
 FedEx Office
 five BELOW

WHOLE FOODS

WYNNEWOOD SHOPPING CENTER
 OLD NAVY
 BED BATH & BEYOND
 DSW
GIANT

WYNNEWOOD

ACME

The information and images contained herein are from sources deemed reliable. However, Metro Commercial Real Estate, Inc. makes no representation whatsoever as to their accuracy or authenticity. Images shown may be modified for illustrative purposes. Images may be out-of-date and not current. 7.02.20

65 CRICKET AVENUE
ARDMORE, PA

