

Pacific Business Park Building 3

6904-6908 S 220th Street
Kent, WA

6,250 SF total

1,104 SF office

\$0.55 PSF shell

\$0.75 PSF, NNN office add-on

5 dock-high doors

2 grade-level doors

14' - 16' clear height

Comcast Cable available

Available with 60 days notice



Tremendous access to I-5 and SR-167 via S 212th Street



Doug Klein, SIOR

Senior Vice President

206.248.7348

dklein@kiddermathews.com

Kraig Heeter

Vice President

206.248.7313

kheeter@kiddermathews.com

Pacific Business Park Building 3

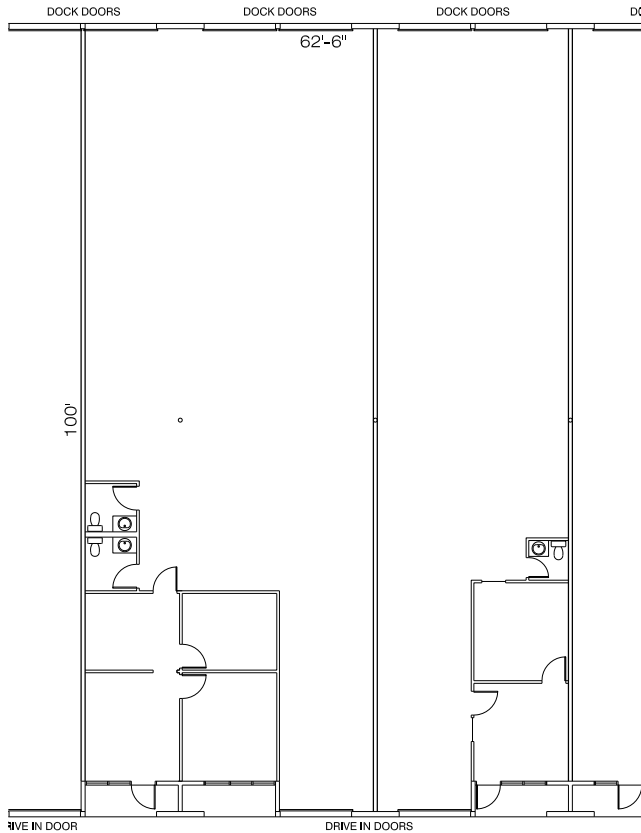

AVAILABLE SPACE
6,250 SF TOTAL
1,104 SF OFFICE

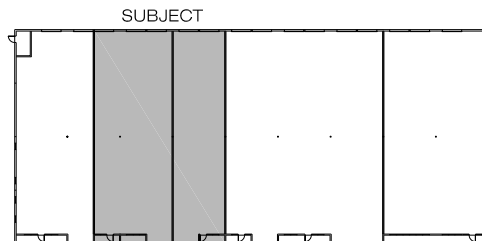

KEY PLAN
NOT TO SCALE

PACIFIC BUSINESS PARK (NORTH)

BUILDING #3 (PTR #158)
6904-6908 S. 220TH STREET
KENT, WA 98032

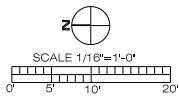

A FACTRUST PROPERTY

Contact

Doug Klein, SIOR
Senior Vice President
206.248.7348
dklein@kiddermathews.com

Kraig Heeter
Vice President
206.248.7313
kheeter@kiddermathews.com