

LANDMARK CENTER

400 SUNRISE ROSEVILLE
CALIFORNIA



CHRIS SCHWARZE
+1 916 288 4803
chris.schwarze@cushwake.com
LIC #01291261

KEVIN PARTINGTON
+1 916 288 4807
kevin.partington@cushwake.com
LIC #01199010



400 Capitol Mall, Suite 1800
Sacramento, California 95814
main +1 916 288 4800
cushmanwakefield.com

LANDMARK CENTER

400 SUNRISE ROSEVILLE
CALIFORNIA



LEASE RATE:

\$2.05 psf Fully Serviced



LOCATION:

Directly off Hwy 80 with a signalized vehicle entrance to the property.



PARKING:

4.0/1,000 SF



SIGNAGE:

Multiple signage options available



AMENITIES:

Convenient distance to numerous restaurants, shopping, hotels and medical offices.



TENANT IMPROVEMENTS:

Built to Suit (subject to mutually agreeable plan)



OWNERSHIP:

Strong, local ownership

CHRIS SCHWARZE
+1 916 288 4803
chris.schwarze@cushwake.com
LIC #01291261

KEVIN PARTINGTON
+1 916 288 4807
kevin.partington@cushwake.com
LIC #01199010



400 Capitol Mall, Suite 1800
Sacramento, California 95814
main +1 916 288 4800
cushmanwakefield.com

LANDMARK CENTER

400 SUNRISE ROSEVILLE
CALIFORNIA

SECOND FLOOR | ±2,067 RSF

Move-in ready spec suite

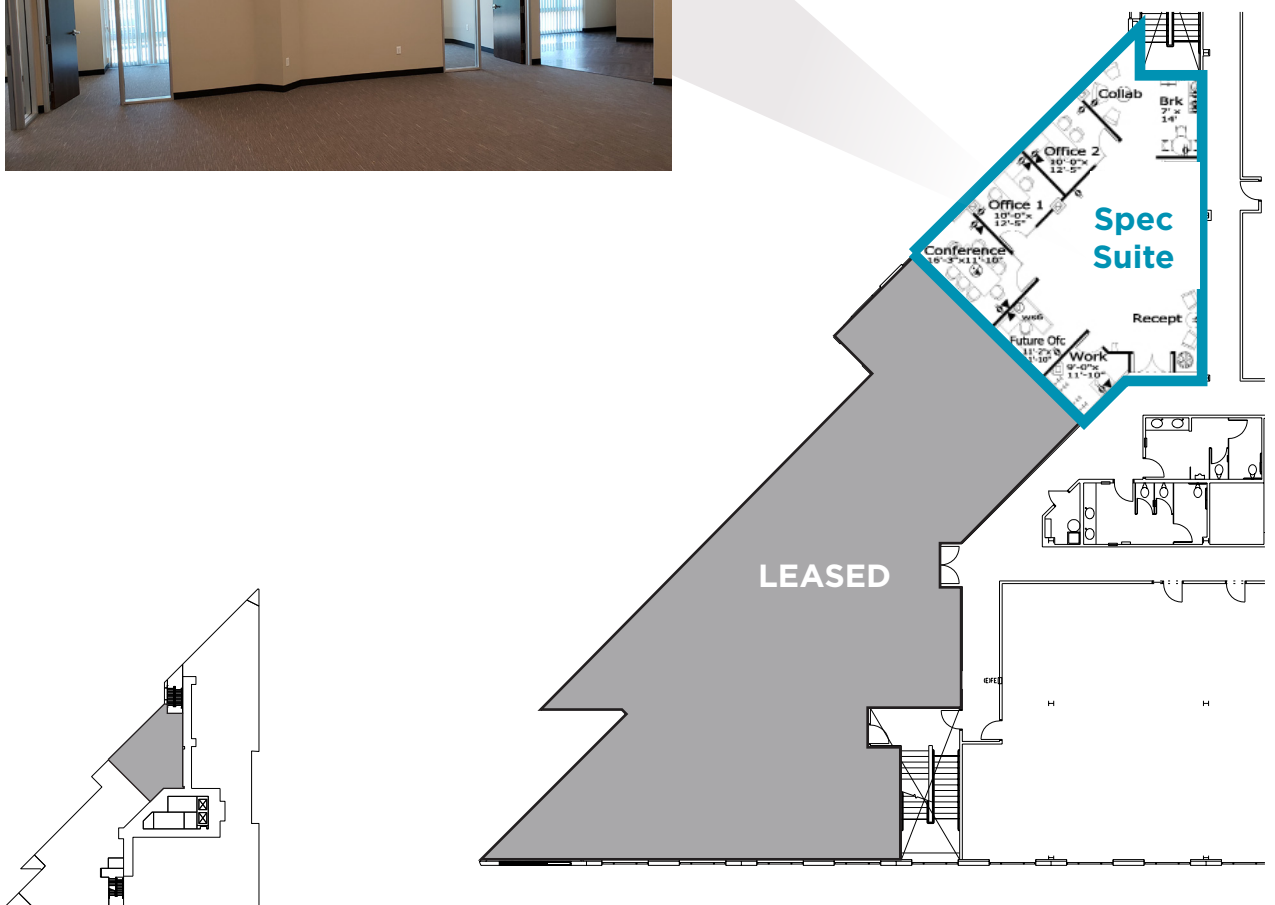

CHRIS SCHWARZE
+1 916 288 4803
chris.schwarze@cushwake.com
LIC #01291261

KEVIN PARTINGTON
+1 916 288 4807
kevin.partington@cushwake.com
LIC #01199010



400 Capitol Mall, Suite 1800
Sacramento, California 95814
main +1 916 288 4800
cushmanwakefield.com

LANDMARK CENTER

400 SUNRISE ROSEVILLE
CALIFORNIA



CHRIS SCHWARZE
+1 916 288 4803
chris.schwarze@cushwake.com
LIC #01291261

KEVIN PARTINGTON
+1 916 288 4807
kevin.partington@cushwake.com
LIC #01199010



400 Capitol Mall, Suite 1800
Sacramento, California 95814
main +1 916 288 4800
cushmanwakefield.com

LANDMARK CENTER

400 SUNRISE ROSEVILLE
CALIFORNIA

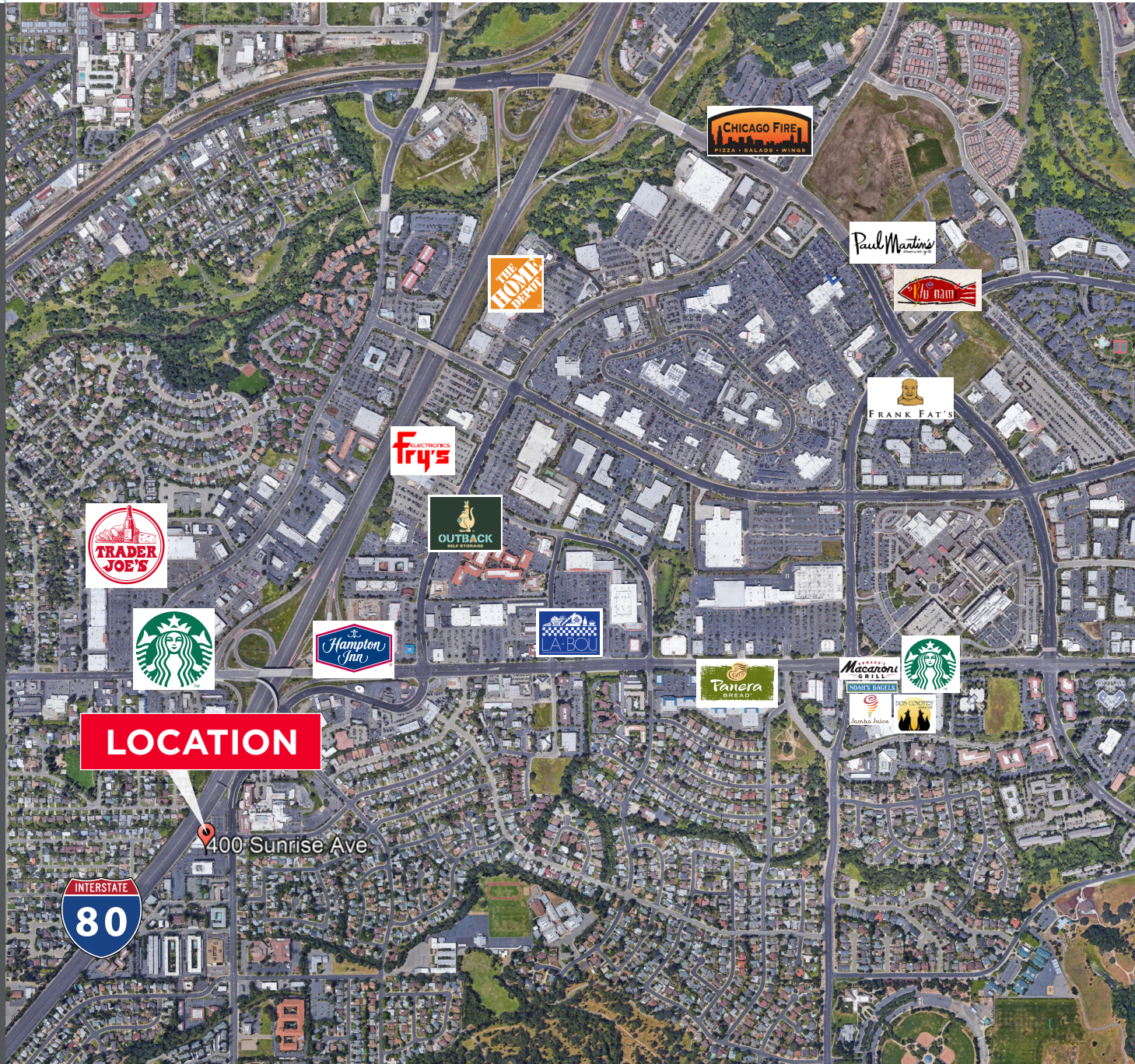

CHRIS SCHWARZE
+1 916 288 4803
chris.schwarze@cushwake.com
LIC #01291261

KEVIN PARTINGTON
+1 916 288 4807
kevin.partington@cushwake.com
LIC #01199010



400 Capitol Mall, Suite 1800
Sacramento, California 95814
main +1 916 288 4800
cushmanwakefield.com