

The Schultz-Hill Professional Arts Building



1616 PACIFIC AVENUE ♦ ATLANTIC CITY, NJ

Located in the heart of Atlantic City on Pacific Avenue, tall and majestic, stands the Professional Arts Building. Built in 1928 the building is a shining example of classic architecture.

The building has recently been upgraded to reflect modern necessity: New High-Speed Elevators, Card Access Entrance, Intercom Systems, New Weatherized Windows, Carpet and Lighting are but a few of the recent improvements made by on-site management.

This Atlantic City icon has been home to many businesses big *and* small. Come see the Schultz-Hill Professional Arts Building today, you'll want to call it home to your business too!



- ♦ **NEWLY REFURBISHED**
- ♦ **FIBER OPTICS**
- ♦ **NEW HIGH - SPEED ELEVATORS**
- ♦ **FIRE PROOF CONSTRUCTION**
- ♦ **CONVENIENT PARKING**
- ♦ **INTERCOM SYSTEM**
- ♦ **SECURITY CAMERAS**
- ♦ **CARD ACCESS ENTRY**
- ♦ **ELECTRIC, HEAT & AIR CONDITIONING INCLUDED***

Call for Appointment
(609) 347-1616

1616 Management, LLC
1616 Pacific Avenue FL 6
Atlantic City, NJ 08401
email: info@1616pr.com

The Schultz-Hill Professional Arts Building

1616 PACIFIC AVENUE ATLANTIC CITY

Standard Floor Plan

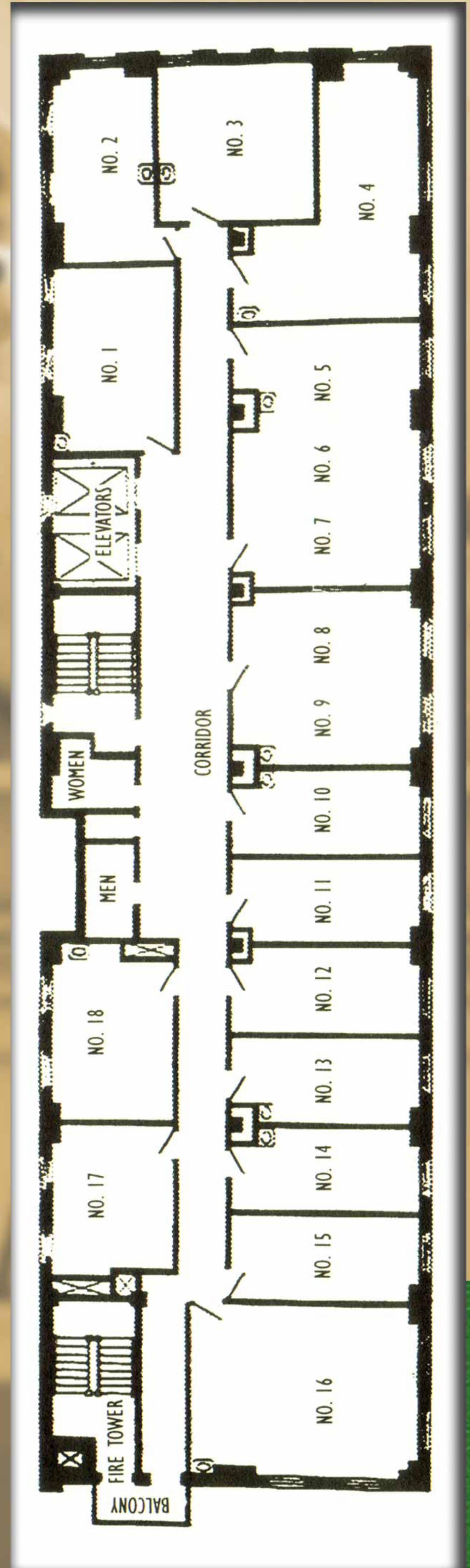

*some restrictions apply