

READY FOR
OCCUPANCY Q2



HORIZON
— SUNNYVALE —

MODERNIZED SILICON VALLEY OFFICE CAMPUS
±45,500 - ±181,210 SF



EMBARCADERO
CAPITAL PARTNERS



SHAWN KELLENBERGER
408.987.4170
skellenberger@ngkf.com
CA RE License #01706215

MIKE SAIGN
408.982.8403
msaign@ngkf.com
CA RE License #01706668

JEFF ARRILLAGA
408.982.8403
jarrillaga@ngkf.com
CA RE License #00935379

PATTY MCGUIGAN
650.688.8519
pmcguigan@ngkf.com
CA RE License #00800652

RENOVATIONS UNDERWAY

CAMPUS OVERVIEW



4-Interconnected Buildings Totaling $\pm 181,210$ SF



Divisible By Building to Approximately $\pm 45,000$ SF



Walking Distance to Wide Range of Restaurant, Retail and Service Amenities



Convenient Access to Caltrain and VTA Shuttle to Lawrence Station



Customizable and Flexible Interiors



Extensive Exterior, Interior and Site **Renovations Underway**



Prime Sunnyvale Location with **Immediate Access** to Highways 101, 237 and Central Expressway



Extensive Window Line



3.1/1,000 SF Parking Ratio



Responsive Local Ownership



► CREATIVE TECH INTERIORS +
ABUNDANT NATURAL LIGHT



HYPOTHETICAL FULL BUILDING TEST-FIT

FIRST FLOOR

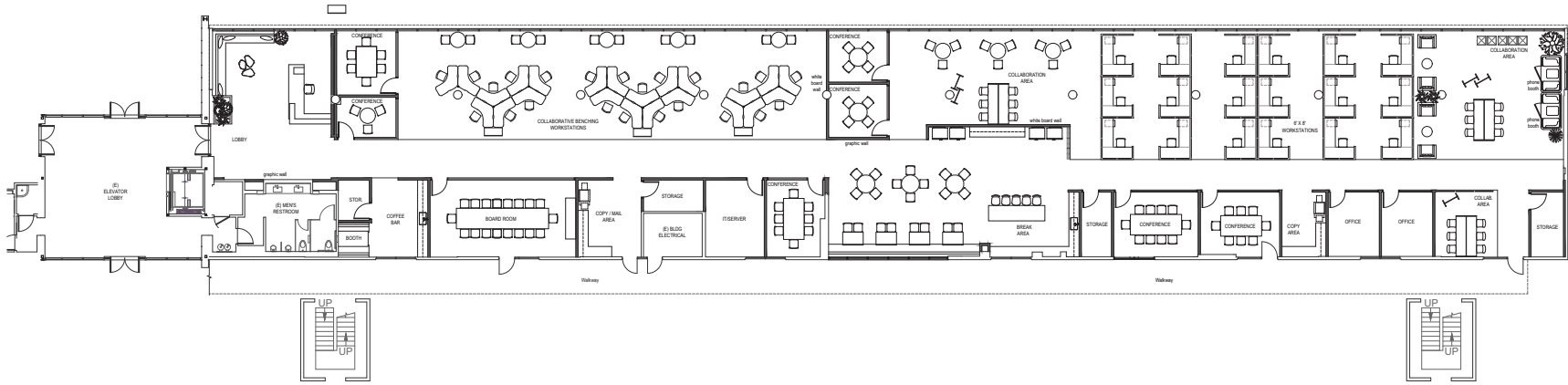

SECOND FLOOR

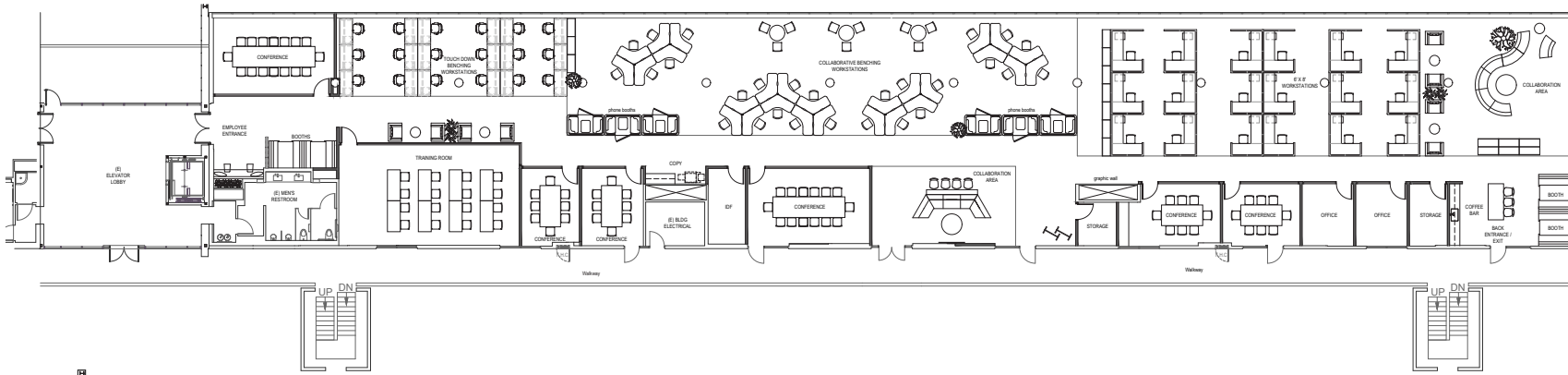

THIRD FLOOR

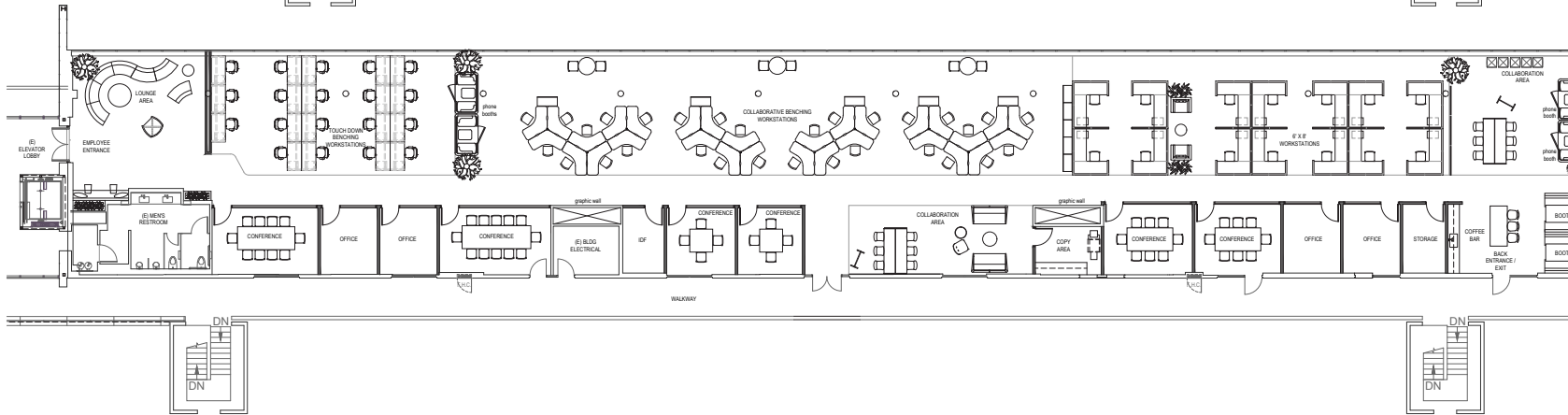

80	COLLABORATIVE WORKSTATIONS	8	PRIVATE OFFICES	1	IT / SERVERS	1	BREAK ROOM
38	TOUCHDOWN BENCHING WORKSTATIONS	20	CONFERENCE ROOMS	1	TRAINING ROOM	6	COLLABORATION AREAS
50	6'X8' WORKSTATIONS	3	COPY	7	STORAGE ROOMS	1	LOUNGE
168	TOTAL WORKSTATIONS	1	COPY / MAIL AREA	3	COFFEE BAR		

▶ AGILE WORK ENVIRONMENT +
FLEXIBLE FLOORPLANS



▶ CAMPUS AERIAL

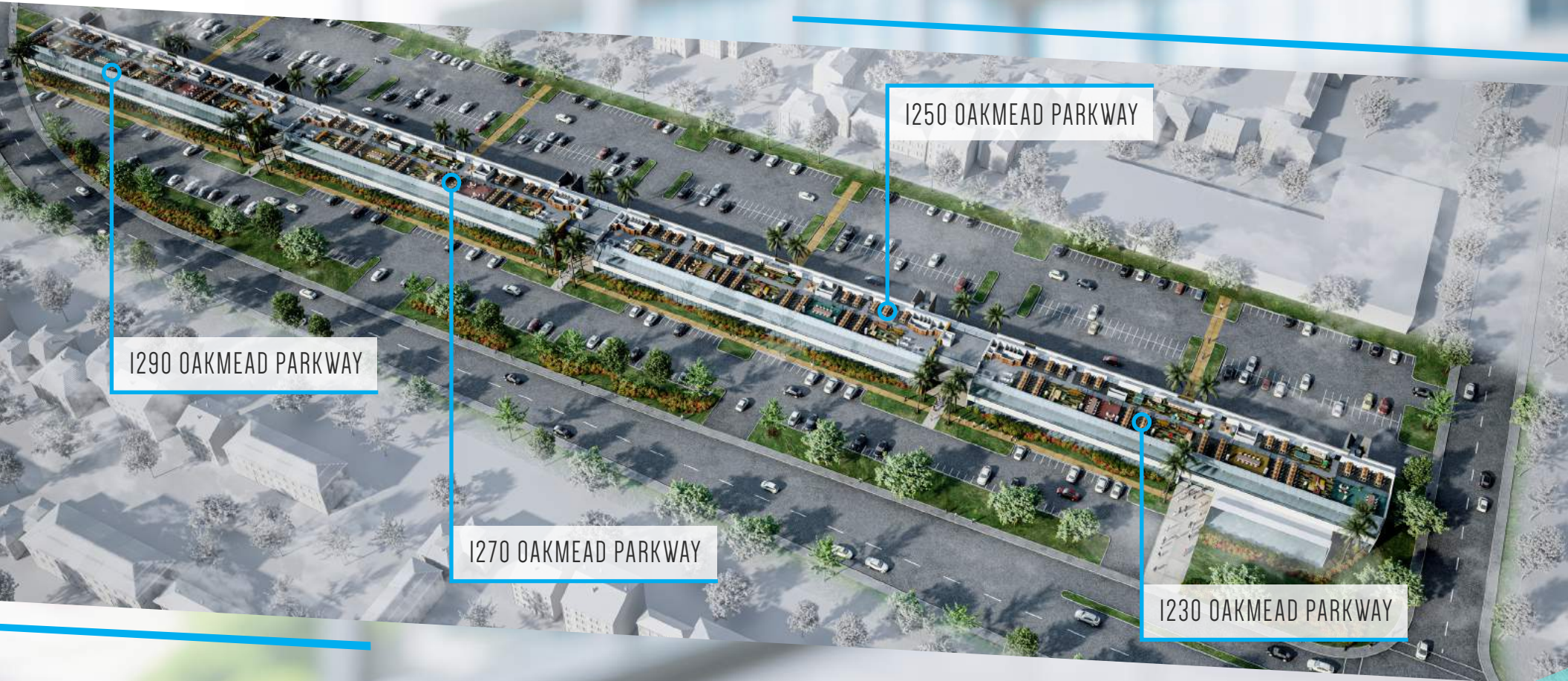

1290 OAKMEAD PARKWAY

1250 OAKMEAD PARKWAY

1270 OAKMEAD PARKWAY

1230 OAKMEAD PARKWAY

- ▶ **4-Interconnected** Buildings Totaling $\pm 181,210$ SF
Divisible By Building to Approximately $\pm 45,000$ SF

AMENITIES

- BARN THAI RESTAURANT
- TIA JUANA MEXICAN GRILL
- DOS PALOMAS TAQUERIA
- SUPER SUNNYVALE MARKET
- LA RONDA
- PIZZA DEPOT
- PHO'VY
- ARMENIAN GOURMET
- SUSHI BKVD
- OBED MEDITERRANEAN CUISINE
- DANIELLE'S CAFE BAKE SHOP
- CLARITA'S FILIPINO CUISINE
- WESTERN PACIFIC FILIPINO GROCERY

- MERCADO SHOPPING CENTER
- IN-N-OUT
- TOMATINA
- SUBWAY
- PANDA EXPRESS
- MEXICAN GRILL
- JAMBA JUICE
- STARBUCKS
- SMOKEEATERS
- KRISPY KREME
- WORLD WRAPS
- YOYO SUSHI
- BEN & JERRY'S

- MCDONALDS
- MADHABAN INDIAN CUISINE
- TOGO'S
- SUBS PIZZA
- ROUND TABLE PIZZA
- UNA MAS
- MERIT VEGETARIAN
- BAGEL PLACE CAFE
- TEANADO
- SICHUAN GOURMET

FAULTLINE BREWING COMPANY



PANERA BREAD

CITY SPORTS

- TASTY SUBS & PIZZA
- INDIAN FUSION
- MISSION CITY CAFE
- PAD THAI CUISINE
- ST. JOHN'S BAR & GRILL
- SNEHA RESTAURANT
- 24 HOUR FITNESS
- FALAFEL BITES
- SUBWAY
- YOGA @ CINDY'S
- FRESH U ORDER
- LUV PHO

- SUBWAY
- OFF THE STICK KABOB GRILL
- ANAD BHAVAN INDIAN VEGETARIAN

ICHAAT CAFE

CENTRAL EXPRESSWAY

- COSTCO
- SWEET TOMATOES

LAWRENCE STATION

TO MOUNTAIN VIEW

LAWRENCE EXPRESSWAY

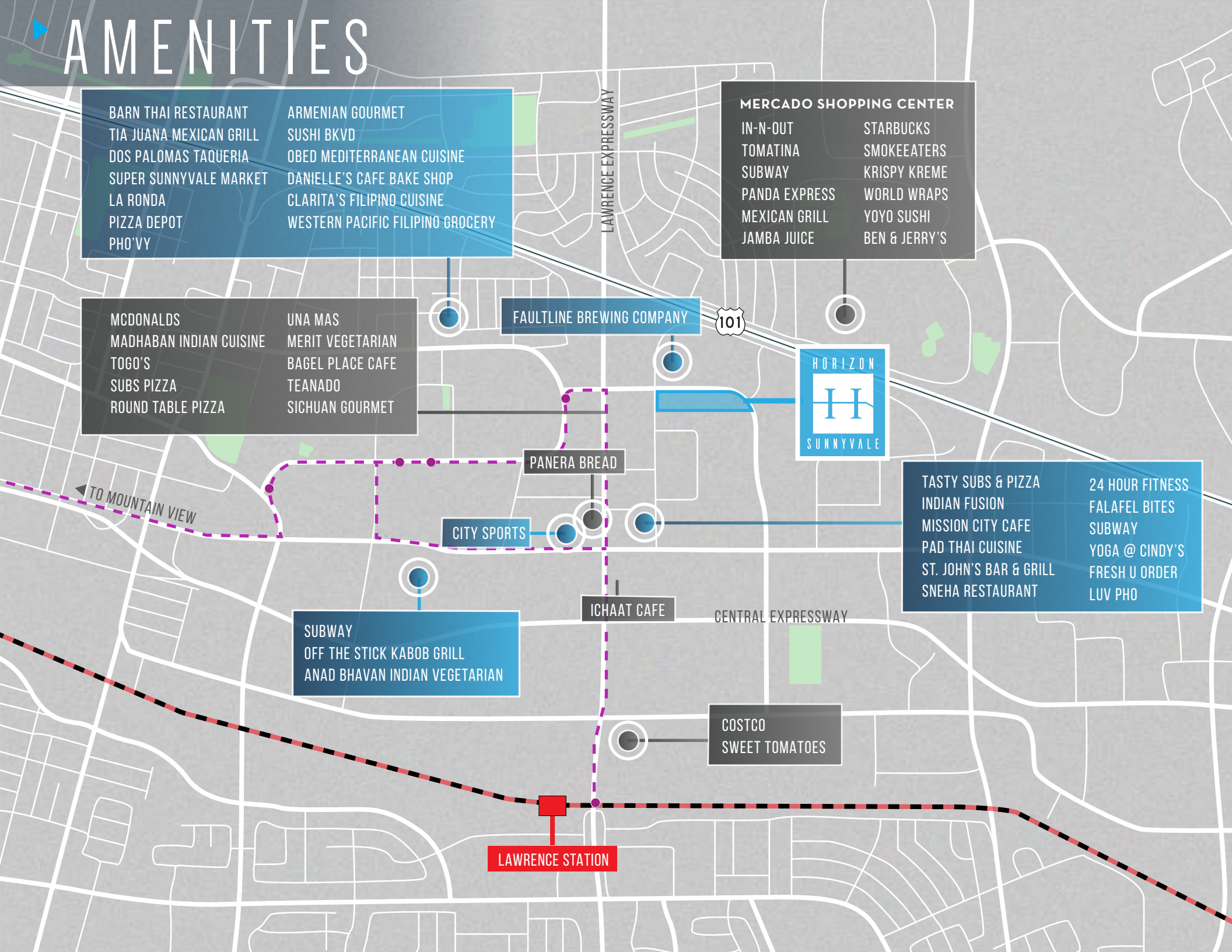



GREAT AMERICA PARKWAY

OAKMEAD PKWY

DUANE AVENUE

LAWRENCE EXPRESSWAY

LAKESIDE DRIVE

ARQUES AVE

SANTA CLARA SQUARE

BOWERS AVE

CENTRAL EXPRESSWAY

KIFER RD

LAWRENCE CALTRAIN STATION



CALTRAIN SHUTTLE TO MV STATION

0.66 Miles

8-10 Mins



WALK TO CALTRAIN:

1.1 Miles

20 Mins



UBER TO CALTRAIN:

Approx: \$8

3-5 Mins



RIDE TO SV CALTRAIN:

1.1 Miles

8-10 Mins



UBER TO SJC:

Approx: \$12

10-15 Mins



TRANSPORTATION



HORIZON — SUNNYVALE —

EMBARCADERO
CAPITAL PARTNERS



SHAWN KELLENBERGER
408.987.4170
skellenberger@ngkf.com
CA RE License #01706215

MIKE SAIGN
408.982.8403
msaign@ngkf.com
CA RE License #01706668

JEFF ARRILLAGA
408.982.8403
jarrillaga@ngkf.com
CA RE License #00935379

PATTY MCGUIGAN
650.688.8519
pmcguigan@ngkf.com
CA RE License #00800652

3055 Olin Ave, Suite 2200 | San Jose, CA 95128

The distributor of this communication is performing acts for which a real estate license is required. The information contained herein has been obtained from sources deemed reliable but has not been verified and no guarantee, warranty or representation, either express or implied, is made with respect to such information. Terms of sale or lease and availability are subject to change or withdrawal without notice. 19-0029,09/19