

1,632 SF
OFFICE SPACE FOR LEASE
Flower Mound, TX



- LOCATION:** 2613 Sagebrush Drive, Flower Mound, TX; located on SEQ of FM 2499 (Long Prairie Rd.) and Sagebrush Drive; Easy lighted access from FM 2499 – the primary N/S arterial through Flower Mound to the DFW Airport and the Mid-Cities!
- AVAILABLE:** Suite 101: 1,632 RSF – Reception; 5 offices; break area and storage.
- RENT:** \$16.00/SF/Yr. plus NNNs.
- SIGNAGE:** Monument Signage on Sagebrush and on the building facade.

For further information contact: Rich Muller



Vintage Realty

2980 Long Prairie Rd., Suite D

Flower Mound, TX 75022

972/355-0669 or Fax 972/355-5477

Email: Rich@VintageRealty.net ; Web Site: www.VintageRealty.net

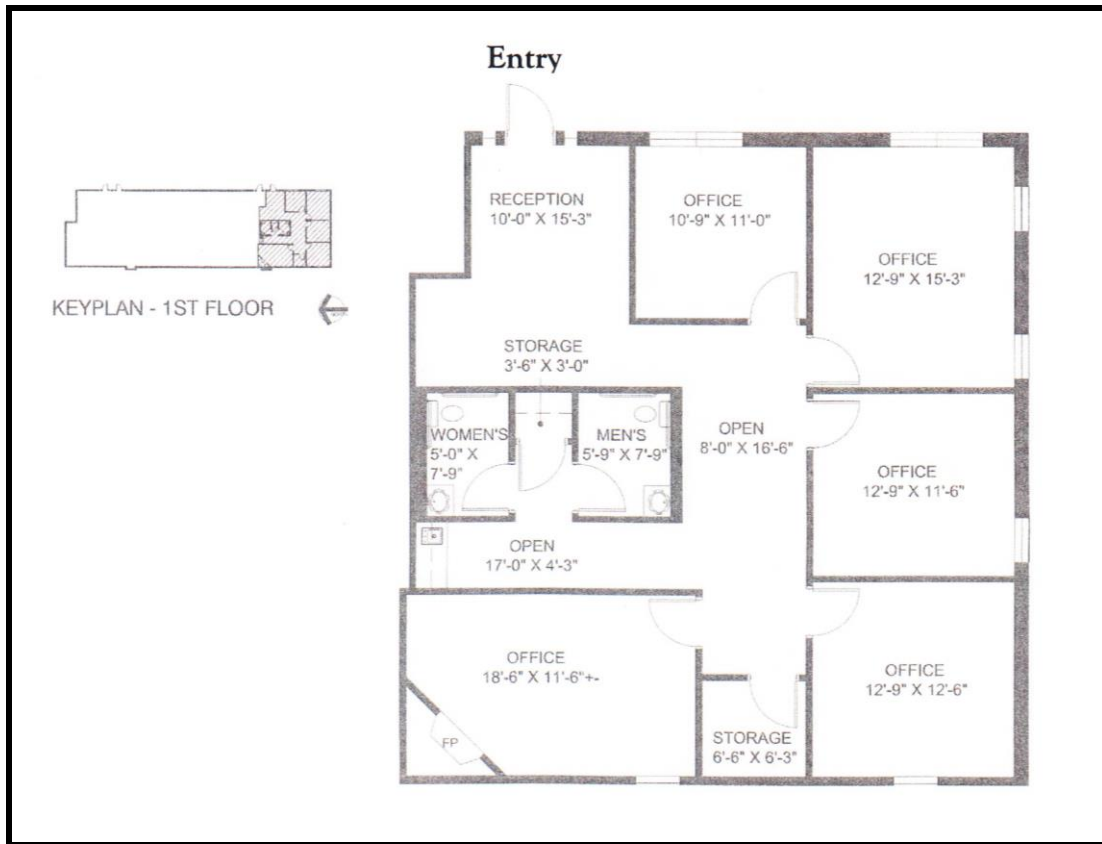

Suite 101

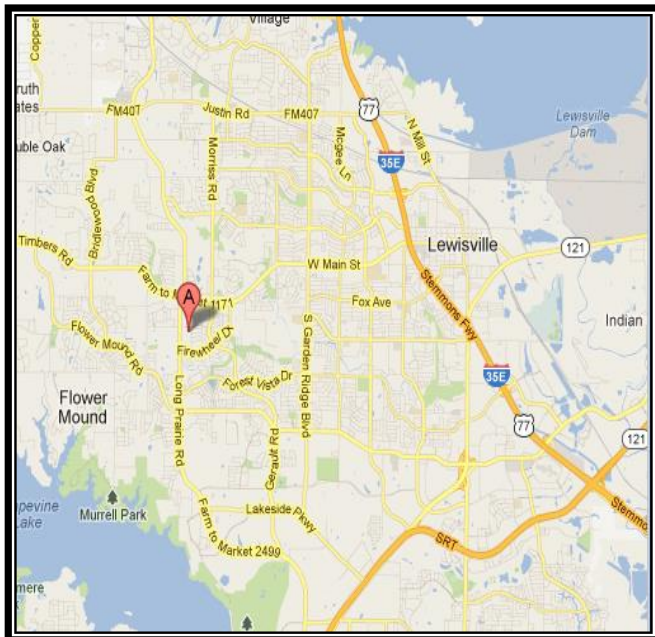

This information is believed to be accurate, but no representation or warranty, express or implied, as to its accuracy or completeness is made by any party. The presentation of this property is submitted subject to errors, omissions, change of price or prior sale or lease, or withdrawal without notice.