

# DUPONT LOGISTICS CENTER

3230 INTERNATIONAL PLACE  
DUPONT, WA 98327

LARGEST AVAILABLE  
BUILDING IN THE MARKET!



628,640 SF  
FOR LEASE

[VIEW WEBSITE](#)

**CBRE**

 PANATTONI®

**GLP** 

# PROPERTY HIGHLIGHTS

CONSTRUCTION 100% COMPLETE!

Building Size:	628,640 SF
Site Size:	±32.16 acres
Clear Height:	36'
Loading Doors:	103 DH, 4 GL
Power:	3,000 amps, 480/277
Warehouse Lighting:	LED
Slab:	7"
Truck Court:	130'+
Column Spacing:	56' x 50'
Location:	±1 mile from I-5, exit 119
Trailer Stalls:	127

## DUPONT LOGISTICS CENTER

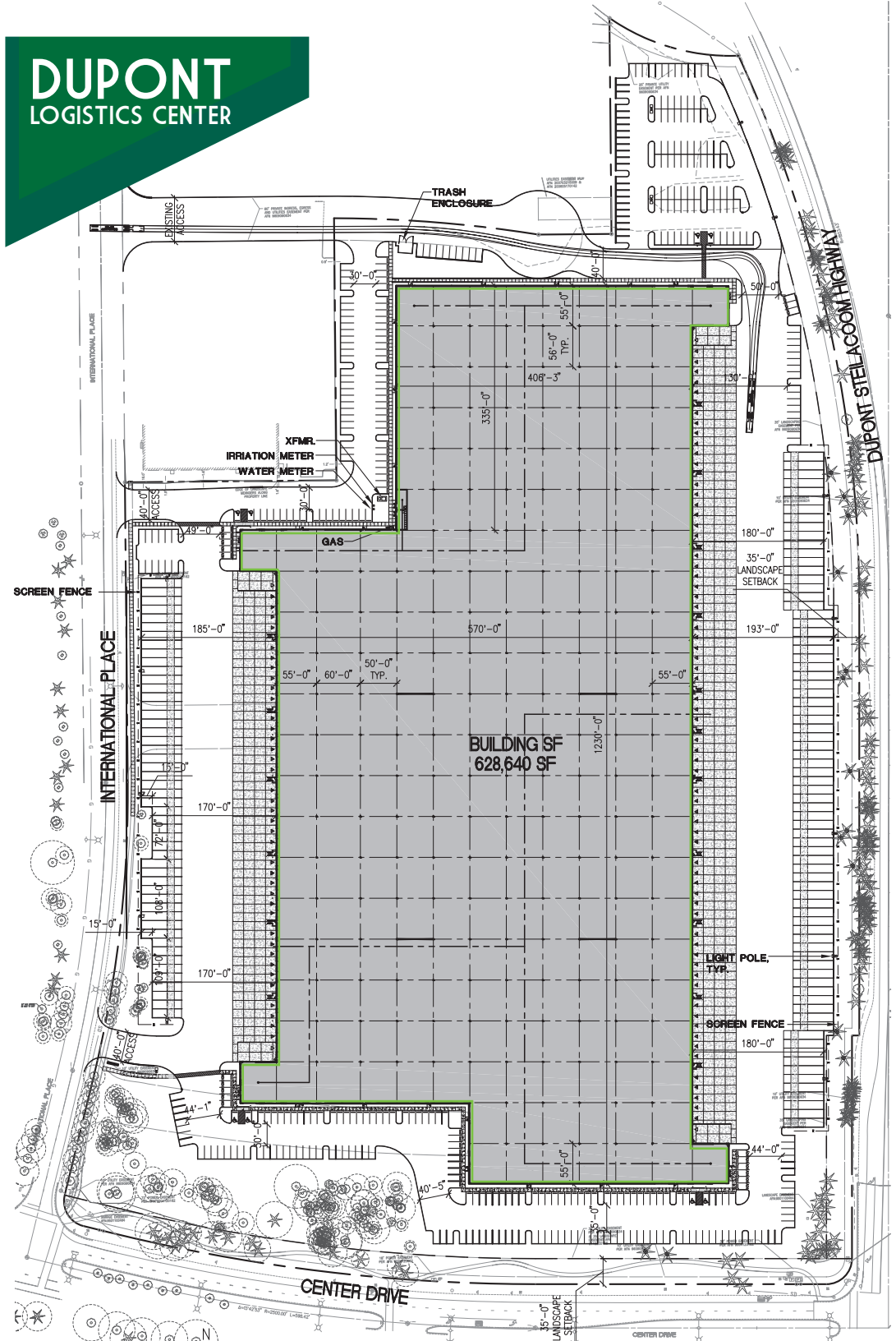



# COMPETITIVE SET



Name of Building Address City, State, Zip	DuPont Logistics Center 3230 International Pl DuPont, WA	IAC Commerce Center-SeaTac 20529 24 <sup>th</sup> Ave S SeaTac, WA	Prologis Park Kent 26 22001 84 <sup>th</sup> Ave S Kent, WA	Sumner Central 2701 142 <sup>nd</sup> Ave E Sumner, WA	Prologis Park Sumner 3711 142 <sup>nd</sup> Ave E Sumner, WA	The Viking Shaw Rd & 5 <sup>th</sup> Ave Puyallup, WA	Tacoma Logistics Center (B) 917 E 11 <sup>th</sup> St Tacoma, WA	DuPont Corporate Center (B) 2800 Center Dr DuPont, WA	Frederickson One 38 <sup>th</sup> Avenue E & 200 <sup>th</sup> St E Frederickson, WA	Bridge Point Lacey 3301 Hogum Bay Rd NE (A) Lacey, WA
Available Square Feet	628,640	341,938	654,533	427,253	370,087	438,065	384,192	494,900	478,142	510,008
Total Square Feet	628,640	457,211	654,533	427,253	370,087	438,065	828,260	494,900	478,142	510,008
Percent Leased	0%	25%	0%	0%	0%	0%	54%	0%	0%	0%
Dock Doors	103	68	122	120	95	120	75	90	46	134
Drive-in Doors	4	2	3	4	4	8	2	4	2	4
Clear Height	36'	36'	32'	30'	30'	36'	36'	36'	36'	36'
Sprinklers	ESFR	ESFR	ESFR	ESFR	ESFR	ESFR	ESFR	ESFR	ESFR	ESFR
Trailer Parks	127	40	41	Minimal	0	34	58	142	123	134
Delivery	Existing	Existing	Existing	Existing	Existing	January 2020	Existing	Q2 2020	Q2 2020	Q4 2019
Shell Asking Rent	\$0.46	\$0.72	\$0.72	\$0.66	\$0.68	\$0.57	\$0.60	\$0.50	\$0.46	\$0.50
NNN	\$0.11	TBD	TBD	\$0.17	TBD	TBD	\$0.15	TBD	TBD	TBD
Minutes to I-5	3 Minutes	7 minutes	9 minutes	16 minutes	18 minutes	21 minutes	7 minutes	3 minutes	23 minutes	6 minutes
Minutes to Port of Seattle	50 minutes	26 minutes	30 minutes	35 minutes	35 minutes	45 minutes	40 minutes	50 minutes	60 minutes	90 minutes
Minutes to Port of Tacoma	22 minutes	27 minutes	21 minutes	20 minutes	22 minutes	25 minutes	0 minutes	22 minutes	37 minutes	40 minutes
Landlord	Panattoni / GLP	IAC	Prologis	Clarion	Prologis	Michelson	IPT / Black Creek	CRG	LPC	Bridge



# DUPONT LOGISTICS CENTER

3230 INTERNATIONAL PLACE  
DUPONT, WA 98327

[VIEW WEBSITE](#)

## MONTE DECKER

Senior Vice President  
+1 253 596 0041  
monte.decker@cbre.com

## CHRIS COWLES

Senior Associate  
+1 253 596 0048  
chris.cowles@cbre.com

## ANDREW HITCHCOCK

Senior Vice President  
+1 206 442 2719  
andrew.hitchcock@cbre.com

© 2018 CBRE, Inc.

All rights reserved. This information has been obtained from sources believed reliable, but has not been verified for accuracy or completeness. Any projections, opinions, or estimates are subject to uncertainty. The information may not represent the current or future performance of the property. You and your advisors should conduct a careful, independent investigation of the property and verify all information. Any reliance on this information is solely at your own risk. CBRE and the CBRE logo are service marks of CBRE, Inc. and/or its affiliated or related companies in the United States and other countries. All other marks displayed on this document are the property of their respective owners. Photos herein are the property of their respective owners and use of these images without the express written consent of the owner is prohibited. RB 12.12.19



 PANATTONI®

 GLP 

CBRE, INC.  
1201 Pacific Avenue  
Suite 1502  
Tacoma, WA 98402

 CBRE