



# For Sublease

## 186 Logistics Center

- 84,000 SF total
- Stand-alone building
- Secured truck court
- Fully insulated facility
- 24' clear height
- 16 dock-high doors / 1 grade level door (16 DH - Levelers)
- 5,440 SF hazardous materials room (H3 rating)
- Targeting long-term lease
- Call agents for pricing

7812 S 186th Pl.  
Kent, WA

**Casey Trees**  
+1 206 607 1715  
[Casey.Trees@am.jll.com](mailto:Casey.Trees@am.jll.com)

**Chris Spofford**  
+1 206 607 1731  
[Chris.Spofford@am.jll.com](mailto:Chris.Spofford@am.jll.com)

Jones Lang LaSalle Brokerage, Inc.



# For Sublease

186 Logistics Center | 84,000 SF

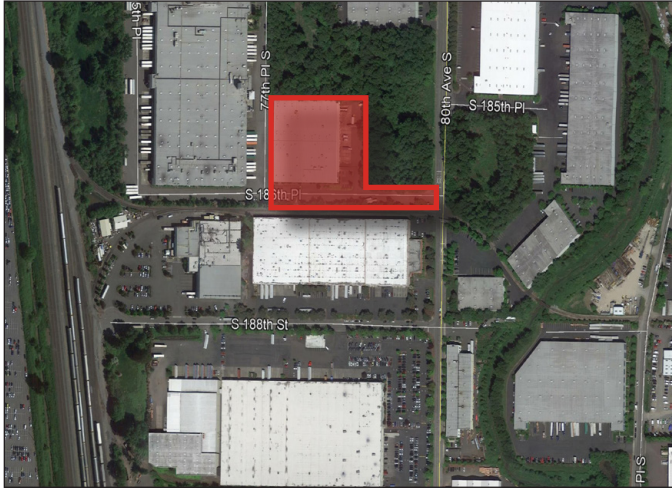

## Site Plan

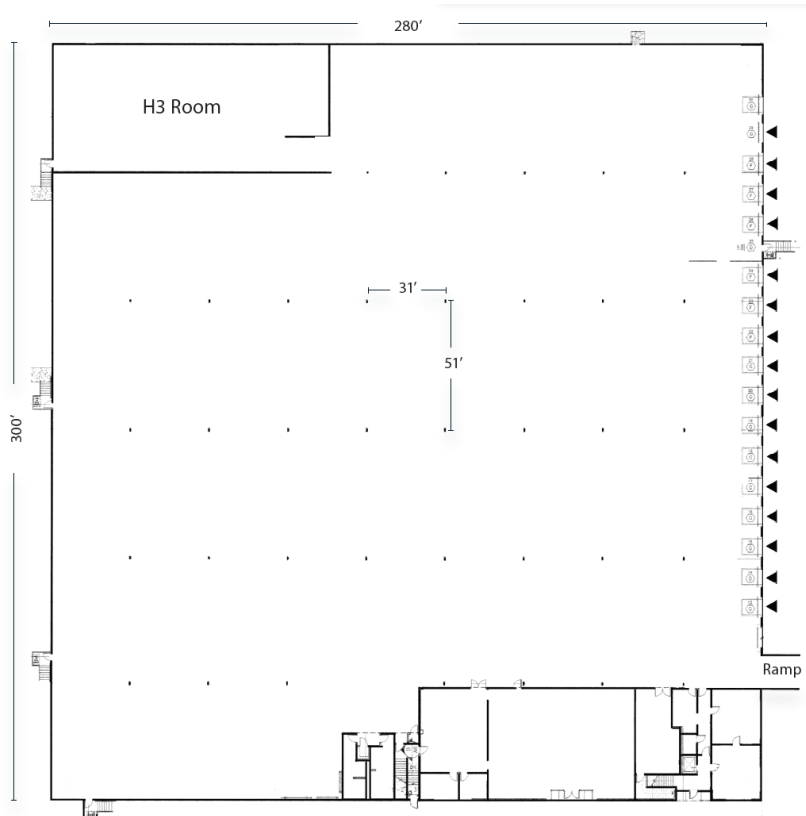

### DISCLAIMER

Although information has been obtained from sources deemed reliable, Owner, Jones Lang LaSalle, and/or their representatives, brokers or agents make no guarantees as to the accuracy of the information contained herein, and offer the Property without express or implied warranties of any kind. The Property may be withdrawn without notice. If the recipient of this information has signed a confidentiality agreement regarding this matter, this information is subject to the terms of that agreement. ©2018. Jones Lang LaSalle. All rights reserved.

