

# AVAILABLE FOR LEASE

DISTRIBUTION | WAREHOUSE | INDUSTRIAL | RETAIL | CALL CENTER  
11800 W BURLEIGH STREET | WAUWATOSA, WI | 53222



11800 W Burleigh Street | Wauwatosa, Wisconsin | 2,022,825± SF



## PHOENIX

INVESTORS

*Opportunity. Execution. Value Creation.*

Phoenix Investors, LLC  
401 E Kilbourn Avenue, Suite 201  
Milwaukee, WI 53202

Kurt Jensen  
262-308-0008  
kurt@phoenixinvestors.com

Patrick Dederling  
414-376-6933  
patrick@phoenixinvestors.com

Jason Lennartz  
414-312-6633  
jlennartz@phoenixinvestors.com

### SPACE FEATURES

- Renovation in progress
- Largest block of contiguous space in the market
- Heavy power ideal for data center or blockchain use
- Immediate proximity to I-41/45
- Rail potential



# AVAILABLE FOR LEASE

DISTRIBUTION | WAREHOUSE | INDUSTRIAL | RETAIL | CALL CENTER  
11800 W BURLEIGH STREET | WAUWATOSA, WI | 53222

## PROPERTY DETAILS

Building Size:	2,022,825 SF
Floors:	2
Available Space:	1,880,235 SF
Minimum Divisible:	50,000 SF
Maximum Contiguous:	1,507,648 SF
Warehouse Space:	1,747,648 SF
Office Space:	23,801 SF - Total 61,781 SF - Call center 47,005 SF - Retail
Construction:	Roof: Rubber membrane Walls: Masonry Floors: 6" Reinforced concrete
Year Built:	1958-1965 - Renovation in progress
Sprinklers:	100% Wet sprinklered
Parking:	350+ Surface spaces   Abundant trailer parking
Land Area:	73.67 Acres
Zoning:	M1: Heavy Manufacturing
Parcel ID:	297-9996-004
Clear Height:	12-24'
Column Width/Depth:	Varies
Elevators	Passenger and freight elevators throughout
Drive-In Doors:	5
Dock Doors:	103
Lighting:	T5
Power:	Heavy Power
Rail Access:	Spur
OpEx Estimate 2019:	\$0.49



### FOR COMPLETE INFORMATION CONTACT:

✉ KURT@PHOENIXINVESTORS.COM | ☎ (262) 308-0008  
✉ PATRICK@PHOENIXINVESTORS.COM | ☎ (414) 376-6933  
✉ JLENNARTZ@PHOENIXINVESTORS.COM | ☎ (414) 312-6633  
📍 401 EAST KILBOURN AVENUE, SUITE 201, MILWAUKEE, WI 53202



**PHOENIX**  
INVESTORS

*Opportunity. Execution. Value Creation.*

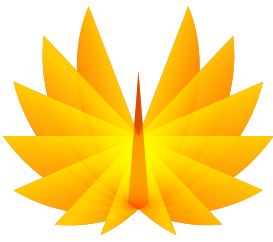

# AVAILABLE FOR LEASE

DISTRIBUTION | WAREHOUSE | INDUSTRIAL | RETAIL | CALL CENTER  
 11800 W BURLEIGH STREET | WAUWATOSA, WI | 53222

## SITE PLAN

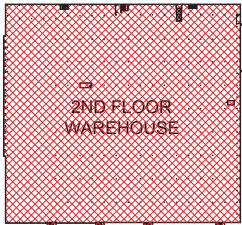

2ND FLOOR WAREHOUSE



BUILDING 4 MEZZANINE

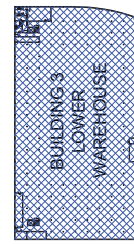

BUILDING 3 LOWER WAREHOUSE

SQUARE FOOTAGE BREAKDOWN			
HATCH	SPACE DESIGNATION	CLEAR HEIGHT	SQUARE FEET
	BUILDING 1	18'-6"	274,480 SQFT
	BUILDING 2	18'-6"	252,223 SQFT
	BUILDING 3	14'-2" - 19'-9"	325,798 SQFT
	BUILDING 3 - LOWER WAREHOUSE	13'-6"	111,505 SQFT
	RETAIL	16'-3"	49,365 SQFT
	BUILDING 4	18'-2"	152,067 SQFT
	BUILDING 5	24'-0"	306,392 SQFT
	BUILDING 5A	22'-7" - 26'-9"	16,576 SQFT
	BUILDING 6	21'-10"	198,083 SQFT
	CALL CENTER	N/A	61,781 SQFT
	2ND FLOOR WAREHOUSE	12'-0" - 16'-0"	204,560 SQFT
	BUILDING 4 - MEZZANINE	8'-9"	11,638 SQFT
	BUILDING 6 - 2ND FLOOR	10'-3"	11,180 SQFT
	FRONT OFFICE	N/A	47,398 SQFT
N/A	<b>TOTAL</b>	N/A	<b>2,023,047 SQFT</b>

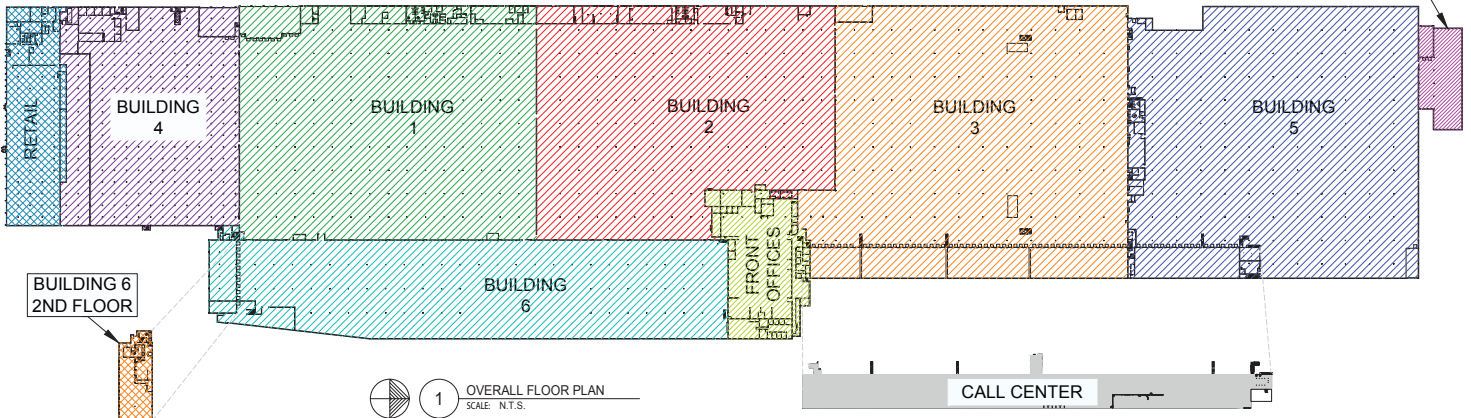

1 OVERALL FLOOR PLAN  
 SCALE: N.T.S.

### FOR COMPLETE INFORMATION CONTACT:

- ✉ KURT@PHOENIXINVESTORS.COM | ☎ (262) 308-0008
- ✉ PATRICK@PHOENIXINVESTORS.COM | ☎ (414) 376-6933
- ✉ JLENNARTZ@PHOENIXINVESTORS.COM | ☎ (414) 312-6633
- 📍 401 EAST KILBOURN AVENUE, SUITE 201, MILWAUKEE, WI 53202



**PHOENIX**  
 INVESTORS  
*Opportunity. Execution. Value Creation.*



# AVAILABLE FOR LEASE

DISTRIBUTION | WAREHOUSE | INDUSTRIAL | RETAIL | CALL CENTER  
11800 W BURLEIGH STREET | WAUWATOSA, WI | 53222

## LOCATION MAP

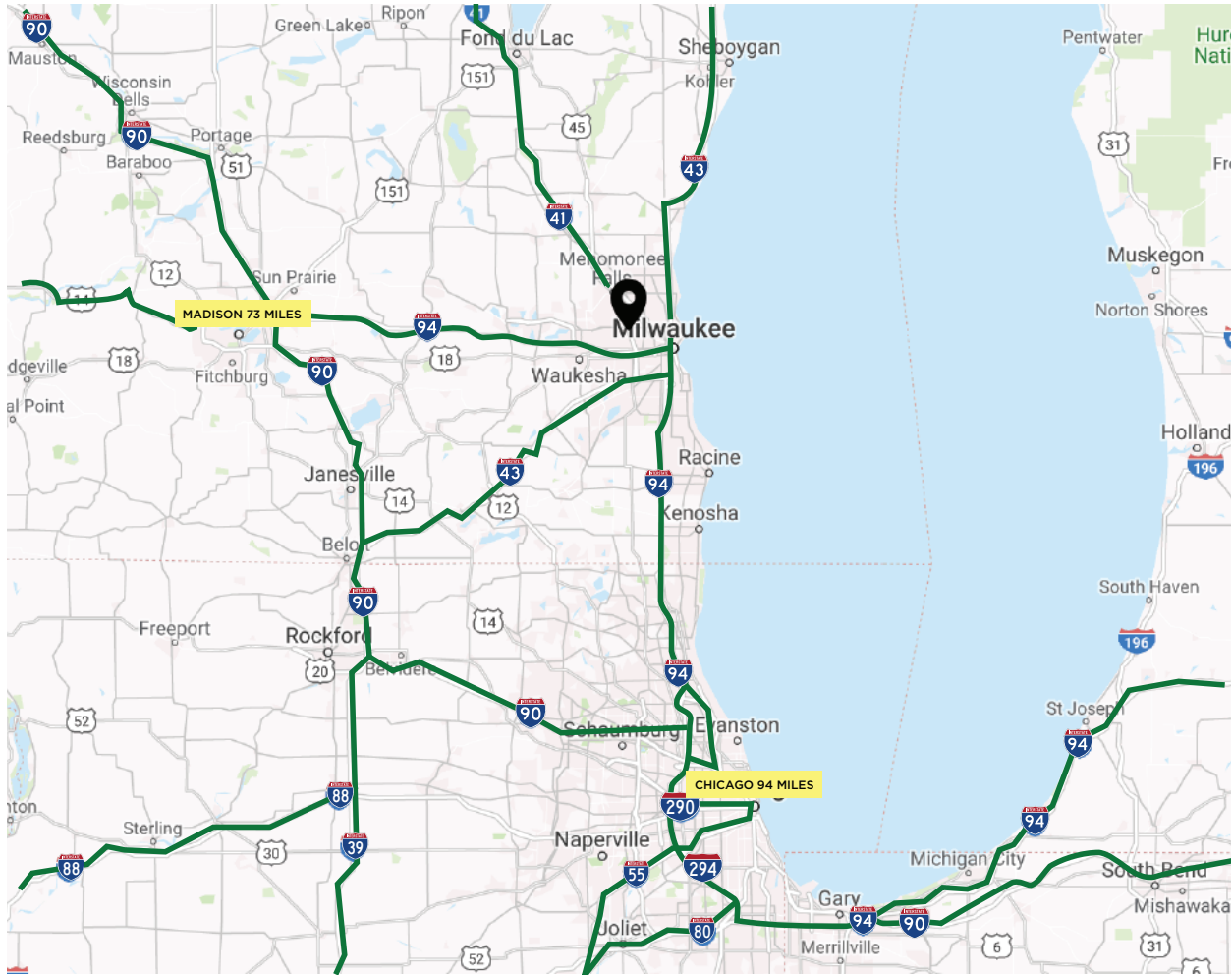

No warranty or representation, express or implied, is made to the accuracy or completeness of the information contained herein, and same is submitted subject to errors, omissions, change of price, rental or other conditions, withdrawal without notice, and to any special listing conditions imposed by the property owner(s). As applicable, we make no representation as to the condition of the property (or properties) in question.

### FOR COMPLETE INFORMATION CONTACT:

- ✉ [KURT@PHOENIXINVESTORS.COM](mailto:KURT@PHOENIXINVESTORS.COM) | ☎ (262) 308-0008
- ✉ [PATRICK@PHOENIXINVESTORS.COM](mailto:PATRICK@PHOENIXINVESTORS.COM) | ☎ (414) 376-6933
- ✉ [JLENNARTZ@PHOENIXINVESTORS.COM](mailto:JLENNARTZ@PHOENIXINVESTORS.COM) | ☎ (414) 312-6633
- 📍 401 EAST KILBOURN AVENUE, SUITE 201, MILWAUKEE, WI 53202



**PHOENIX**  
INVESTORS

*Opportunity. Execution. Value Creation.*