

For Sale

955 Route 1 & 9, Avenel (Woodbridge), New Jersey
±15,002 Sq. Ft. Lot– Developable Investment Opportunity
OR Current Use is Operational Motel Business

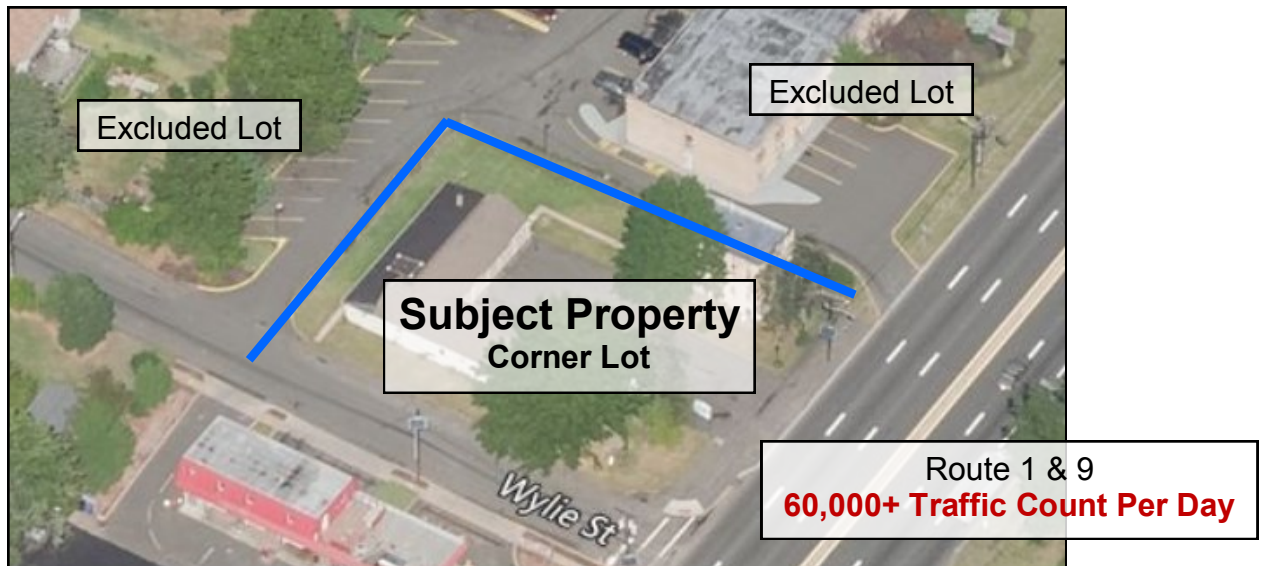

Offering Information

Address: 955 US Route 1 & 9, Avenel / Woodbridge, New Jersey
Block 825; Lot 49

Utilities: Gas, City Water and Sewer– All Direct on Route 1/9

Taxes: Approx. \$ 15,439.00 (2018)

Zoning: Route 1 Redevelopment

Current Use is 10 Unit Motel-
8 Efficiencies and 2 Apartments:
1BR & 3BR both w/Kitchens
Call for Financial Information on
Existing Business.

Redevelopment Opportunity–
As of Right Zoning Includes All
General Commercial Uses
(Office, Retail, Service). See
Redevelopment Plan Provided for
Detailed Information.



Sale Price: \$ 650,000.00

LOGISTIC REALTY
COMMERCIAL REAL ESTATE SERVICES

Bill Hettler
732.738.8888
bill@logisticrealty.com

For Sale

955 Route 1 & 9, Avenel (Woodbridge), New Jersey
±15,002 Sq. Ft. Lot– Developable Investment Opportunity OR
Current Use is Operational Motel Business



For Sale

955 Route 1 & 9, Avenel (Woodbridge), New Jersey
±15,002 Sq. Ft. Lot– Developable Investment Opportunity OR
Current Use is Operational Motel Business

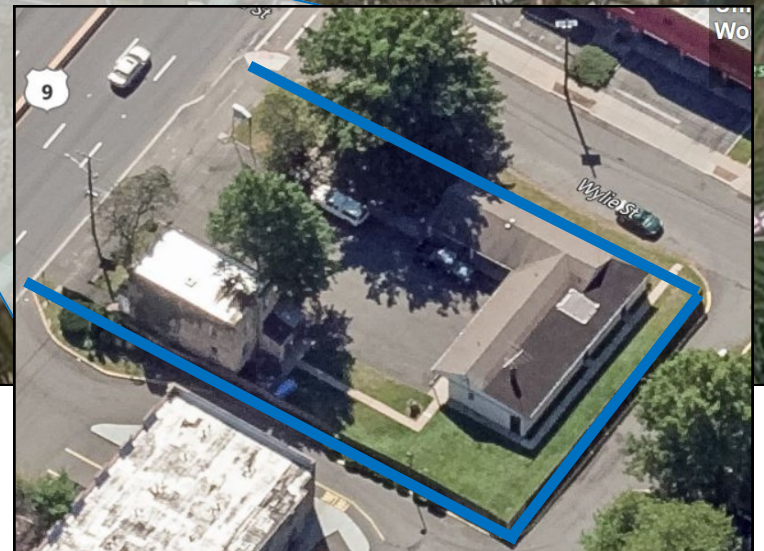

Bill Hettler

732.738.8888 bill@logisticrealty.com