

448,512 SF

Industrial Space For Lease



Prologis Park Bolingbrook

581 Territorial Drive
Bolingbrook, IL 60440 USA

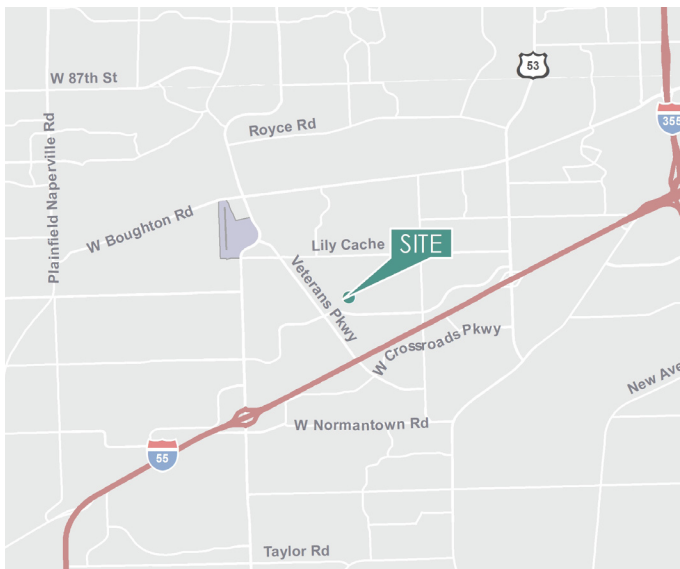

LOCATION

- Easy access to I-55 via Weber Road and Veterans Parkway
- Close proximity to I-355

FACILITY

- 448,512 sf facility available (divisible)
- 12,704 sf office 1 | 3,266 sf office 2
- 30' clear height
- 40' x 48' bay size
- 72 exterior docks
- 4 drive-in doors
- 426 auto parking
- 2,000 amps @ 277/480 volt
- Up to 103 trailer parking stalls

ADVANTAGES AND AMENITIES

- Will County taxes
- Efficient access to metropolitan Chicago, Wisconsin and Indiana
- On-site trailer parking
- Secured truck court

448,512 SF

Industrial Space For Lease

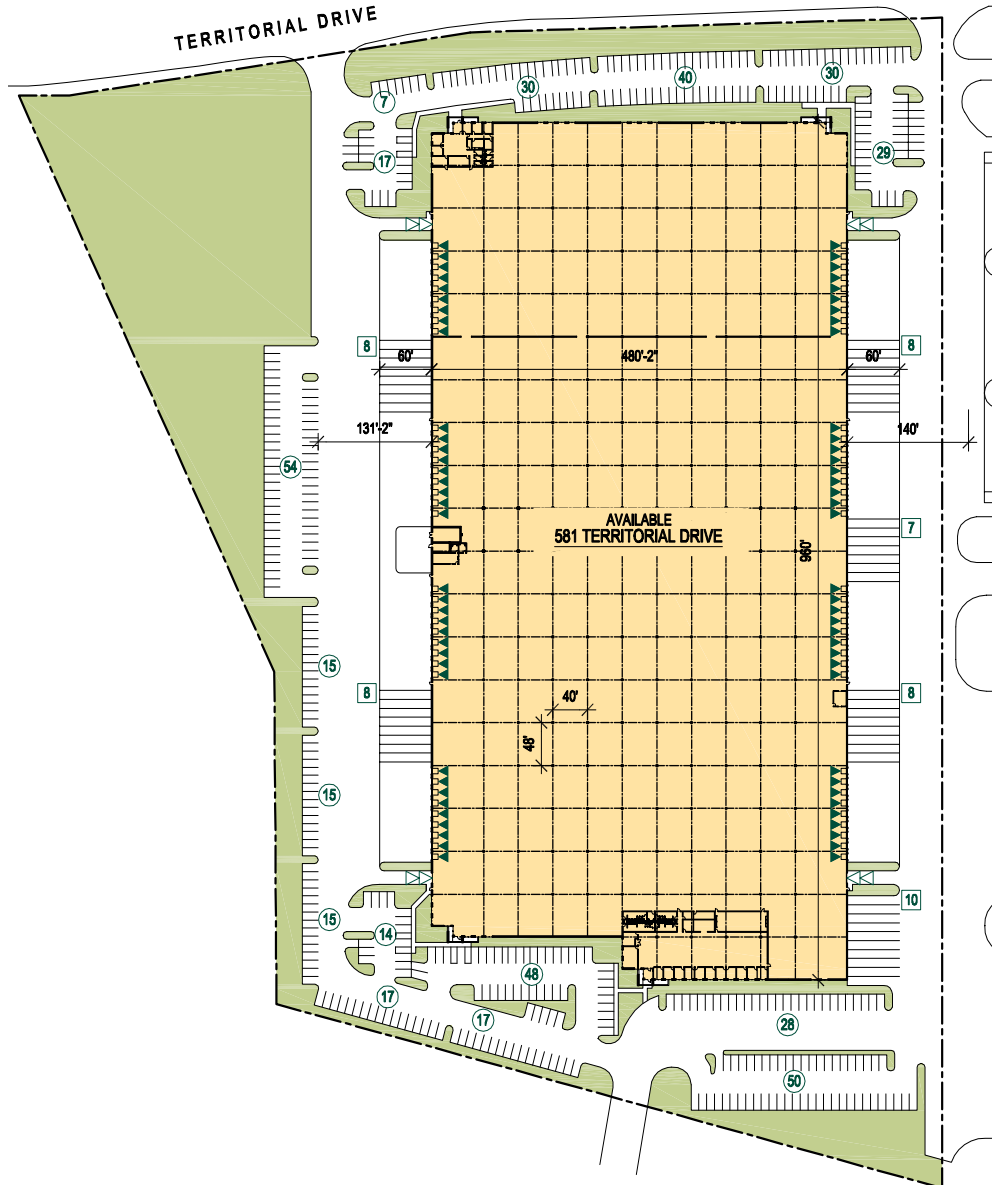

Cushman & Wakefield

Britt Casey

britt.casey@cushwake.com

ph +1 847 518 3280

cell +1 847 456 7545

9500 W. Bryn Mawr Avenue
Suite 600

Rosemont, IL 60018 USA

Cushman & Wakefield

Jason West

jason.west@cushwake.com

ph +1 847 518 3210

cell +1 630 363 4395

9500 W. Bryn Mawr Avenue
Suite 600

Rosemont, IL 60018 USA

Cushman & Wakefield

Jeff Matella

jeff.matella@cushwake.com

ph +1 847 720 1349

cell +1 847 997 2878

9500 W. Bryn Mawr Avenue
Suite 600

Rosemont, IL 60018 USA

Prologis

Jim Neswold

jneswold@prologis.com

ph +1 847 292 3924

cell +1 847 571 0592

6250 N. River Road
Suite 1100

Rosemont, IL 60018 USA

448,512 SF

Industrial Space For Lease



Additional Trailer Parking Site Plan

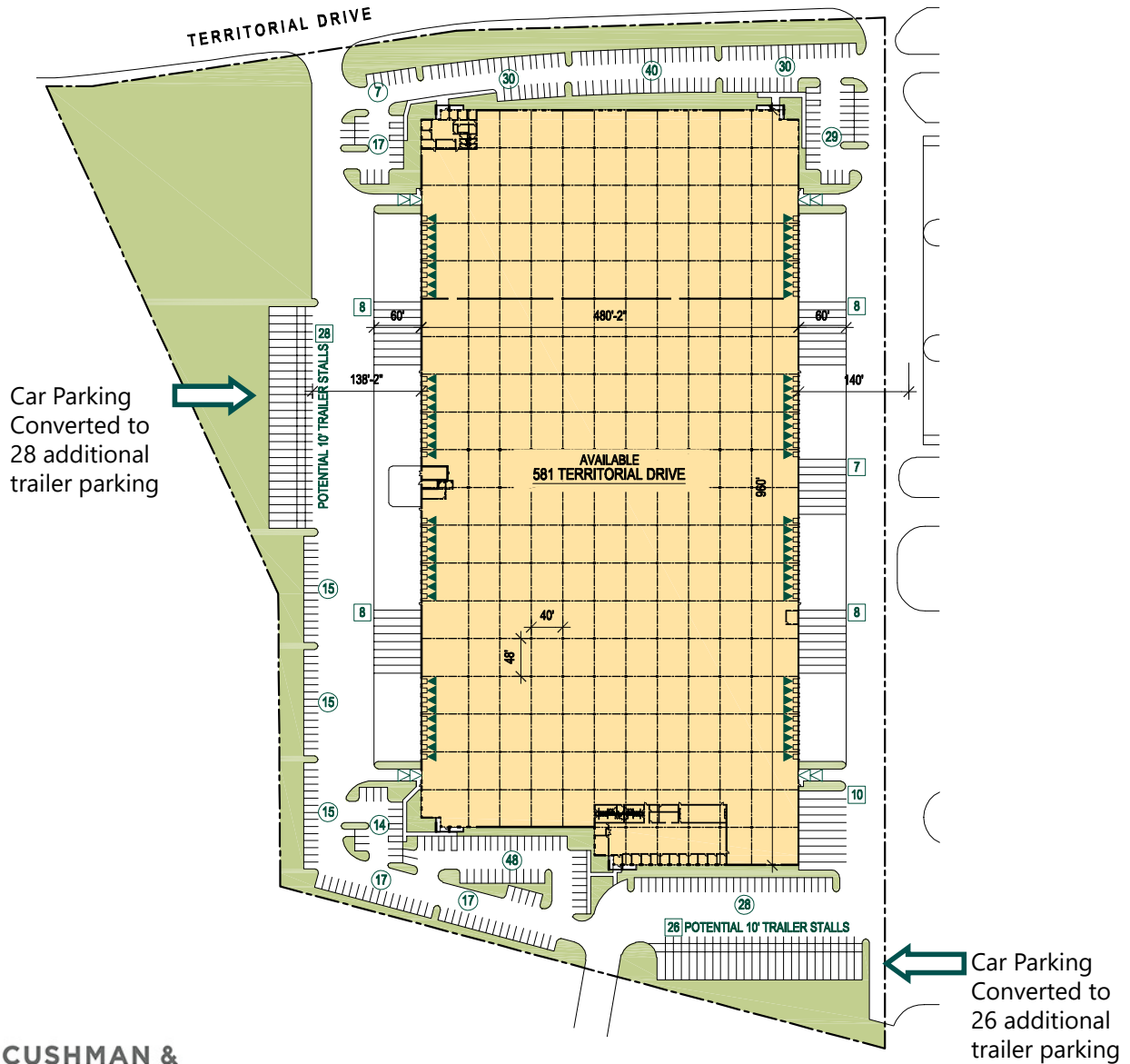

Cushman & Wakefield
Britt Casey
britt.casey@cushwake.com
ph +1 847 518 3280
cell +1 847 456 7545
9500 W. Bryn Mawr Avenue
Suite 600
Rosemont, IL 60018 USA

Cushman & Wakefield
Jason West
jason.west@cushwake.com
ph +1 847 518 3210
cell +1 630 363 4395
9500 W. Bryn Mawr Avenue
Suite 600
Rosemont, IL 60018 USA

Cushman & Wakefield
Jeff Matella
jeff.matella@cushwake.com
ph +1 847 720 1349
cell +1 847 997 2878
9500 W. Bryn Mawr Avenue
Suite 600
Rosemont, IL 60018 USA

Prologis
Jim Neswold
jneswold@prologis.com
ph +1 847 292 3924
cell +1 847 571 0592
6250 N. River Road
Suite 1100
Rosemont, IL 60018 USA