

# COMMERCE LIC

48-49 35<sup>th</sup> STREET • LONG ISLAND CITY • NEW YORK 11101

5,000 Sq. Ft. – 140,000 Sq. Ft. for Lease

## FLEX LOFT SPACE



**MANHATTAN VIEWS**



- Flexible divisions
- Two blocks to #7 subway, minutes to Midtown Tunnel, Queensboro Bridge, LIE & BQE
- On-site parking
- Interior loading docks
- Abundant natural light
- Newly renovated

***For Further Information, Please Contact***

***Exclusive Agent:***

Ian Tarasuk  
(718) 371-0133 • [itarasuk@s-z.com](mailto:itarasuk@s-z.com)

Joseph Meyerson  
(718) 732-0622 • [jmeyerson@s-z.com](mailto:jmeyerson@s-z.com)

Frank Zuckerbrot  
(718) 512-0295 • [fz@s-z.com](mailto:fz@s-z.com)

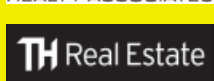

**Kaufman Astoria Studios 35-11 35<sup>th</sup> Avenue, Long Island City, NY 11101 (718) 392-5959 [www.s-z.com](http://www.s-z.com)**

Although all information is from sources deemed reliable, and no representation is made as to the accuracy thereof, it is submitted subject to errors, omissions, changes of price, prior sale, or withdrawal without notice

# COMMERCE LIC

48-49 35<sup>th</sup> STREET • LONG ISLAND CITY • NEW YORK 11101

5,000 Sq. Ft. – 140,000 Sq. Ft. for Lease

**Third Floor • Great Views • Potential for Private Lobby and Rooftop Deck • On-Site Parking • All Divisions Possible • Creative Office Design, Flex Tech, Dist, Mfg & Assembly**

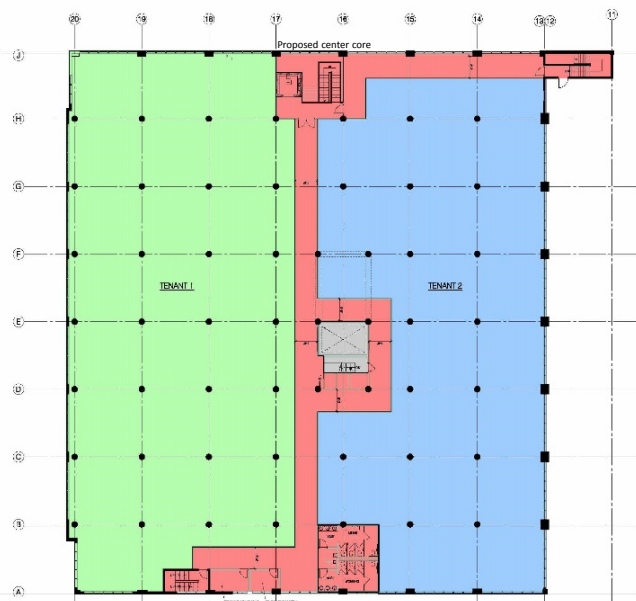

Proposed half floor tenant division



Proposed multi tenant division

**3<sup>rd</sup> Floor Availability:** —————> **5,000 sq. ft. to 40,000 sq. ft.**

**Windows:** —————> **All four sides**

**Ceiling Heights:** —————> **13 feet clear**

**Loading:** —————> **Two loading docks**

**Freight Elevator:** —————> **9' x 15.5' 10,000 lbs**

**Sprinklered:** —————> **Fully**

***For Further Information, Please Contact***

***Exclusive Agent:***



METROPOLITAN REALTY ASSOCIATES



**Sholom & Zuckerbrot Realty LLC**  
*Established 1962*

Ian Tarasuk  
(718) 371-0133 • itarasuk@s-z.com

Joseph Meyerson  
(718) 732-0622 • jmeyerson@s-z.com

Frank Zuckerbrot  
(718) 512-0295 • fz@s-z.com

**Kaufman Astoria Studios 35-11 35<sup>th</sup> Avenue, Long Island City, NY 11101 (718) 392-5959 [www.s-z.com](http://www.s-z.com)**

Although all information is from sources deemed reliable, and no representation is made as to the accuracy thereof, it is submitted subject to errors, omissions, changes of price, prior sale, or withdrawal without notice

# COMMERCE LIC

48-49 35<sup>th</sup> STREET • LONG ISLAND CITY • NEW YORK 11101

5,000 Sq. Ft. – 140,000 Sq. Ft. for Lease

**Upper Ground Floor • Expandable to 100,000 Sq.Ft. • Potential for Private Lobby and Rooftop Deck • On-Site Parking • All Divisions Possible • Creative Office Design, Flex Tech, Dist, Mfg & Assembly**

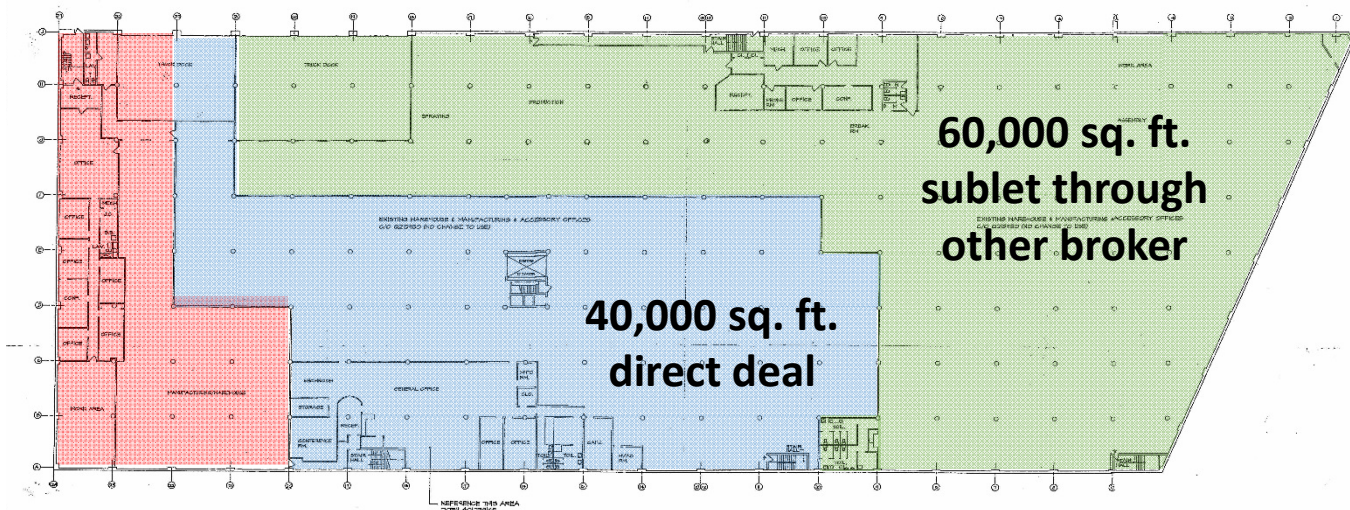

**2<sup>nd</sup> Floor Availability:** —————> 25,000 . ft. to 100,000 sq. ft.

**Direct Deal:** —————> Ability to make a direct deal with landlord

**Expandable:** —————> To 100,000 Sq.Ft. or 140,000 sq.ft.

**Ceiling Heights:** —————> 13 feet clear

**Loading:** —————> Eight loading docks

**Sprinklered:** —————> Fully

**For Further Information, Please Contact**

**Exclusive Agent:**

Ian Tarasuk  
(718) 371-0133 • itarasuk@s-z.com

Joseph Meyerson  
(718) 732-0622 • jmeyerson@s-z.com

Frank Zuckerbrot  
(718) 512-0295 • fz@s-z.com



**Kaufman Astoria Studios 35-11 35<sup>th</sup> Avenue, Long Island City, NY 11101 (718) 392-5959 www.s-z.com**

Although all information is from sources deemed reliable, and no representation is made as to the accuracy thereof, it is submitted subject to errors, omissions, changes of price, prior sale, or withdrawal without notice

