

FOR LEASE > INDUSTRIAL SPACE

Industrial Building

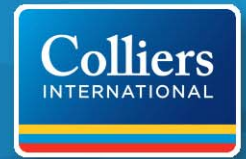

3245 PRODUCTION AVENUE, SUITE C, OCEANSIDE, CA 92058



Features

- > 4,700 SF Industrial facility
- > Office improvements: reception, 3 large private offices, kitchen area and 3 restrooms with showers
- > Approximately 16' clear height
- > Two 9' x 11' grade-level truck doors
- > Fenced yard area
- > 200 Amps/120/208 volts, 3-Phase
- > Zoned light industrial
- > Great access to I-5 Freeway
- > Surf at lunch
- > Newly refurbished office area
- > Available immediately!



\$0.60/SF
MODIFIED GROSS

JOSH MCFADYEN
760 930 7945
josh.mcfadyen@colliers.com
Lic# 01255566

COLLIERS INTERNATIONAL
5901 Priestly Drive, Suite 100
Carlsbad, CA 92008
www.colliers.com/carlsbad

3245 Production Avenue, Suite C > Floor Plan

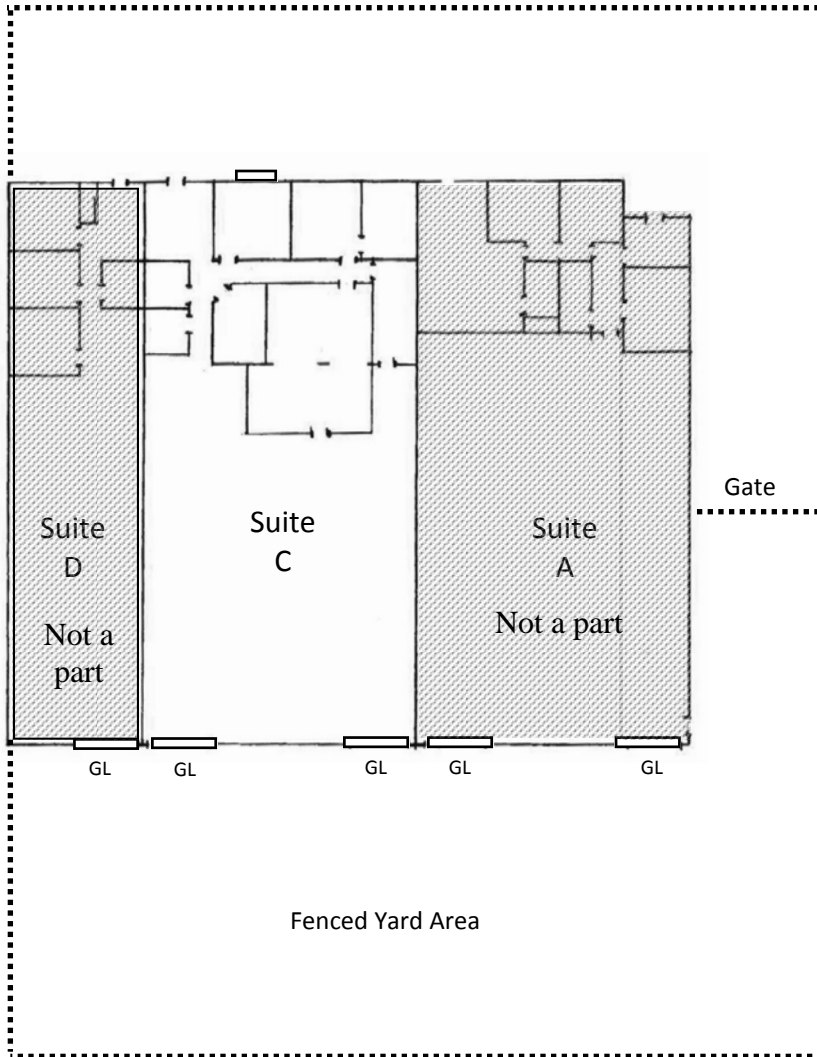

Contact Us

JOSH MCFADYEN
760 930 7945
josh.mcfadyen@colliers.com
Lic# 01255566

COLLIERS INTERNATIONAL
5901 Priestly Drive, Suite 100
Carlsbad, CA 92008
www.colliers.com/carlsbad

This document has been prepared by Colliers International for advertising and general information only. Colliers International makes no guarantees, representations or warranties of any kind, expressed or implied, regarding the information including, but not limited to, warranties of content, accuracy and reliability. Any interested party should undertake their own inquiries as to the accuracy of the information. Colliers International excludes unequivocally all inferred or implied terms, conditions and warranties arising out of this document and excludes all liability for loss and damages arising there from. Colliers International is a worldwide affiliation of independently owned and operated companies.

